

METRIC

5 0 10

CONST. REV.

R/W REV.

PROJECT REFERENCE NO.	SHEET NO.
U-2734	EC-19/CONST. 6
R/W SHEET NO.	6
ROADWAY DESIGN ENGINEER	HYDRAULICS ENGINEER

-2734 2-GG
 -2734 2-HH
 -2734
 -2734
 -2734

MAYFAIRE I, LLC
 DB 3780KK PG 514

NOTE:
 REMOVE EXISTING PAVEMENT UNDER
 PROPOSED GRASS ISLANDS THRU-OUT PROJECT

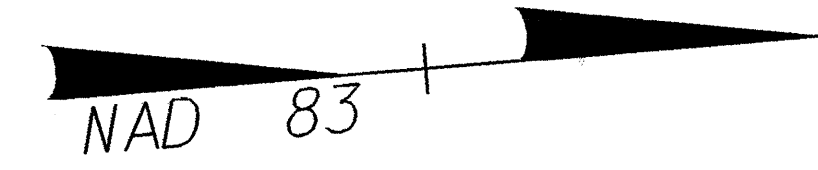

NOTE: SEE SHEETS NO. 17 & 18 FOR -L- PROFILE
 SEE SHEET NO. 22 FOR -BIKE- PROFILE
 SEE SHEET NO. 2-H FOR NATURAL STREAM
 DESIGN DETAILS & PROFILE
 SEE DETAIL SHEET NO. 2-J FOR -BIKEPATH-
 ALIGNMENT

-L-
 PI Sta 20+59.186
 $\Delta = 1^{\circ}56'02.5''$ (LT)
 $L = 117.974$
 $T = 58.992$
 $R = 3,495.000$
 $SE = NC$

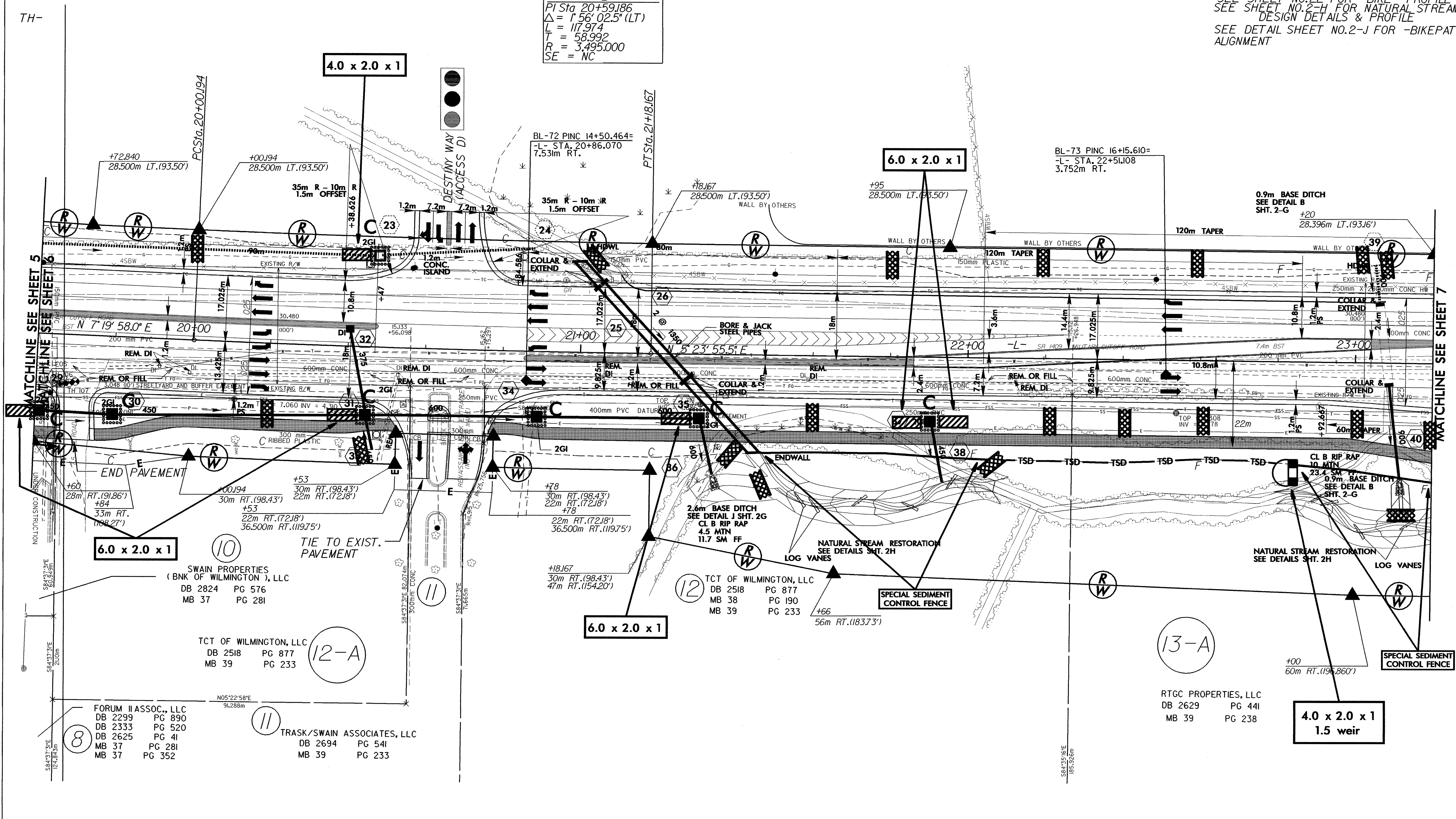

6.0 x 2.0 x 1

SWAIN PROPERTIES
 (BNK OF WILMINGTON), LLC
 DB 2824 PG 576
 MB 37 PG 281

TIE TO EXIST.
 PAVEMENT

TCT OF WILMINGTON, LLC
 DB 2518 PG 877
 MB 39 PG 233

FORUM II ASSOC., LLC
 DB 2299 PG 890
 DB 2333 PG 520
 DB 2625 PG 41
 MB 37 PG 281
 MB 37 PG 352

TRASK/SWAIN ASSOCIATES, LLC
 DB 2694 PG 541
 MB 39 PG 233

6.0 x 2.0 x 1

TCT OF WILMINGTON, LLC
 DB 2518 PG 877
 MB 38 PG 190
 MB 39 PG 233

13-A

RTGC PROPERTIES, LLC
 DB 2629 PG 441
 MB 39 PG 238

4.0 x 2.0 x 1
 1.5 weir

TH-

MATCHLINE SEE SHEET 5

MATCHLINE SEE SHEET 7