

PHASING DIAGRAM

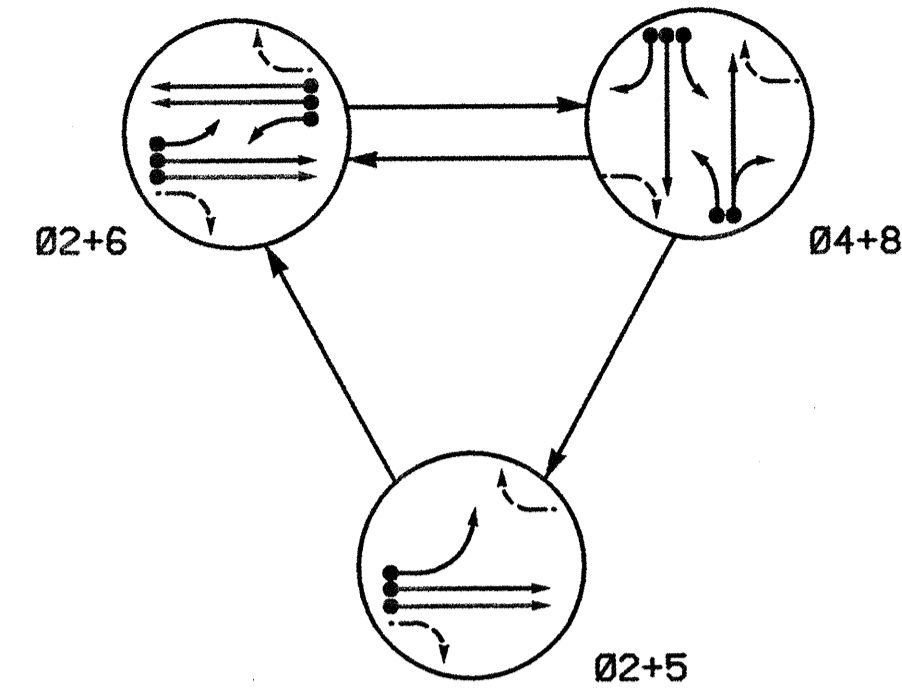

PHASING DIAGRAM DETECTION LEGEND
 ←•→ DETECTED MOVEMENT
 ←→ UNDETECTED MOVEMENT (OVERLAP)
 - - - UNSIGNALIZED MOVEMENT
 ←- - - PEDESTRIAN MOVEMENT

TABLE OF OPERATION

SIGNAL FACE	PHASE			
	Ø 2+5	Ø 2+6	Ø 4+8	F L O C K
21	G	R	Y	
22	G	R	Y	
41,42,43	R	R	G	R
61,62	R	G	R	Y
81,82,83	R	R	G	R

SIGNAL FACE I.D.

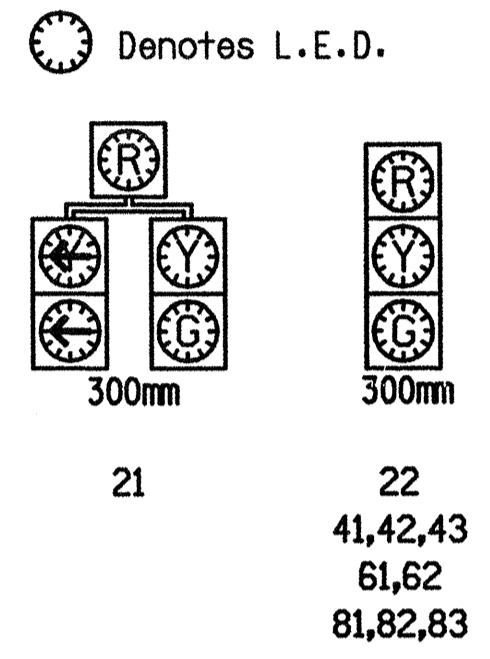

LOOP & DETECTOR UNIT INSTALLATION CHART
 NEMA CONTROLLER WITH TS-2 CABINET

LOOP NO.	SIZE (m)	TURNS	DIST. FROM STOPBAR (m)	INDUCTIVE LOOPS		DETECTOR UNITS		TIMING	PLACE CALL DURING PHASE	INHIBIT DELAY DURING GREEN?	
				NEW	EXISTING	NEW	EXISTING				
2A	1.8X1.8	6	130	X		2	X	EXTEND	2.3 SEC.	ALL	NO
2B	1.8X1.8	6	130	X		2	X				
2C	1.8X1.8	5	35	X		2	X				
2D	1.8X1.8	5	35	X		2	X				
4A	1.8X1.8	2-4-2	0	X		4	X			ALL	NO
4B	1.8X1.8	2-4-2	0	X		4	X			ALL	NO
4C	1.8X1.8	2-4-2	0	X		4	X	DELAY	15 SEC.	ALL	YES
5A	1.8X1.8	2-4-2	0	X		5	X	DELAY	15 SEC.	ALL	YES
6A,6B	1.8X1.8	5	130	X		6	X	EXTEND	2.3 SEC.	ALL	NO
6C,6D	1.8X1.8	4	35	X		6	X			ALL	NO
6E	1.8X1.8	2-4-2	0	X		6	X			ALL	NO
8A	1.8X1.8	2-4-2	0	X		8	X			ALL	NO
8B	1.8X1.8	2-4-2	0	X		8	X	DELAY	10 SEC.	ALL	YES

3 PHASE ACTUATED (ISOLATED)

NOTES

- Refer to "Roadway Standard Drawings NCDOT" dated January 2002 and "Standard Specifications for Roads and Structures" dated January 2002.
- Omit phase 5 during phase 6 on.
- Program phase 4 and phase 8 for dual entry.
- Set all detector units to presence mode.
- Do not program signal for late night flashing operation unless otherwise directed by the Engineer.

PLAN QUANTITIES

Pay Item	Meters
Signal Cable	475
Messenger Cable	170
Lead-in Cable	970

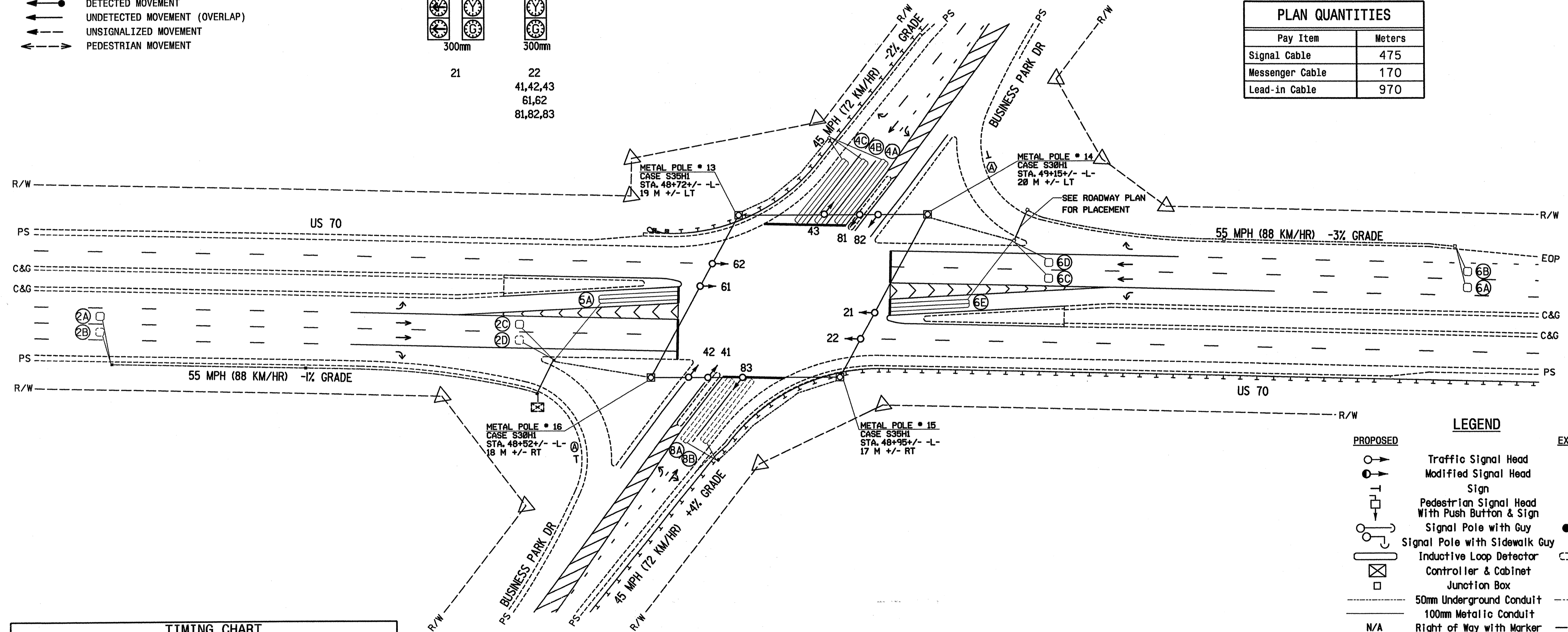

TIMING CHART
 NEMA CONTROLLER

PHASE	Ø2	Ø4	Ø5	Ø6	Ø8
MINIMUM GREEN	14 SEC.	7 SEC.	7 SEC.	14 SEC.	7 SEC.
PASSAGE/GAP	2.0 SEC.	1.0 SEC.	1.0 SEC.	2.0 SEC.	1.0 SEC.
YELLOW CHANGE INT.	5.5 SEC.	4.7 SEC.	5.0 SEC.	5.5 SEC.	4.7 SEC.
RED CLEARANCE	2.0 SEC.	2.0 SEC.	2.0 SEC.	2.0 SEC.	2.0 SEC.
MAX. I	45 SEC.	30 SEC.	15 SEC.	45 SEC.	30 SEC.
RECALL POSITION	MIN. RECALL	NONE	NONE	MIN. RECALL	NONE
VEHI. CALL MEMORY	LOCK	NONLOCK	NONLOCK	LOCK	NONLOCK

LEGEND

PROPOSED	EXISTING
○→ Traffic Signal Head	●→ Traffic Signal Head
○→ Modified Signal Head	N/A
○→ Pedestrian Signal Head With Push Button & Sign	○→ Pedestrian Signal Head
○→ Signal Pole with Guy	○→ Signal Pole with Guy
○→ Signal Pole with Sidewalk Guy	○→ Signal Pole with Sidewalk Guy
○→ Inductive Loop Detector	○→ Inductive Loop Detector
○→ Controller & Cabinet	○→ Controller & Cabinet
○→ Junction Box	○→ Junction Box
○→ 50mm Underground Conduit	○→ 50mm Underground Conduit
○→ 100mm Metallic Conduit	N/A
N/A	○→ Right of Way with Marker
○→ Directional Arrow	○→ Directional Arrow
○→ Metal Strain Pole	○→ Metal Strain Pole
○→ "YIELD" Sign (R1-2)	○→ "YIELD" Sign (R1-2)

NEW INSTALLATION-FINAL

ARCADIS
 G & M of North Carolina, Inc.
 WWW.ARCADIS-US.COM
 801 Corporate Center Drive, Suite 300
 Raleigh, NC 27607-5073
 Tel: 919/854-1282 Fax: 919/854-5448

Prepared in the Offices of:

US 70 AT BUSINESS PARK DR
 DIVISION 12 REDELL COUNTY E. OF STATESVILLE
 PLAN DATE: AUGUST 2002 REVIEWED BY: K. MILAM
 PREPARED BY: X. FAN REVIEWED BY:
 REVISIONS INIT. DATE
 SCALE 1:500
 SEAL
 NORTH CAROLINA PROFESSIONAL ENGINEER
 SEAL 21080
 ENGINEER TASON A. GRAVES
 SIGNATURE DATE
 SIG. INVENTORY NO. 12-1681

*****SYSTEMS*****
 *****SERIALS*****