

**METRIC**

5 0 10

CONST. REV.

R/W REV.

PROJECT REFERENCE NO.	R-2911A	SHEET NO.	EC-41/CONST.13
R/W SHEET NO.			
ROADWAY DESIGN ENGINEER		HYDRAULICS ENGINEER	

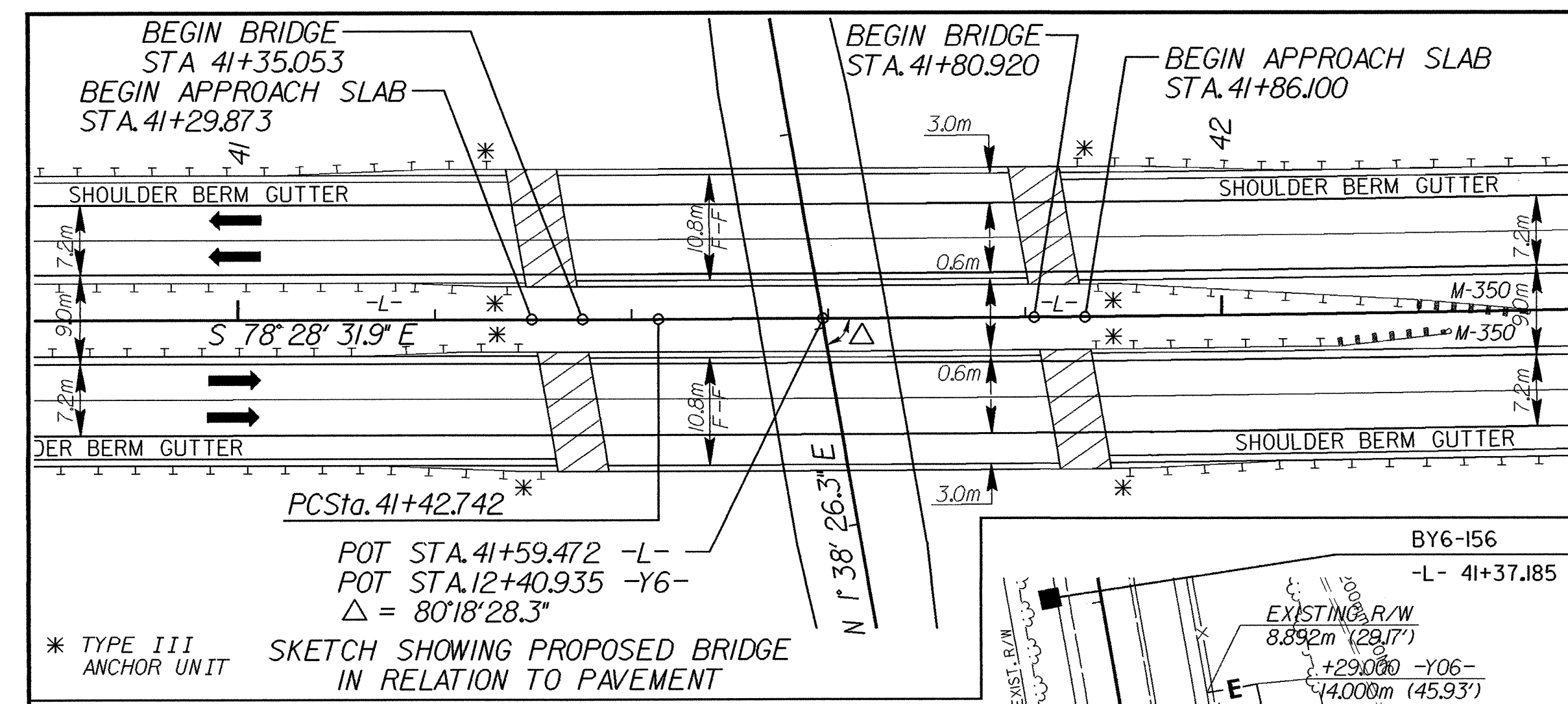

L

P.I. = 41+97.828  
 $\Delta = 115^{\circ}44' LT.$   
 $T = 55.086 M$   
 $L = 110.167 M$   
 $R = 5000.000 M$   
 SUPER = NC

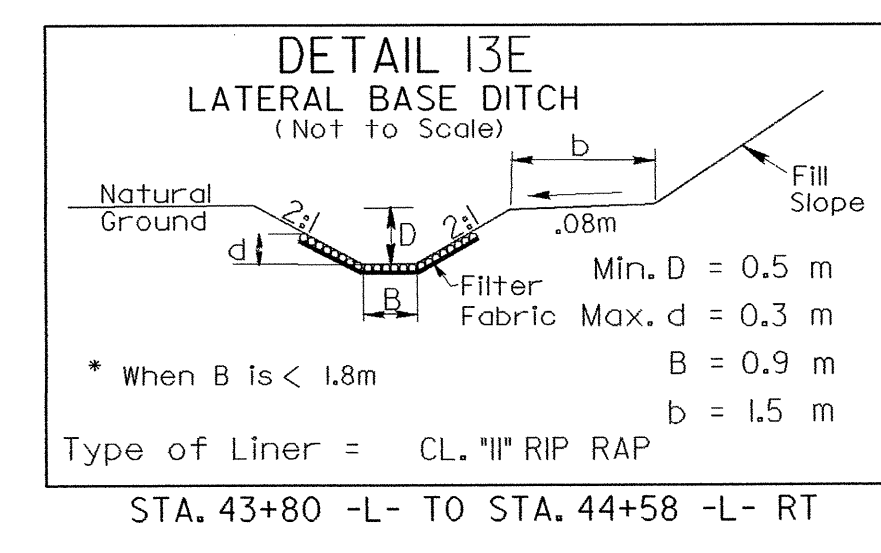
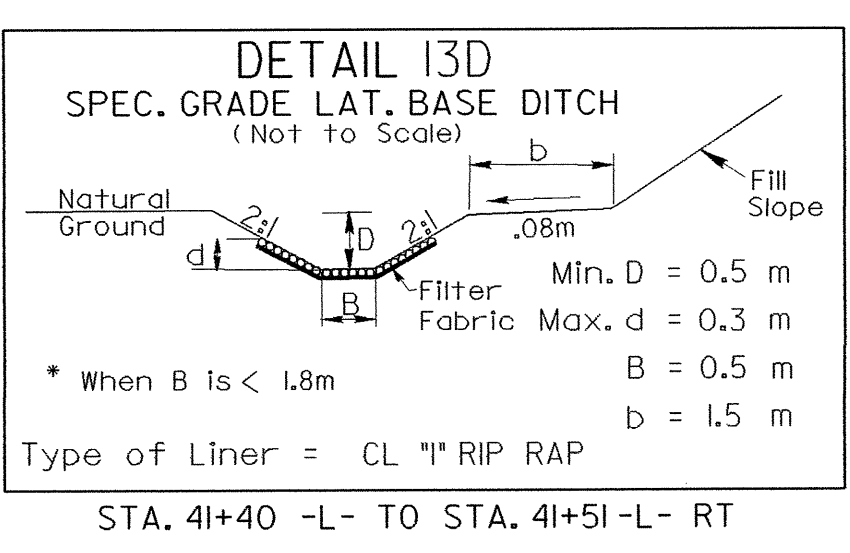
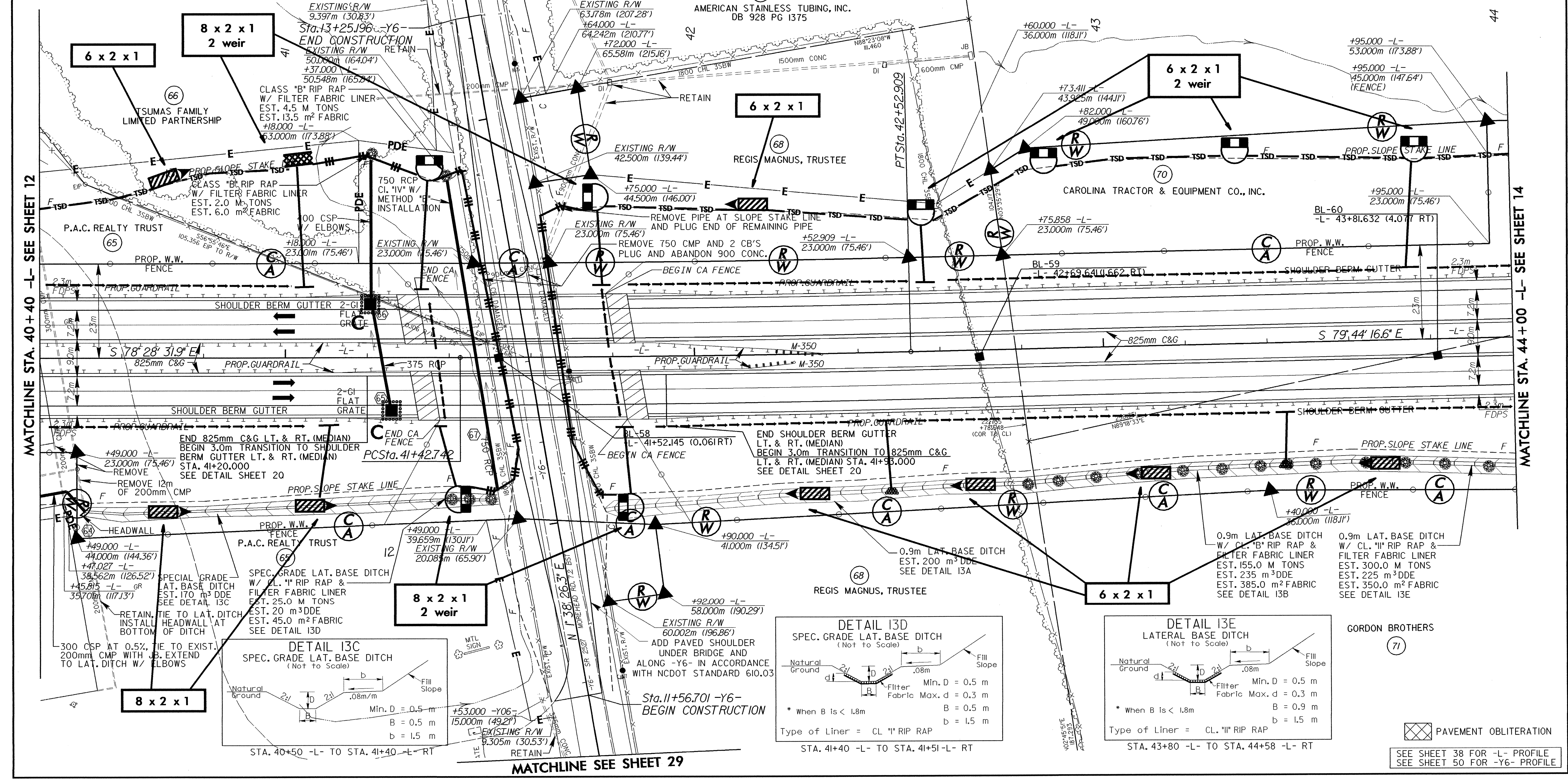
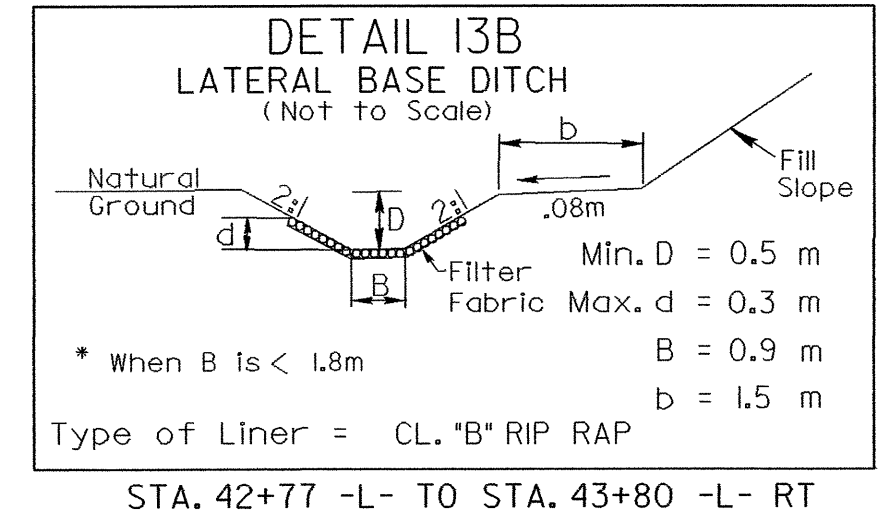
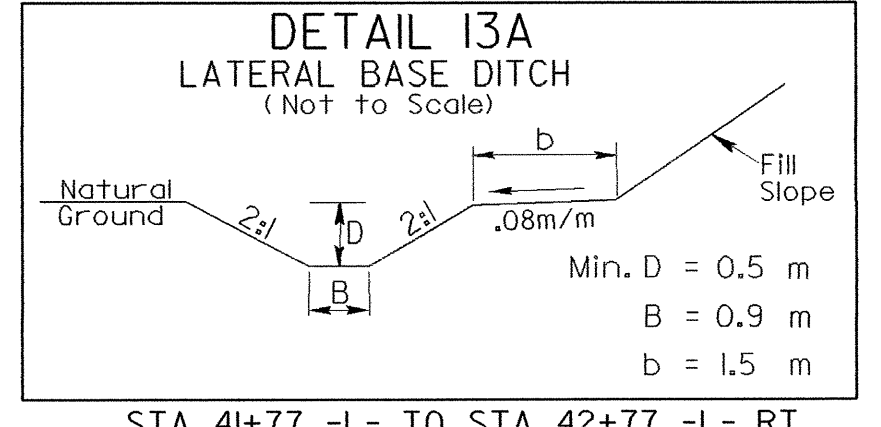

PAVEMENT OBLITERATION

SEE SHEET 38 FOR -L- PROFILE  
 SEE SHEET 50 FOR -Y6- PROFILE