

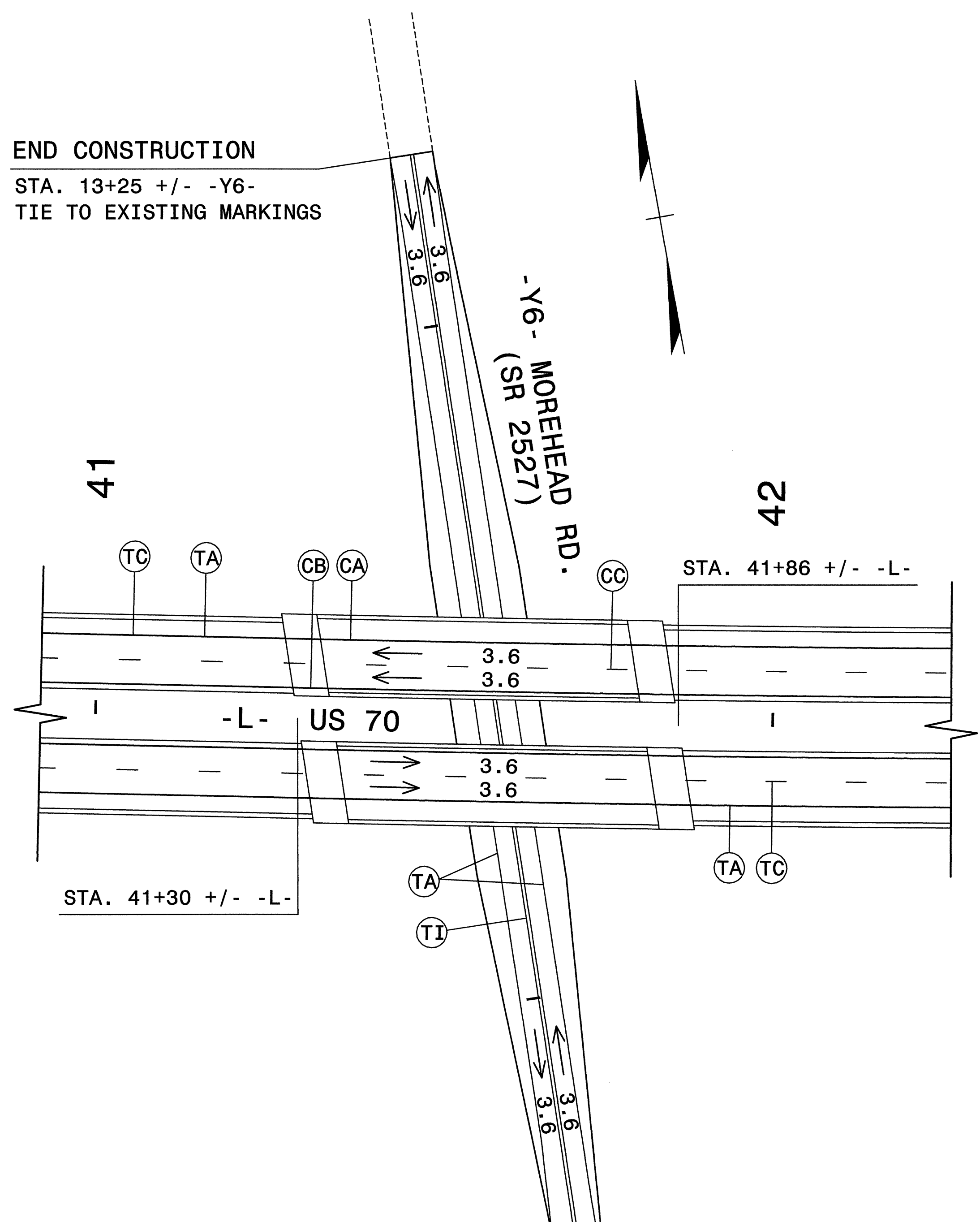

|                     |           |
|---------------------|-----------|
| PROJ. REFERENCE NO. | SHEET NO. |
| R-2911A             | PM-6      |

END CONSTRUCTION  
 STA. 13+25 +/- -Y6-  
 TIE TO EXISTING MARKINGS



BEGIN CONSTRUCTION  
 STA. 11+57 +/- -Y6-  
 TIE TO EXISTING MARKINGS

NOTES:

- SEE SHEET PM-1 FOR FINAL PAVEMENT MARKING SCHEDULE.
- PAVEMENT MARKINGS, SYMBOLS, AND CHARACTERS TO BE MARKED ACCORDING TO ROADWAY STANDARD DRAWINGS UNLESS OTHERWISE NOTED IN THE PLANS.
- PAVEMENT MARKERS ARE TO BE SPACED ACCORDING TO THE ROADWAY STANDARD DRAWINGS.

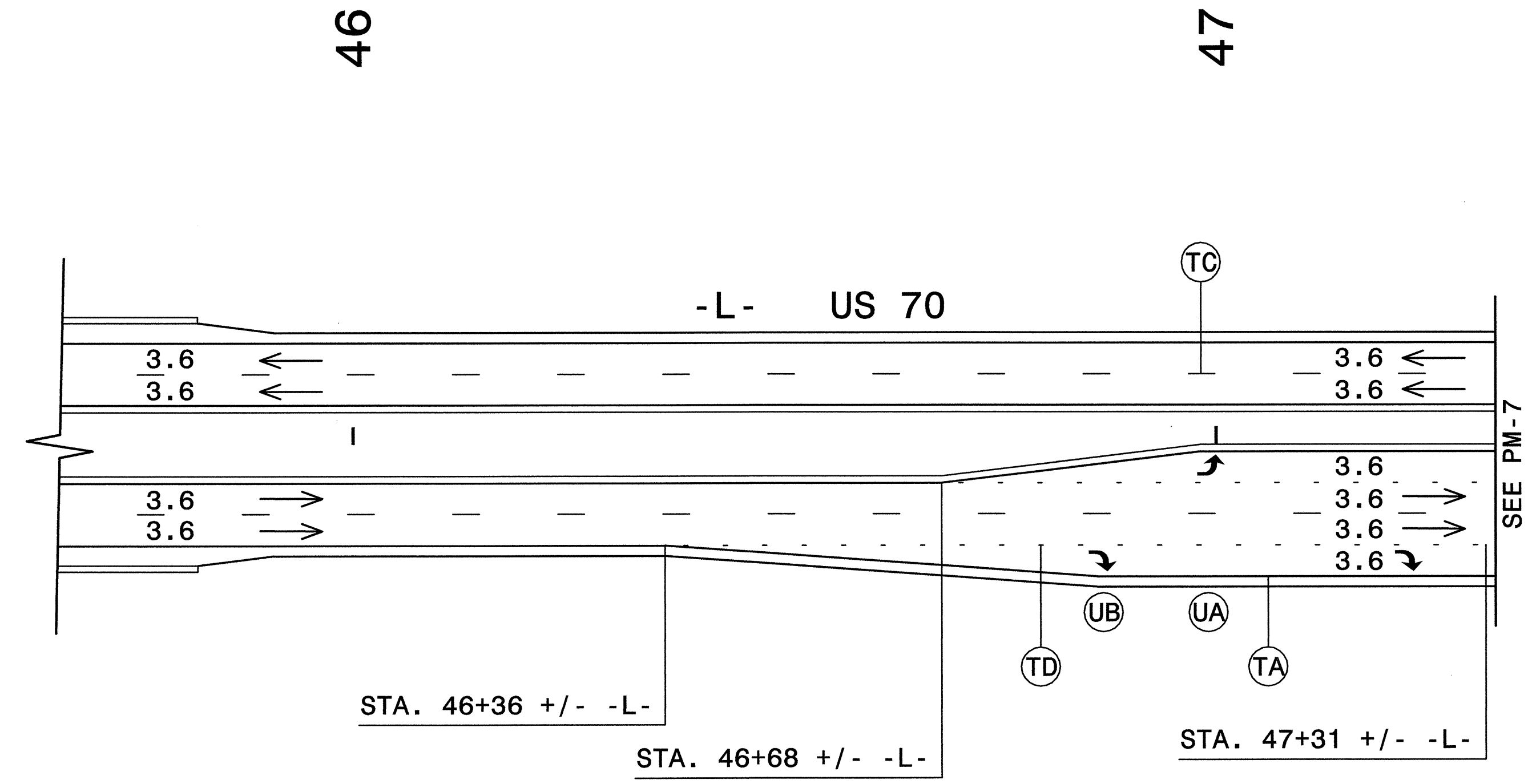

P:\TRAFFIC\Sub 1005\2911A\F1002\PM6.PMP  
 08/18/2003 09:44:02 AM

Plans prepared by:  
**KO & ASSOCIATES, P.C.**  
 Consulting Engineers  
 101 SCHAUB DR., SUITE #202  
 RALEIGH, N.C. 27606  
 For Division of Highways

|   |                              |  |
|---|------------------------------|--|
| APPROVED: <i>Mark Acuff</i> DATE: 8/18/03 | <b>PAVEMENT MARKING PLAN</b> |  |
|   | SCALE: NONE                  |  |
|   | DATE: 8-20-03                |  |
|   | DWG. BY: B.L.M.              |  |
|   | DESIGN BY: B.L.M.            |  |
| REVIEWED BY: M.S.A.                       | REVISIONS                    |  |
|   |                              |  |
|   |                              |  |
|   |                              |  |