

09/08/99

CONTRACT: C200842 TIP PROJECT B-3475

See Sheet 1-A For Index of Sheets

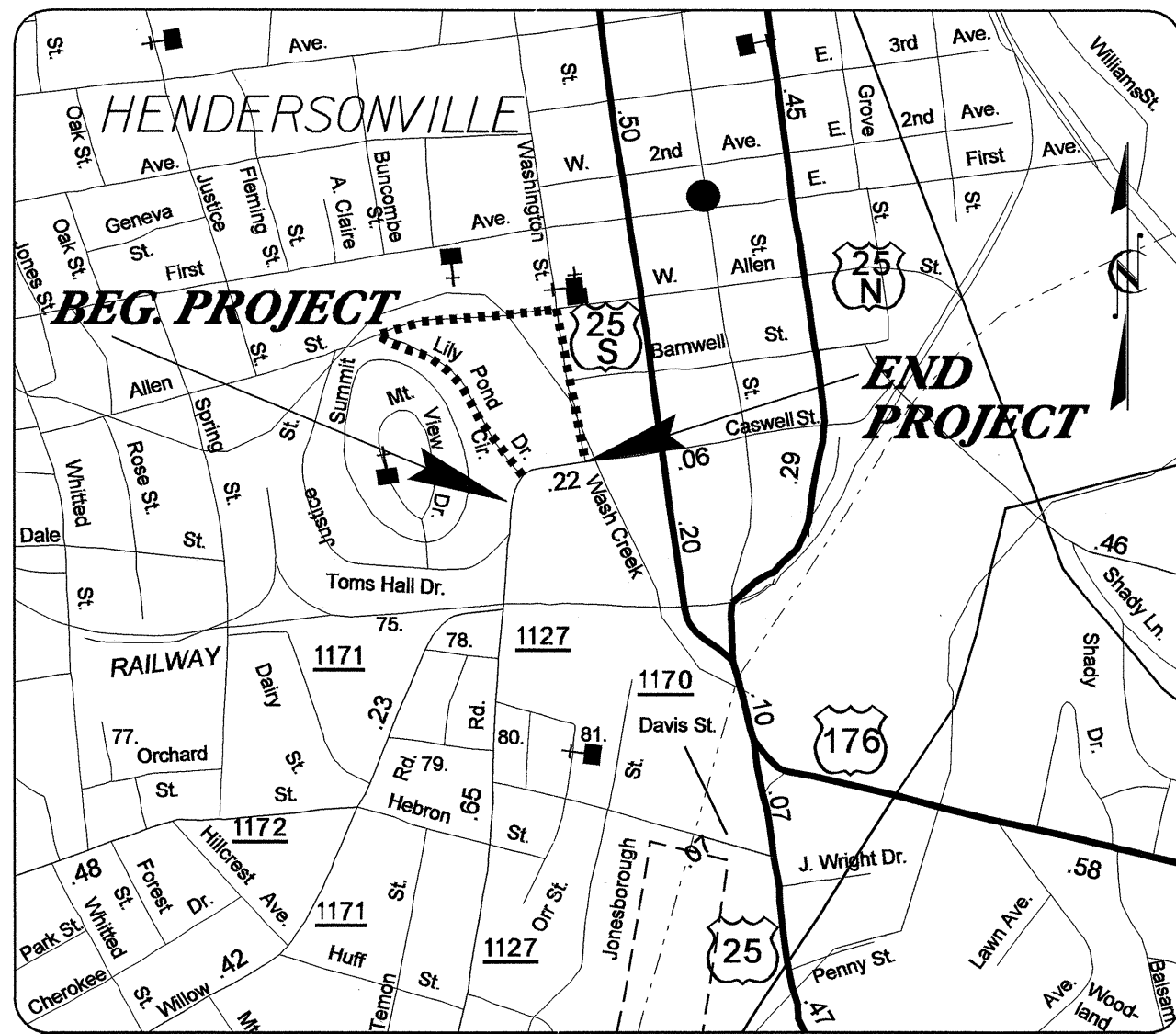

VICINITY MAP
..... OFFSITE DETOUR ROUTE

STATE OF NORTH CAROLINA
DIVISION OF HIGHWAYS

HENDERSON COUNTY

**LOCATION: BRIDGE NO. 356 OVER WASH CREEK ON
SR 1127 (KANUGA RD.) IN HENDERSONVILLE**
**TYPE OF WORK: GRADING, DRAINAGE, PAVING, CULVERT,
& SIGNALS**

STATE	STATE PROJECT REFERENCE NO.	SHEET NO.	TOTAL SHEETS
N.C.	B-3475	1	
STATE PROJ. NO.	F.A. PROJ. NO.	DESCRIPTION	
33093.1.1	BRSTP-1127(5)	P.E.	
33093.2.2	BRSTP-1127(5)	R/W & UTILITY	
33093.3.1	BRSTP-1127(8)	CONSTRUCTION	

STA 11+50.00 -L- BEGIN TIP PROJECT B-3475

-L- STA 10+10.00 BEGIN CONSTRUCTION

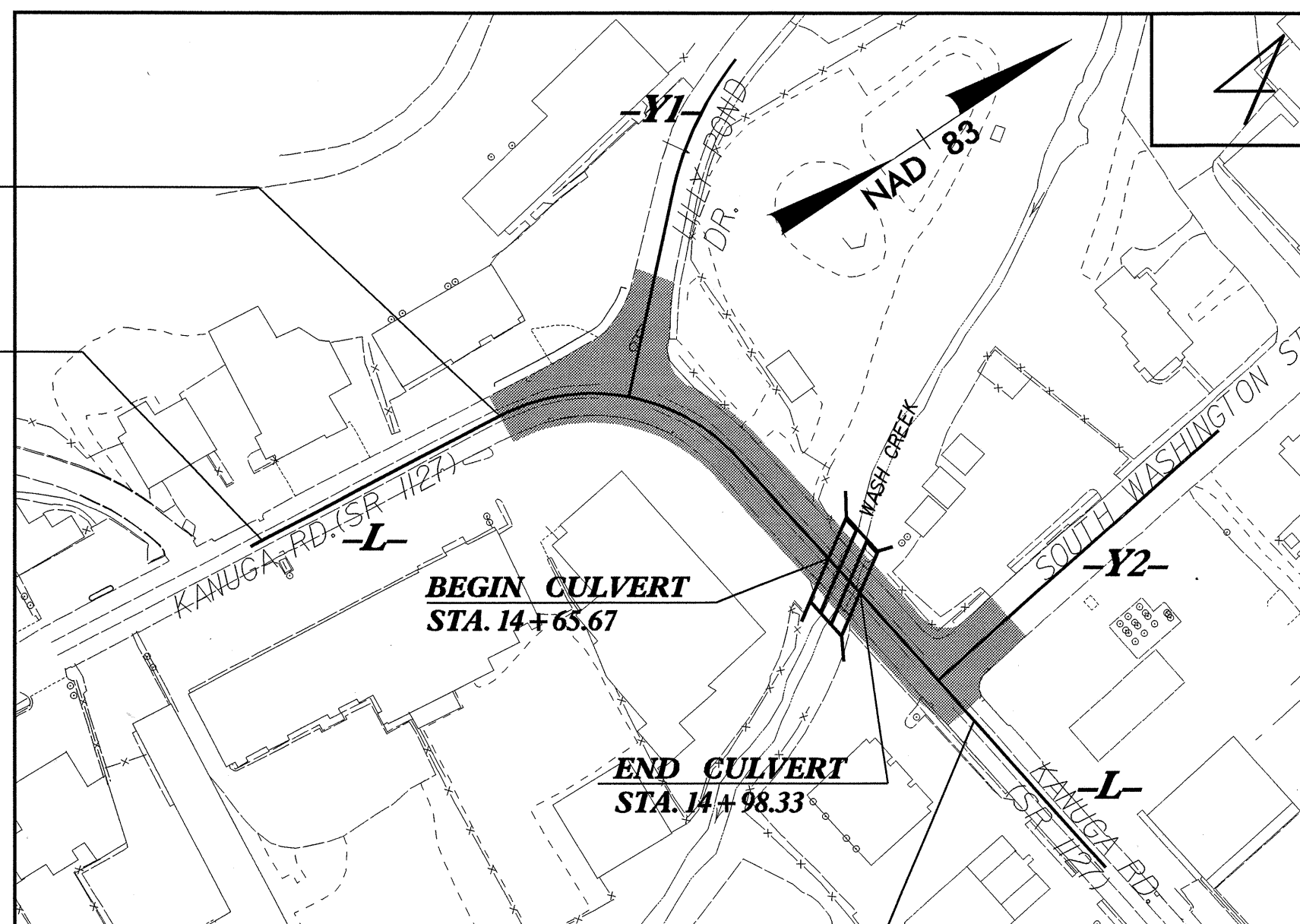

VALLEY HILL (UNINC.)

STA 16+20.00 - L- END TIP PROJECT B-3475

HENDERSONVILLE

**DESIGN EXCEPTION REQUIRED FOR
DESIGN SPEED, FROM 35 mph TO 20 mph

GRAPHIC SCALES

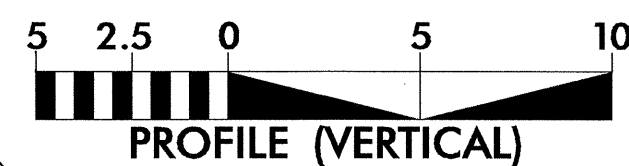
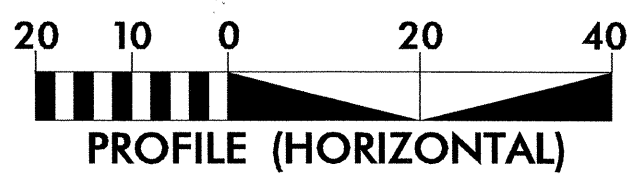

DESIGN DATA

ADT 2004 = 11655
 ADT 2024 = 16270
 DHV = 12 %
 D = 60 %
 T = 7 % *
 V = 20 MPH**

* TTST 2 % + DUAL 5 %

PROJECT LENGTH

LENGTH ROADWAY TIP PROJECT B-3475 = 0.083 MILES
 LENGTH STRUCTURE TIP PROJECT B-3475 = 0.006 MILES
 TOTAL LENGTH OF TIP PROJECT B-3475 = 0.089 MILES

Prepared in the Office of:
DIVISION OF HIGHWAYS

1000 Birch Ridge Dr., NC, 27610

2002 STANDARD SPECIFICATIONS

RIGHT OF WAY DATE:
MAY 28, 2003

LETTING DATE:
AUGUST 17, 2004

GARY LOVERING, PE
PROJECT ENGINEER

ANTHONY C. WEST
PROJECT DESIGN ENGINEER

HYDRAULICS ENGINEER



GARY R. LOVERING
ENGINEER
25873

**DIVISION OF HIGHWAYS
STATE OF NORTH CAROLINA**

ant millan
P.E.

STATE DESIGN ENGINEER
**DEPARTMENT OF TRANSPORTATION
FEDERAL HIGHWAY ADMINISTRATION**

APPROVED
DIVISION ADMINISTRATOR

DATE

18-MAR-2004 15:29
R:\proj\18-3475\esh
S:\shley AT 10212454