

PHASING DIAGRAM

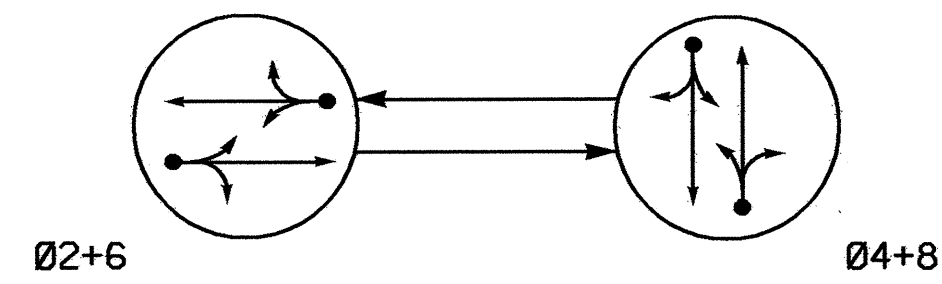

**PHASING DIAGRAM DETECTION LEGEND**  
 ● ← DETECTED MOVEMENT  
 ○ ← UNDETECTED MOVEMENT (OVERLAP)  
 - - - UNSIGNALIZED MOVEMENT  
 ← - - - PEDESTRIAN MOVEMENT

**TABLE OF OPERATION**

SIGNAL FACE	PHASE		
	Ø 2+6	Ø 4+8	FLASH
21, 22	G	R	Y
41, 42	R	G	R
61, 62	G	R	Y
81, 82	R	G	R

**SIGNAL FACE I.D.**

○ Denotes L.E.D.

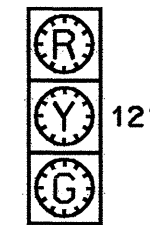

21, 22  
41, 42  
61, 62  
81, 82

**2070L LOOP & DETECTOR INSTALLATION**

LOOP	INDUCTIVE LOOPS				DETECTOR PROGRAMMING							
	SIZE (FT)	TURNS	DISTANCE FROM STOPBAR (FT)	NEW LOOP	PHASE	CALLING	EXTENSION	FULL TIME DELAY	SYSTEM LOOP	STRETCH TIME	DELAY TIME	NEW CARD
2A	6X6	4	70	-	2	Y	Y	-	-	-	-	-
4A	6X60	2-4-2	0	-	4	Y	Y	-	-	-	5	-
6A	6X6	4	70	-	6	Y	Y	-	-	-	-	-
8A	6X60	2-4-2	0	-	8	Y	Y	-	-	-	5	-

2 Phase Fully Actuated (Isolated)

**NOTES**

- Refer to "Roadway Standard Drawings NCDOT" dated January 2002 and "Standard Specifications for Roads and Structures" dated January 2002.
- Do not program signal for late night flashing operation unless otherwise directed by the Engineer.
- Pavement markings are existing.
- Set all detector units to presence mode.
- Disconnect Loop 5A.

**PLAN QUANTITIES**

Pay Item	Feet
Signal Cable	-
Messenger Cable	-
Lead-in Cable	-

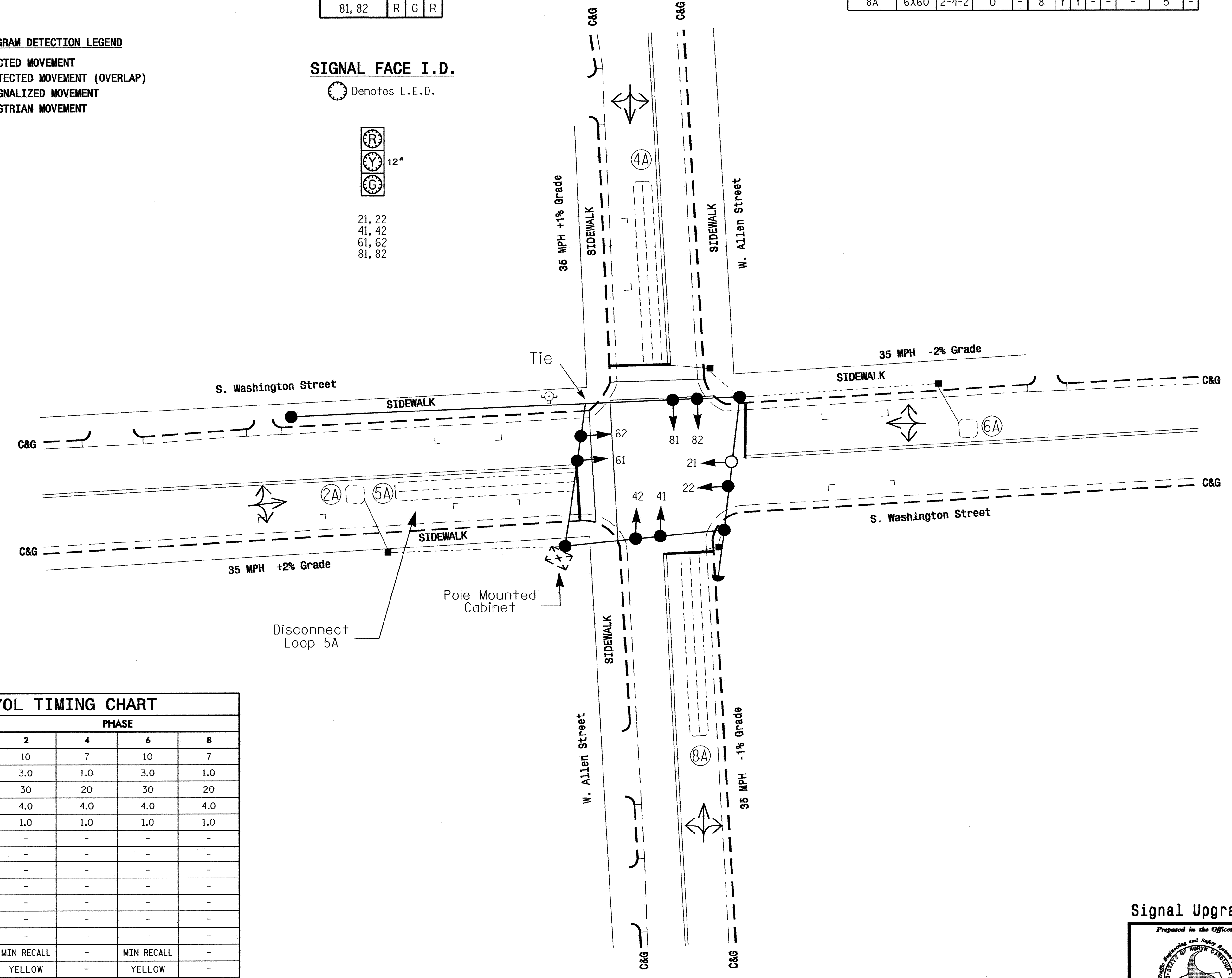

**2070L TIMING CHART**

FEATURE	PHASE			
	2	4	6	8
Min Green 1 *	10	7	10	7
Extension 1 *	3.0	1.0	3.0	1.0
Max Green 1 *	30	20	30	20
Yellow Clearance	4.0	4.0	4.0	4.0
Red Clearance	1.0	1.0	1.0	1.0
Walk 1 *	-	-	-	-
Don't Walk 1	-	-	-	-
Seconds Per Actuation *	-	-	-	-
Max Variable Initial *	-	-	-	-
Time Before Reduction *	-	-	-	-
Time To Reduce *	-	-	-	-
Minimum Gap	-	-	-	-
Recall Mode	MIN RECALL	-	MIN RECALL	-
Vehicle Call Memory	YELLOW	-	YELLOW	-
Dual Entry	-	ON	-	ON
Simultaneous Gap	ON	ON	ON	ON

\* These values may be field adjusted. Do not adjust Min Green and Extension times for phases 2 and 6 lower than what is shown. Min Green for all other phases should not be lower than 4 seconds.

**LEGEND**

PROPOSED	EXISTING
○ → Traffic Signal Head	● → N/A
● → Modified Signal Head	-
□ → Sign	-
□ → Pedestrian Signal Head With Push Button & Sign	-
□ → Signal Pole with Guy	-
□ → Signal Pole with Sidewalk Guy	-
□ → Inductive Loop Detector	-
□ → Controller & Cabinet	-
□ → Junction Box	-
- - - 2-in Underground Conduit	- - -
- - - Right of Way	- - -
→ Directional Arrow	→
→ Pavement Marking Arrow	→

Signal Upgrade - Final Design

Prepared in the Office of:  
  
**S. Washington Street at W. Allen Street**  
 Division 14 Henderson County Hendersonville  
 PLAN DATE: March 2004 REVIEWED BY: B L Watson  
 PREPARED BY: R N Mouberry REVIEWED BY:  
 SCALE: 1"=20'  
 REVISIONS: INIT. DATE  
 SIGNATURE: *R N Mouberry* DATE: 3/23/04  
 SEAL: NORTH CAROLINA PROFESSIONAL ENGINEER SEAL 24393  
 SIGNATURE: *Timothy J. Williams* DATE: 3/23/04  
 SIG. INVENTORY NO. 14-1161

23-MAR-2004 10:28  
 R:\P000\lee-unit\workgroups\TIP Projects\B-3475\41161\_20030223.dgn  
 rnmouberry