

5/28/99

DITCH LEGEND	
LEFT DITCH	-----
MEDIAN DITCH	-----
RIGHT DITCH	-----

USGS MONUMENT E-49, STANDARD BRASS DISK SET IN THE NORTHEAST WINGWALL OF THE CONCRETE ABUTMENT OF THE RAILROAD BRIDGE OVER SECOND CREEK, BM IS 18' FROM THE CENTERLINE OF THE TRACKS.
 N 718.704.2290 E 1,525.635.0810
 BL STA 300+19.88 1514.28' RT.
 ELEV. 672.48

PROJECT REFERENCE NO. R-2911D	SHEET NO. 24
ROADWAY DESIGN ENGINEER DAVID W. BASS 10/16/04	HYDRAULICS ENGINEER JAMES W. BASS 10/16/04
PBSJ POST, BUCKLEY, SCHUH & JERNIGAN, INC. 1616 EAST MILLBROOK ROAD, SUITE 310 RALEIGH, NORTH CAROLINA 27609	

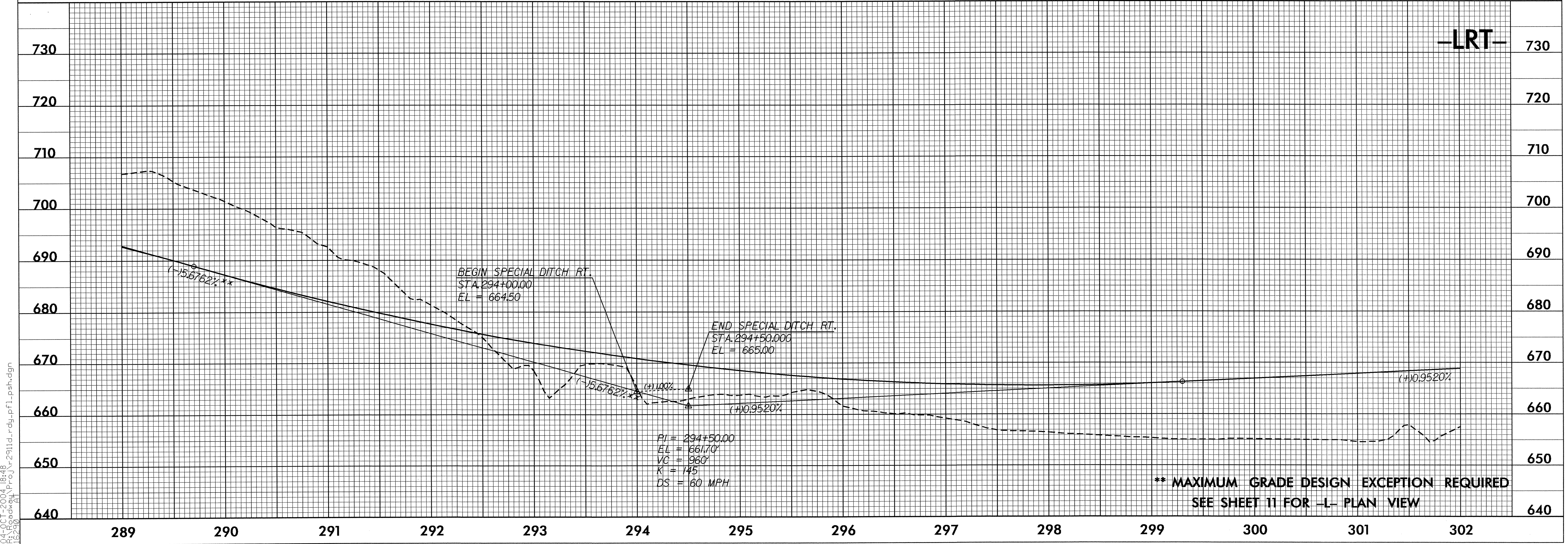
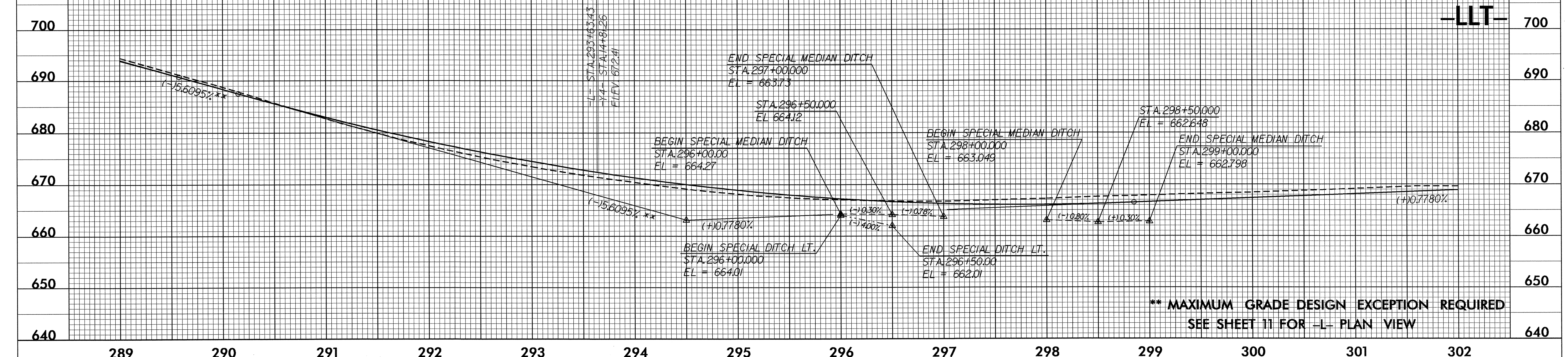

04-OCT-2004 18:48
 R:\Roadway\Proj\2911d.rdy.pfl.psh.dgn
 18290