

STATE	STATE PROJECT REFERENCE NO.	SHEET NO.	TOTAL SHEETS
N.C.	R-2911D	2A	36
STATE PROJ. NO.	F.A. PROJ. NO.	DESCRIPTION	
8.1631801	STP-70(39)	PE	

STATE OF NORTH CAROLINA
DIVISION OF HIGHWAYS

ROWAN COUNTY

**LOCATION: US 70 FROM SR 1739 (HILDEBRAND ROAD)
TO WEST OF SR 1953 (KEPLEY ROAD)**

**TYPE OF WORK: GRADING, DRAINAGE, PAVING, WIDENING, RESURFACING,
STRUCTURES, SIGNING, SIGNALS, AND GUARDRAIL**

See Sheet 1-A For Index of Sheets
See Sheet 1-B For Conventional Symbols

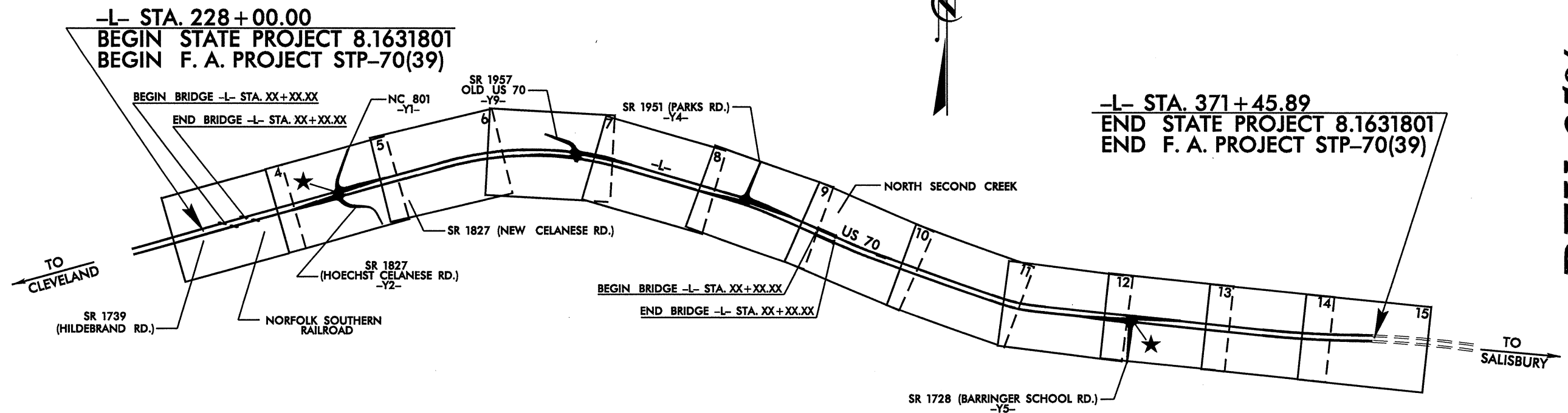
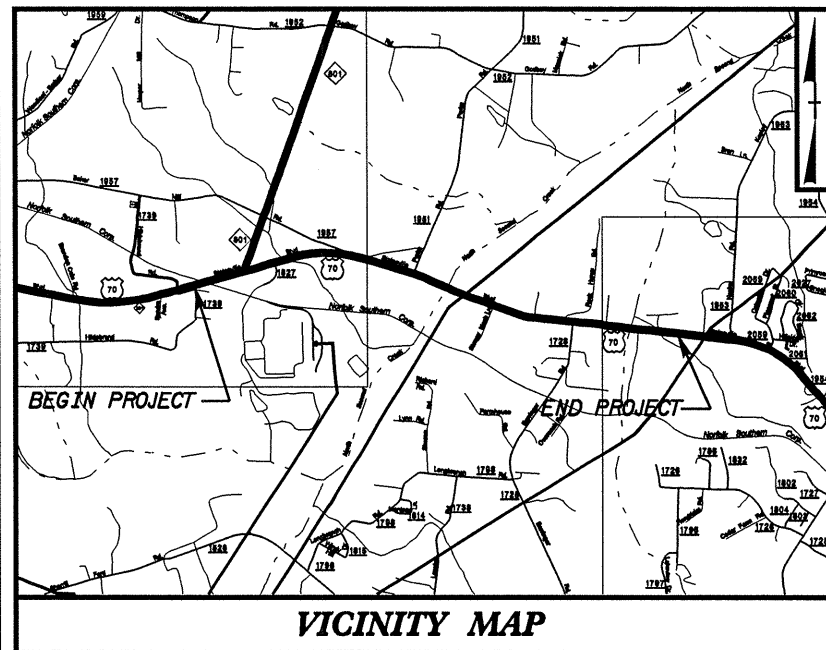

NCDOT CONTACT: **CATHY S. HOUSER, P.E.**
PROJECT ENGINEER
DESIGN SERVICES

NOTE: THIS PROJECT IS NOT WITHIN THE CITY LIMITS OF SALISBURY

★ PROPOSED SIGNAL

INCOMPLETE PLANS
DO NOT USE FOR R/W ACQUISITION
PRELIMINARY PLANS
DO NOT USE FOR CONSTRUCTION

REV. 25% PLANS

GRAPHIC SCALES

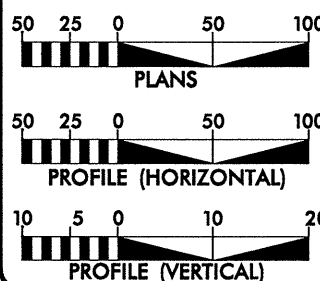

DESIGN DATA

ADT 2004 = 15,100
ADT 2024 = 24,000
DHV = 10 %
D = 60 %
T = 8 % *
V = 60 MPH**
* TTST 6 % DUAL 2 %

PROJECT LENGTH

LENGTH ROADWAY F. A. PROJECT STP-70(39) = 0.000 MILES
LENGTH STRUCTURES F. A. PROJECT STP-70(39) = 0.000 MILES
TOTAL LENGTH STATE PROJECT 8.1631801 = 2.717 MILES

** DESIGN EXCEPTION REQUIRED

Prepared in the Office of:
PBS&J POST, BUCKLEY, SCHUH & JERNIGAN, INC.
3214 SPRING FOREST ROAD
RALEIGH, NORTH CAROLINA 27616
For the North Carolina Department of Transportation
2002 STANDARD SPECIFICATIONS

RIGHT OF WAY DATE:
September 20, 2002

LETTING DATE:
August 17, 2004

Steve Drum, PE
PBS&J PROJECT ENGINEER

Rhonda B. Early, PE
PBS&J PROJECT DESIGN ENGINEER

HYDRAULICS ENGINEER

SIGNATURE: _____ P.E.
ROADWAY DESIGN ENGINEER

SIGNATURE: _____ P.E.

**DIVISION OF HIGHWAYS
STATE OF NORTH CAROLINA**

STATE DESIGN ENGINEER
**DEPARTMENT OF TRANSPORTATION
FEDERAL HIGHWAY ADMINISTRATION**

APPROVED
DIVISION ADMINISTRATOR DATE

R-2911D

PROJECT: 8.1631801

09/08/04