

-Y9-	
PI Sta 15+96.87	PI Sta 18+87.21
$\Delta = 0^{\circ}56'35.3"$ (RT)	$\Delta = 70^{\circ}39'37.6"$ (RT)
D = 1'00'00.0"	D = 35'00'00.0"
L = 94.31'	L = 201.89'
T = 47.16'	T = 116.04'
R = 5729.58'	R = 16370'
SE = NC	SE = 0.03
DS = 40 MPH	DS = <20 MPH

-Y9- Sta.14+83.72
BEGIN CONSTRUCTION

NOTE:
NON-TYPICAL SIDE SLOPES
USED FROM STA 269+50
TO STA 272+00

-L-	
PI Sta 268+02.05	
$\Delta = 29^{\circ}37'23.7"$ (RT)	
D = 1'30'28.0"	
L = 1964.69'	
T = 1004.83'	
R = 3800.00'	
SE 0.05	
DS = 65 MPH	

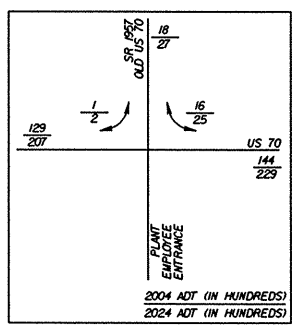

Note: See Sheet 19 for -L- line profile
See Sheet 29 for -Y9- line profile

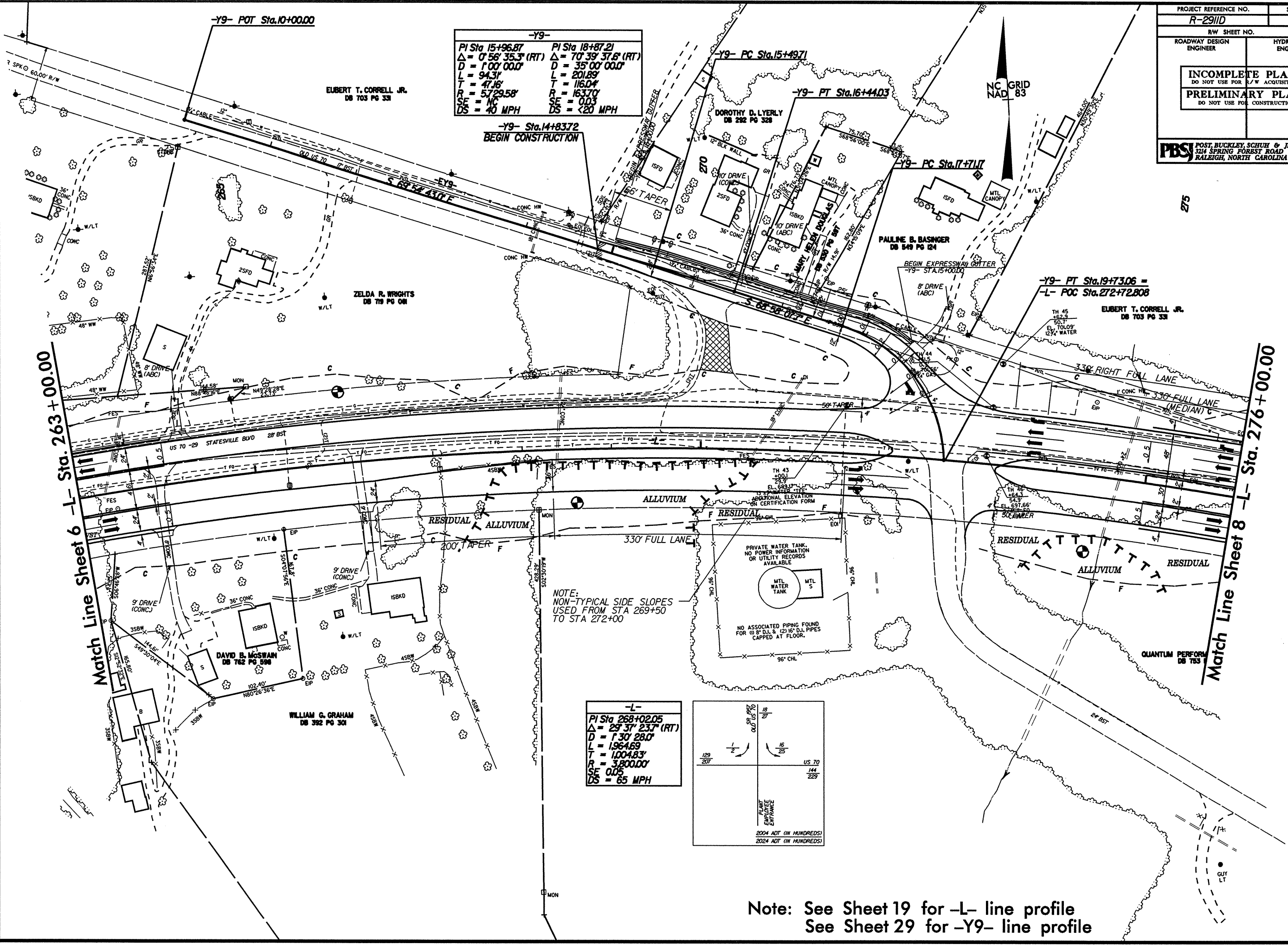

SYSTEMS
 ADDITIONS
 REVISIONS