

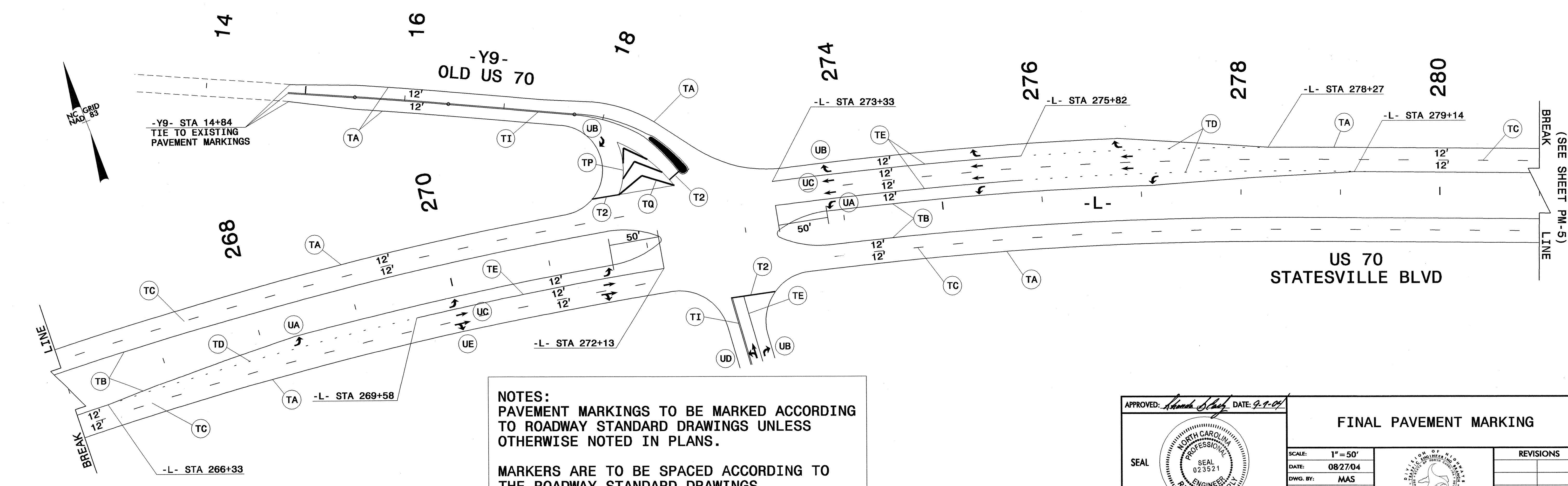

1616 EAST MILLBROOK ROAD, SUITE 310
 RALEIGH, NORTH CAROLINA 27609
 PHONE: (919) 876-6888

PROJ. REFERENCE NO.	SHEET NO.
R-2911D	PM-4

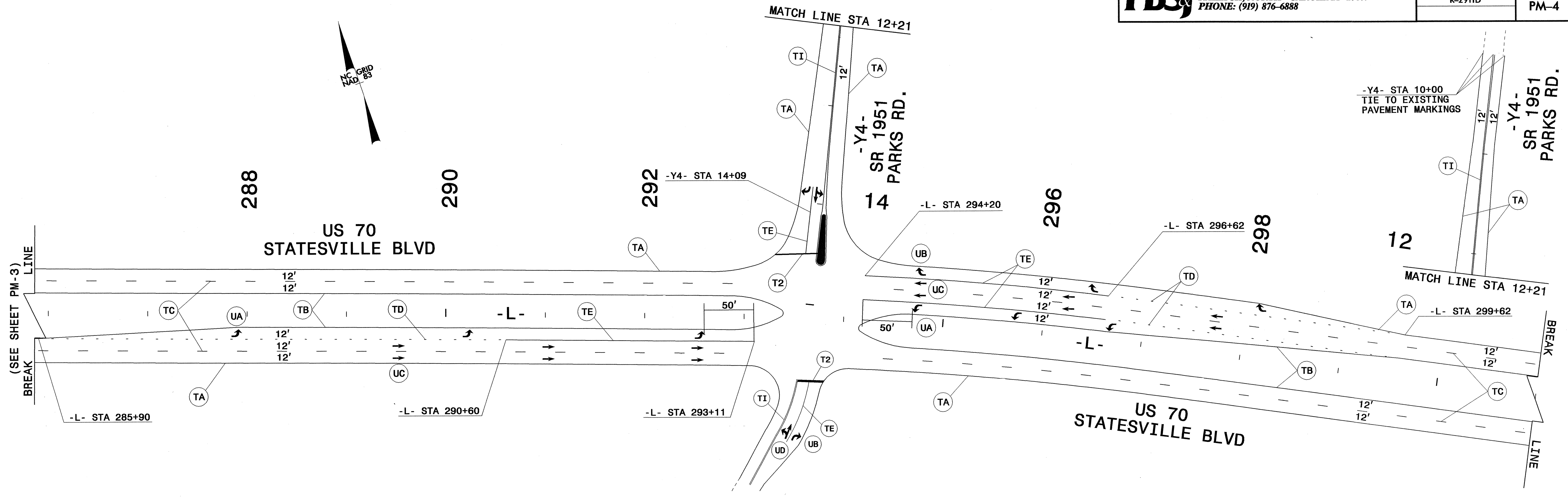

NOTES:
 PAVEMENT MARKINGS TO BE MARKED ACCORDING TO ROADWAY STANDARD DRAWINGS UNLESS OTHERWISE NOTED IN PLANS.
 MARKERS ARE TO BE SPACED ACCORDING TO THE ROADWAY STANDARD DRAWINGS.

APPROVED: *Rhonda B. Early* DATE: 9-9-04

FINAL PAVEMENT MARKING	
SCALE: 1" = 50'	REVISIONS
DATE: 08/27/04	
DWG. BY: MAS	
DESIGN BY: JMH	
REVIEWED BY: RBE	