

8/17/99

19-AUG-2004 08:27
R:\Utilities\Ray_V\Projects\RDY_UC10.DGN
R:\Utilities\Ray_V\Projects\RDY_UC10.DGN

| | |
|---|-----------|
| PROJECT REFERENCE NO. | SHEET NO. |
| R-2911C | UC-10 |
| DESIGNED BY: JH | |
| DRAWN BY: JH | |
| CHECKED BY: CDB | |
| APPROVED BY: CDB | |
| REVISED: | |
| NORTH CAROLINA DEPARTMENT OF TRANSPORTATION DESIGN SERVICES UNIT PHONE: (919) 250-4128 FAX: (919) 250-4119 | |

UTILITY CONSTRUCTION

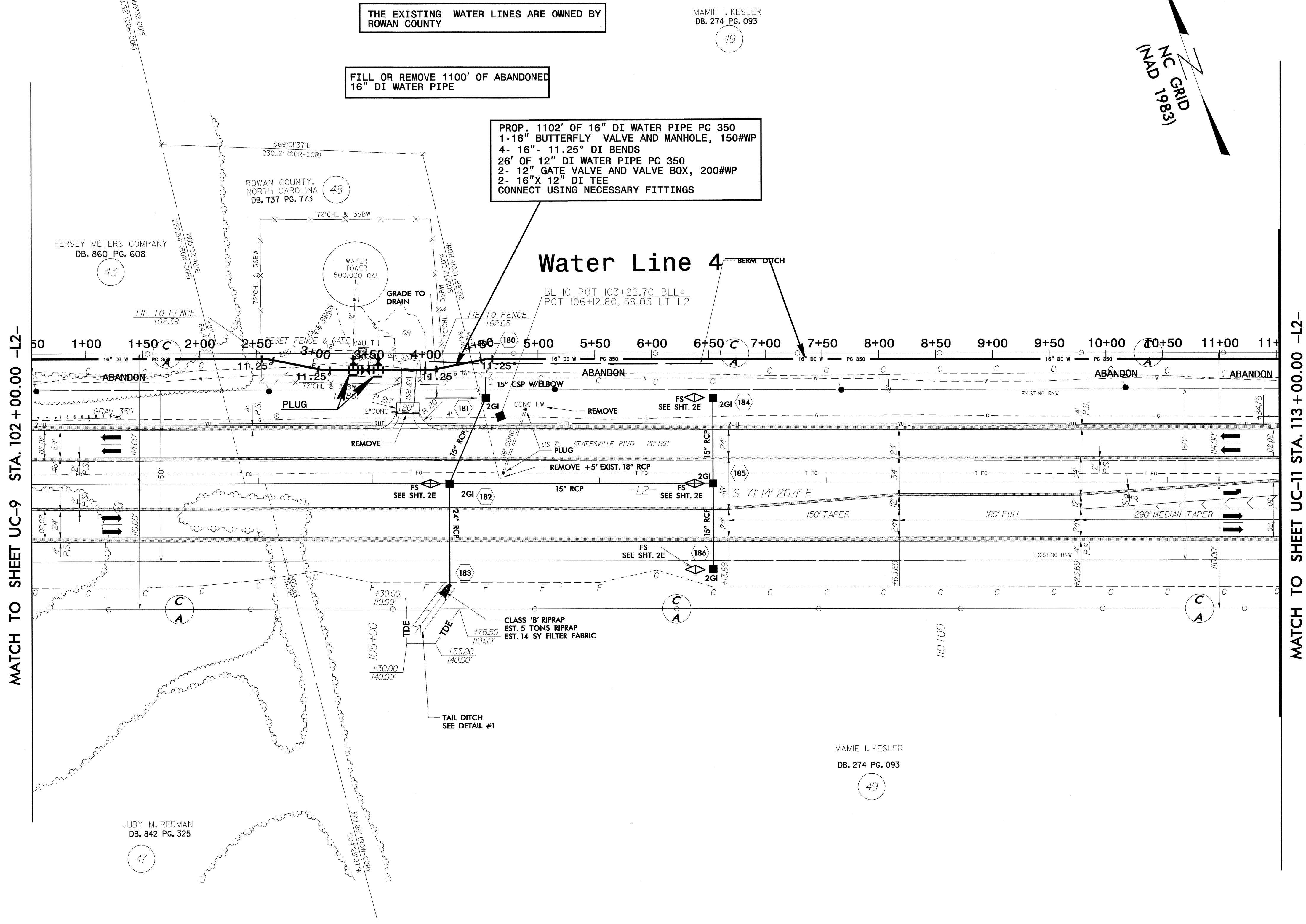

THE EXISTING WATER LINES ARE OWNED BY ROWAN COUNTY

MAMIE I. KESLER
DB. 274 PG. 093

FILL OR REMOVE 1100' OF ABANDONED 16" DI WATER PIPE

PROP. 1102' OF 16" DI WATER PIPE PC 350
1-16" BUTTERFLY VALVE AND MANHOLE, 150#WP
4- 16" - 11.25° DI BENDS
26' OF 12" DI WATER PIPE PC 350
2- 12" GATE VALVE AND VALVE BOX, 200#WP
2- 16" X 12" DI TEE
CONNECT USING NECESSARY FITTINGS

Water Line 4

BL=10 POT 103+22.70 BLL=
POT 106+12.80, 59.03 LT L2

MATCH TO SHEET UC-9 STA. 102 + 00.00 -L2-

MATCH TO SHEET UC-11 STA. 113 + 00.00 -L2-

MAMIE I. KESLER
DB. 274 PG. 093

JUDY M. REDMAN
DB. 842 PG. 325

47

49