

UTILITIES BY OTHERS

NOTE:
ALL PROPOSED UTILITY WORK
SHOWN ON THIS SHEET WILL
BE DONE BY OTHERS

8/17/99
 24-AUG-2004 15:31
 R:\Utilities\Proj-U0-10\Drawings\U0-10.dgn
 J:\Projects\2004\24-AUG-2004\Drawings\U0-10.dgn
 J:\Projects\2004\24-AUG-2004\Drawings\U0-10.dgn

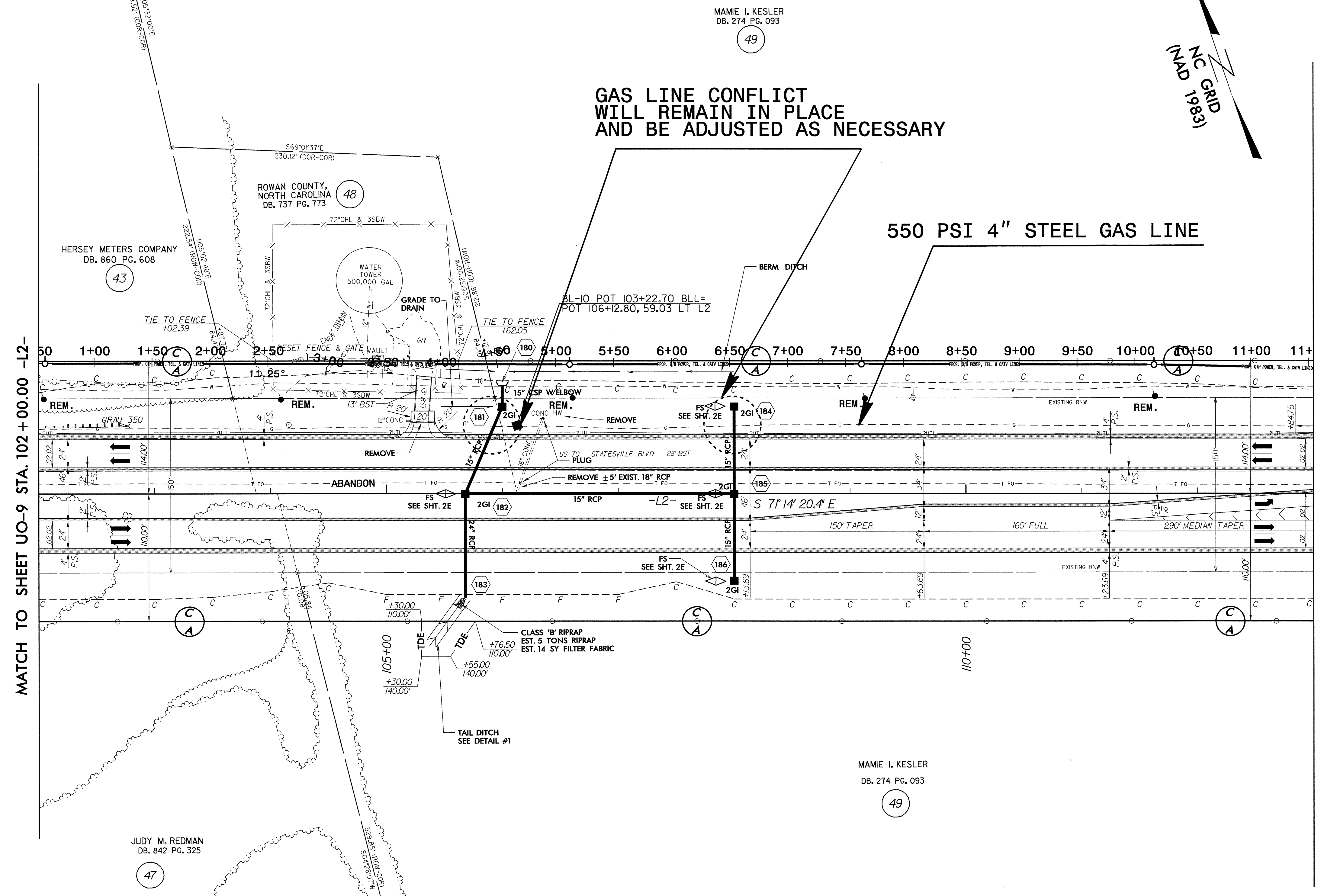

JUDY M. REDMAN
DB. 842 PG. 325
47

MAMIE I. KESLER
DB. 274 PG. 093
49

N83°42'38"W
380.84' (ROW-COR)