

UTILITIES BY OTHERS

NOTE:  
ALL PROPOSED UTILITY WORK  
SHOWN ON THIS SHEET WILL  
BE DONE BY OTHERS

NC GRID  
(MAD 1983)

GAS LINE CONFLICT  
WILL REMAIN IN PLACE  
AND BE ADJUSTED AS NECESSARY

550 PSI 4" STEEL GAS LINE

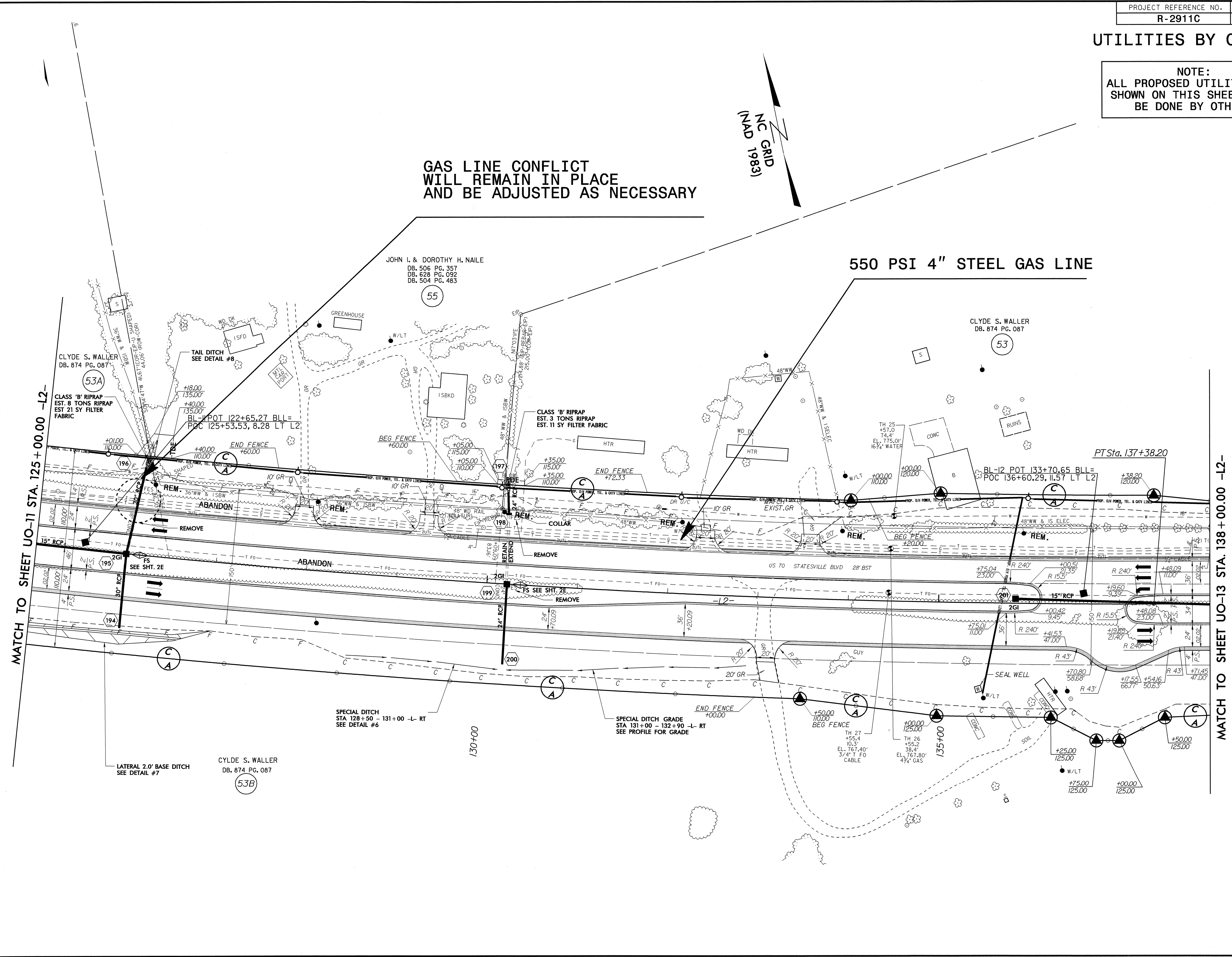

MATCH TO SHEET UO-11 STA. 125+00.00 -L2-

MATCH TO SHEET UO-13 STA. 138+00.00 -L2-

JOHN I. & DOROTHY H. NAILE  
DB. 506 PG. 357  
DB. 628 PG. 092  
DB. 504 PG. 483

CLYDE S. WALLER  
DB. 874 PG. 087

CLYDE S. WALLER  
DB. 874 PG. 087

CLASS 'B' RIPRAP  
EST. 8 TONS RIPRAP  
EST. 21 SY FILTER  
FABRIC

BL-12 POT 122+65.27 BLL=  
POC 125+53.53, 8.28 LT L2

CLASS 'B' RIPRAP  
EST. 3 TONS RIPRAP  
EST. 11 SY FILTER  
FABRIC

BL-12 POT 133+70.65 BLL=  
POC 136+60.29, 11.57 LT L2

PT Sta. 137+38.20

SPECIAL DITCH  
STA 128+50 - 131+00 -L- RT  
SEE DETAIL #6

SPECIAL DITCH GRADE  
STA 131+00 - 132+90 -L- RT  
SEE PROFILE FOR GRADE

LATERAL 2.0' BASE DITCH  
SEE DETAIL #7

CLYDE S. WALLER  
DB. 874 PG. 087

8/17/99

24-AUG-2004 16:10 J:\Projects\Proj\AR2911c-U012.dgn  
R:\Utilities\InCAD\US2122.dwg