

PROJECT REFERENCE NO. R-2911C	SHEET NO. 12
RW SHEET NO.	
ROADWAY DESIGN ENGINEER <i>[Signature]</i>	HYDRAULICS ENGINEER <i>[Signature]</i>
DAVID L. WILBUR 19026 819104	SEAL 3334 HENRY WELLS 9196
WILBUR SMITH ASSOCIATES P.O. BOX 2479 RALEIGH, NC 27601	SUNGATE DESIGN GROUP 915-A JONES FRANKLIN RD. RALEIGH, NC 27608

NOTES
1. FOR PROFILE OF: SEE SHEET NO:
L2 30, 31

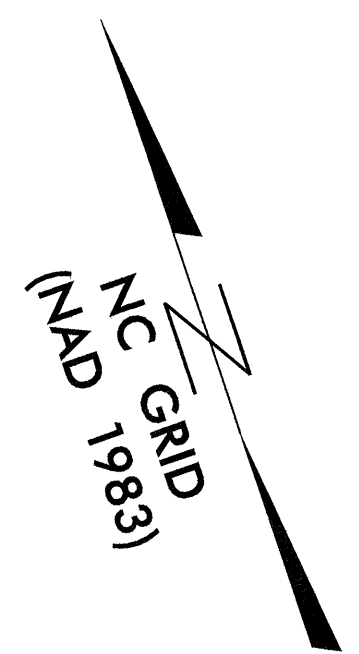

MAMIE I. KESLER
DB. 274 PG. 093
49

MAMIE I. KESLER
DB. 274 PG. 093
49

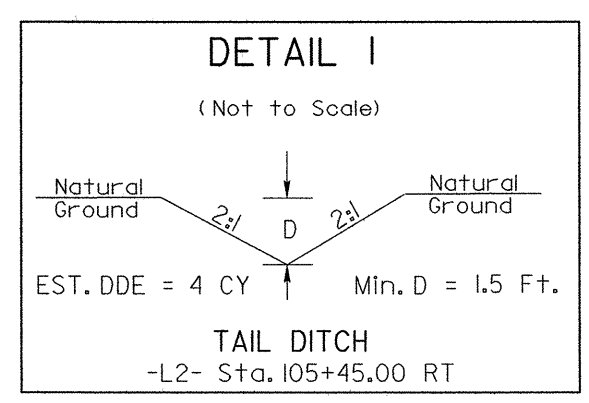
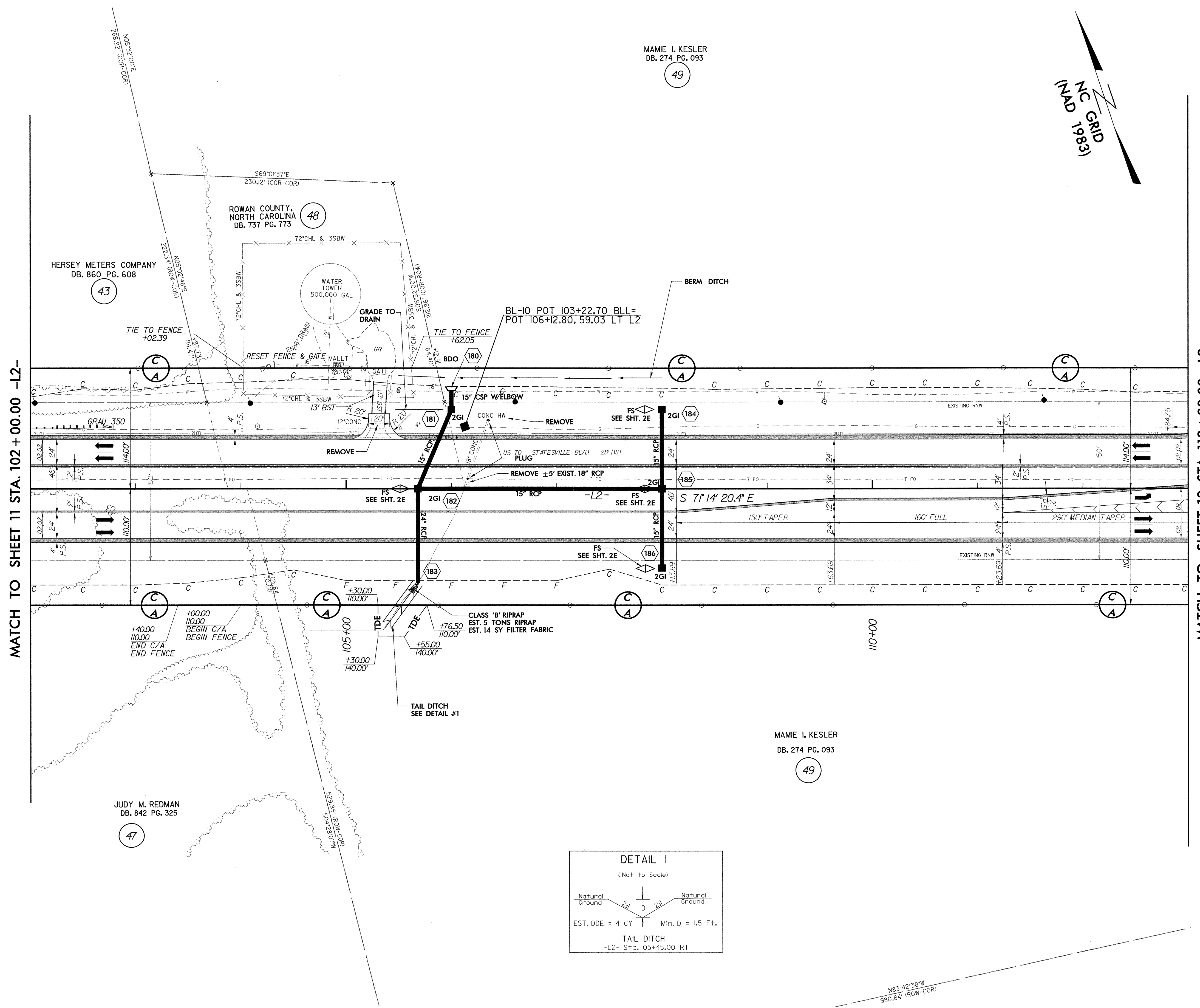

REVISIONS

8/17/99

DATE: 9/2/04
TIME: 4:53:11 PM
C:\roadway\proj\2911c_rdy_psh_12.dgn

MATCH TO SHEET 11 STA. 102 + 00.00 -L2-

MATCH TO SHEET 13 STA. 113 + 00.00 -L2-

HERSEY METERS COMPANY
DB. 860 PG. 608
43

ROWAN COUNTY,
NORTH CAROLINA
DB. 737 PG. 773
48

JUDY M. REDMAN
DB. 842 PG. 325
47

N83°42'38"W
980.84' (ROW-COR)