

|                         |                     |
|-------------------------|---------------------|
| PROJECT REFERENCE NO.   | SHEET NO.           |
| R-2911C                 | EC-27/CONST. 4      |
| R/W SHEET NO.           |                     |
| ROADWAY DESIGN ENGINEER | HYDRAULICS ENGINEER |

**DATUM DESCRIPTION**  
 THE LOCALIZED COORDINATE SYSTEM DEVELOPED FOR THIS PROJECT IS BASED ON THE STATE PLANE COORDINATES ESTABLISHED BY NCDOT FOR MONUMENT "384 JAS"  
 WITH STATE PLANE GRID COORDINATES OF  
 NORTHING: 724643.8657(11) EASTING: 1507152254(11)  
 THE AVERAGE COMBINED GRID FACTOR USED ON THIS PROJECT (GROUND TO GRID) IS: 0.999873400  
 THE N.C. LAMBERT GRID BEARING AND LOCALIZED HORIZONTAL GROUND DISTANCE FROM "384 JAS" TO -LT- STATION 7+57.57 IS N88°46'02.3" W, 9,394.16 FEET.  
 ALL LINEAR DIMENSIONS ARE LOCALIZED HORIZONTAL DISTANCES  
 VERTICAL DATUM USED IS NGVD 29

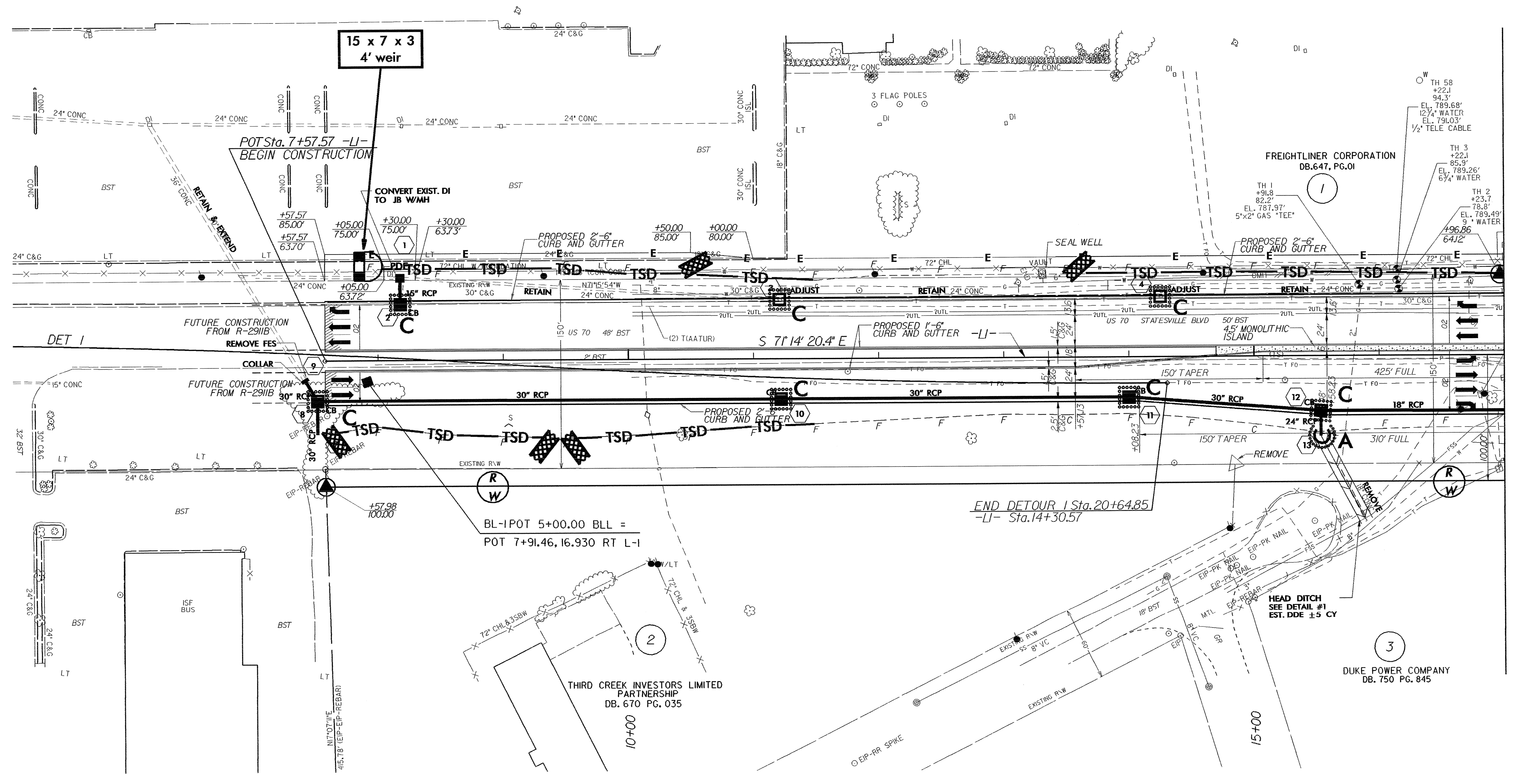
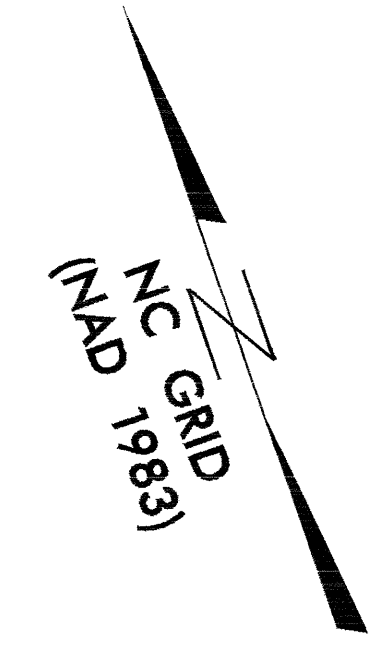
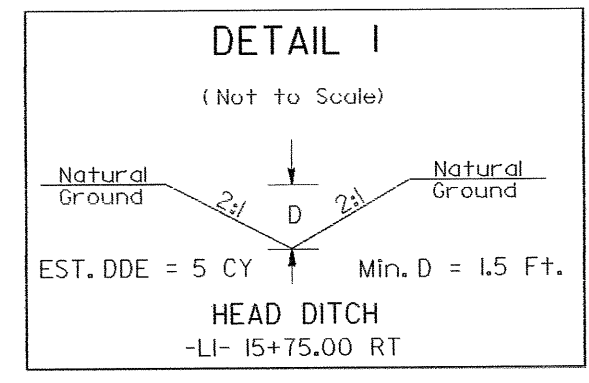

MATCH TO SHEET 5 STA. 17+00.00 -L1-

DUKE POWER COMPANY  
DB. 750 PG. 845

THIRD CREEK INVESTORS LIMITED  
PARTNERSHIP  
DB. 670 PG. 035

FREIGHTLINER CORPORATION  
DB. 647, PG. 01

15 x 7 x 3  
4' weir

END DETOUR 1 Sta. 20+64.85  
-L1- Sta. 14+30.57

BL-1 POT 5+00.00 BLL =  
POT 7+91.46, 16.930 RT L-1

POT Sta. 7+57.57 -L1-  
BEGIN CONSTRUCTION

DET 1

ISF BUS

HEAD DITCH  
SEE DETAIL #1  
EST. DDE ± 5 CY

NITROLINE  
465,718' (EP-EP-FREBAR)