

STATE	STATE PROJECT REFERENCE NO.	SHEET NO.	TOTAL SHEETS
N.C.	R-2514A	RF-2	
STATE PROJ. NO.	F.A. PROJ. NO.	DESCRIPTION	

# PLANTING DETAILS

## LIVE STAKES PLANTING DETAIL

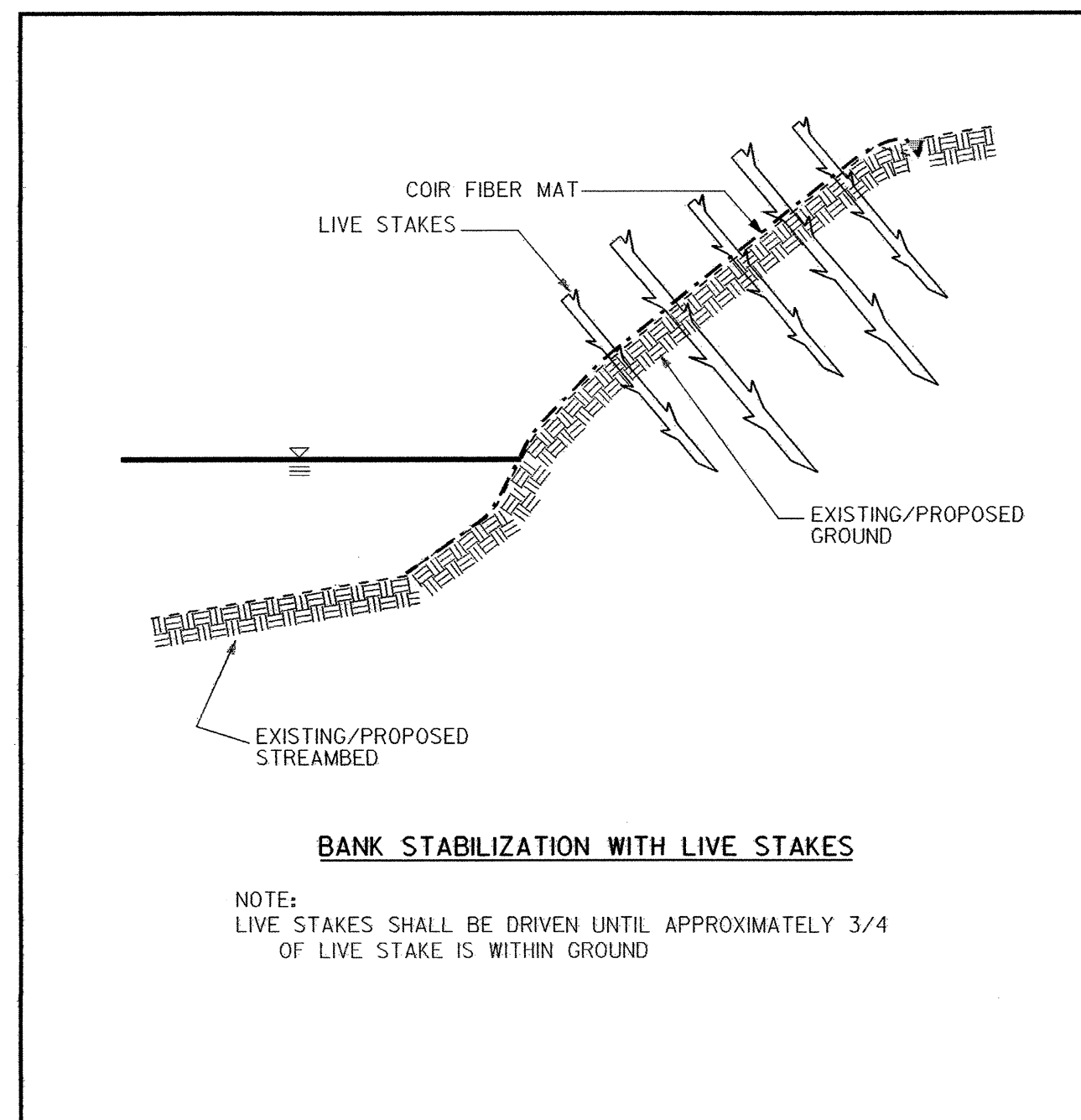
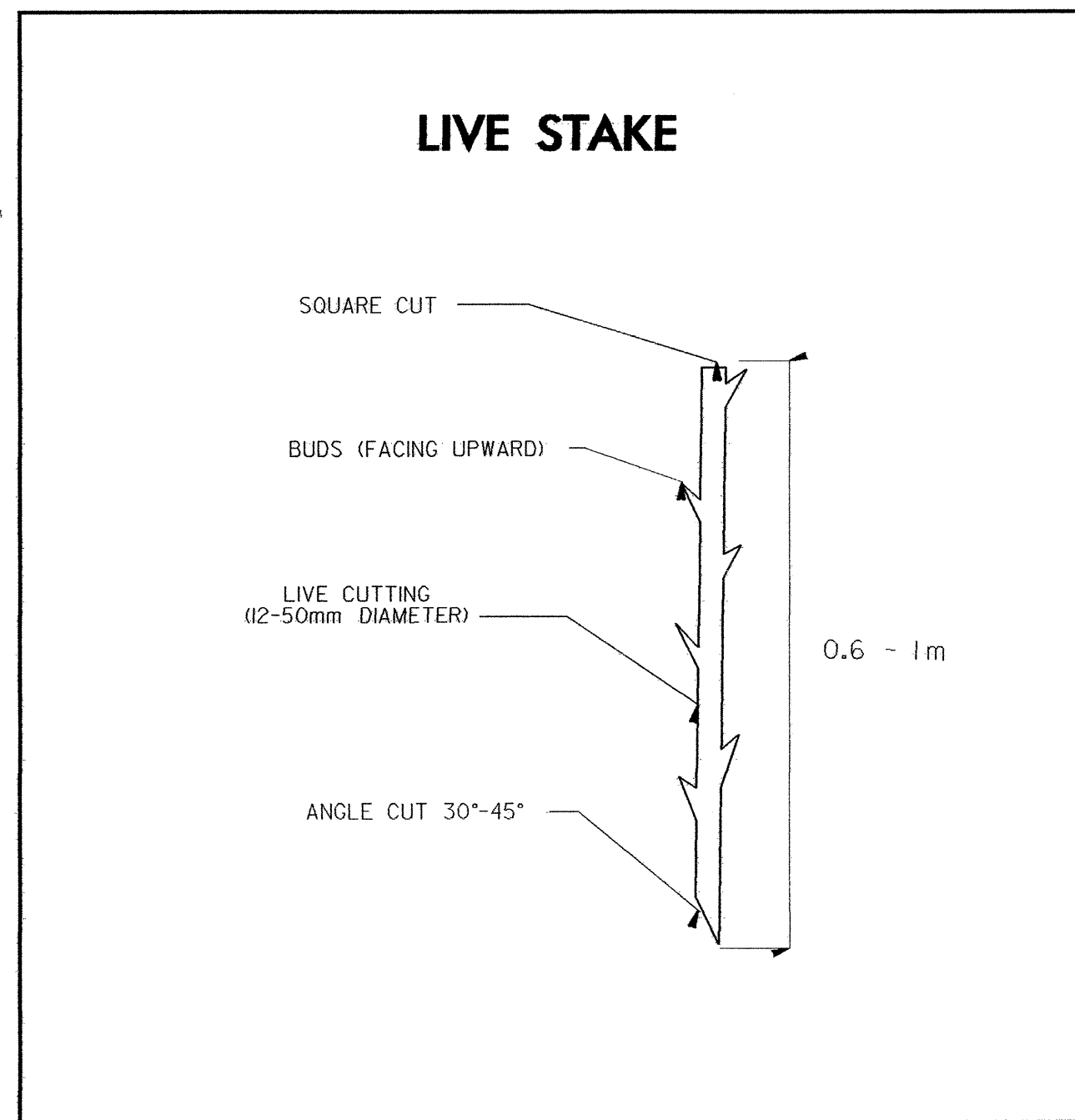

## BAREROOT PLANTING DETAIL DIBBLE PLANTING METHOD USING THE KBC PLANTING BAR

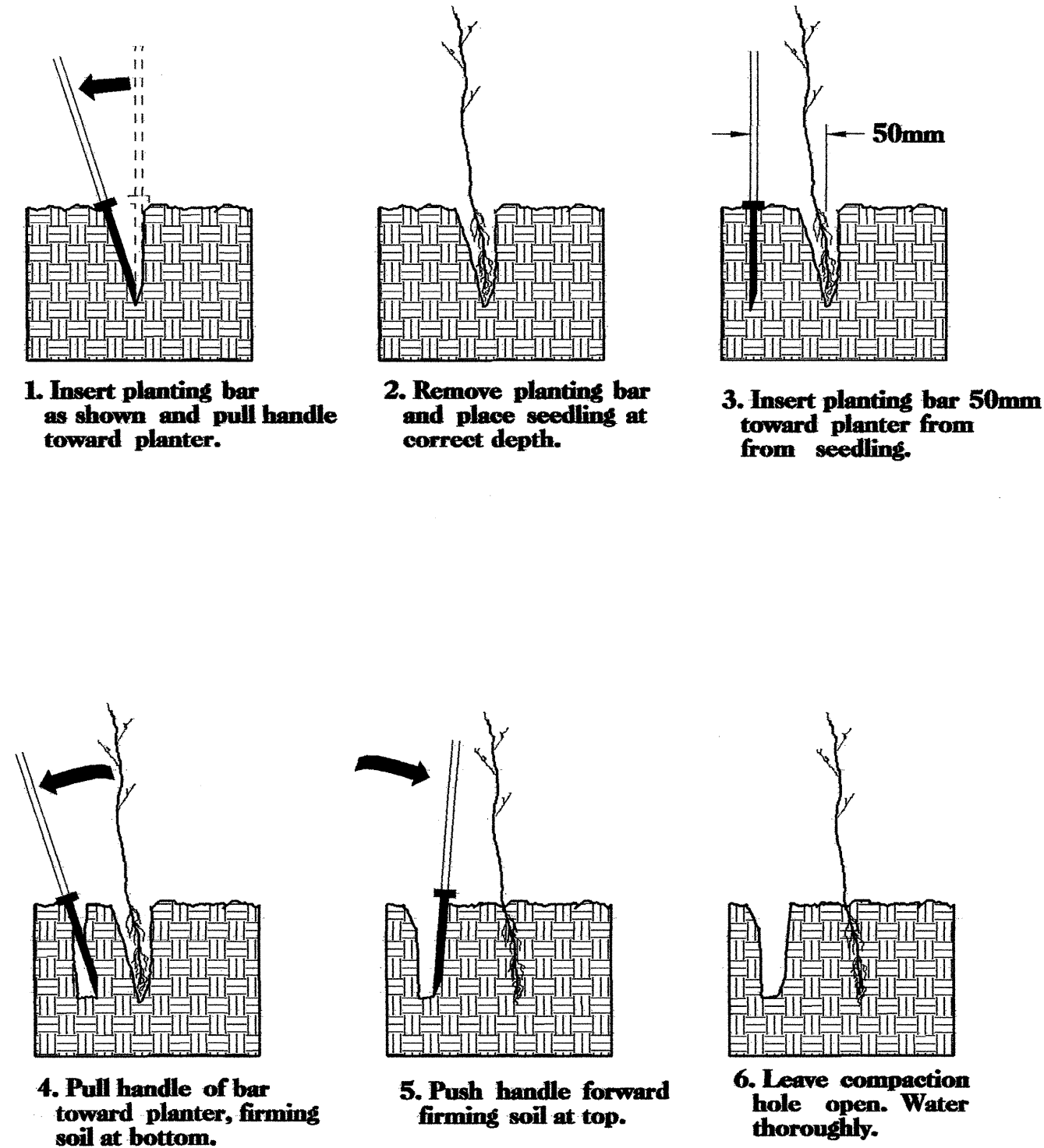

### PLANTING NOTES:

**PLANTING BAG**  
During planting, seedlings shall be kept in a moist canvas bag or similar container to prevent the root systems from drying.



**KBC PLANTING BAR**  
Planting bar shall have a blade with a triangular cross section, and shall be 300mm long, 100mm wide and 25mm thick at center.

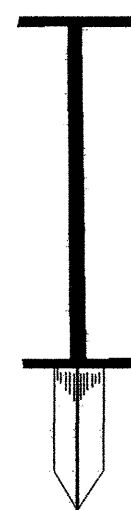

**ROOT PRUNING**  
All seedlings shall be root pruned, if necessary, so that no roots extend more than 250mm below the root collar.

- TYPE 1 STREAMBANK REFORESTATION SHALL BE PLANTED 0.9m TO 1.52m ON CENTER, RANDOM SPACING, AVERAGING 1.22m ON CENTER, APPROXIMATELY 6726 PLANTS PER HECTARE.
- TYPE 2 STREAMBANK REFORESTATION SHALL BE PLANTED 1.8m TO 3.0m ON CENTER, RANDOM SPACING, AVERAGING 2.4m ON CENTER, APPROXIMATELY 1680 PLANTS PER HECTARE.
- NOTE: TYPE 1 AND TYPE 2 STREAMBANK REFORESTATION SHALL BE PAID FOR AS "STREAMBANK REFORESTATION"

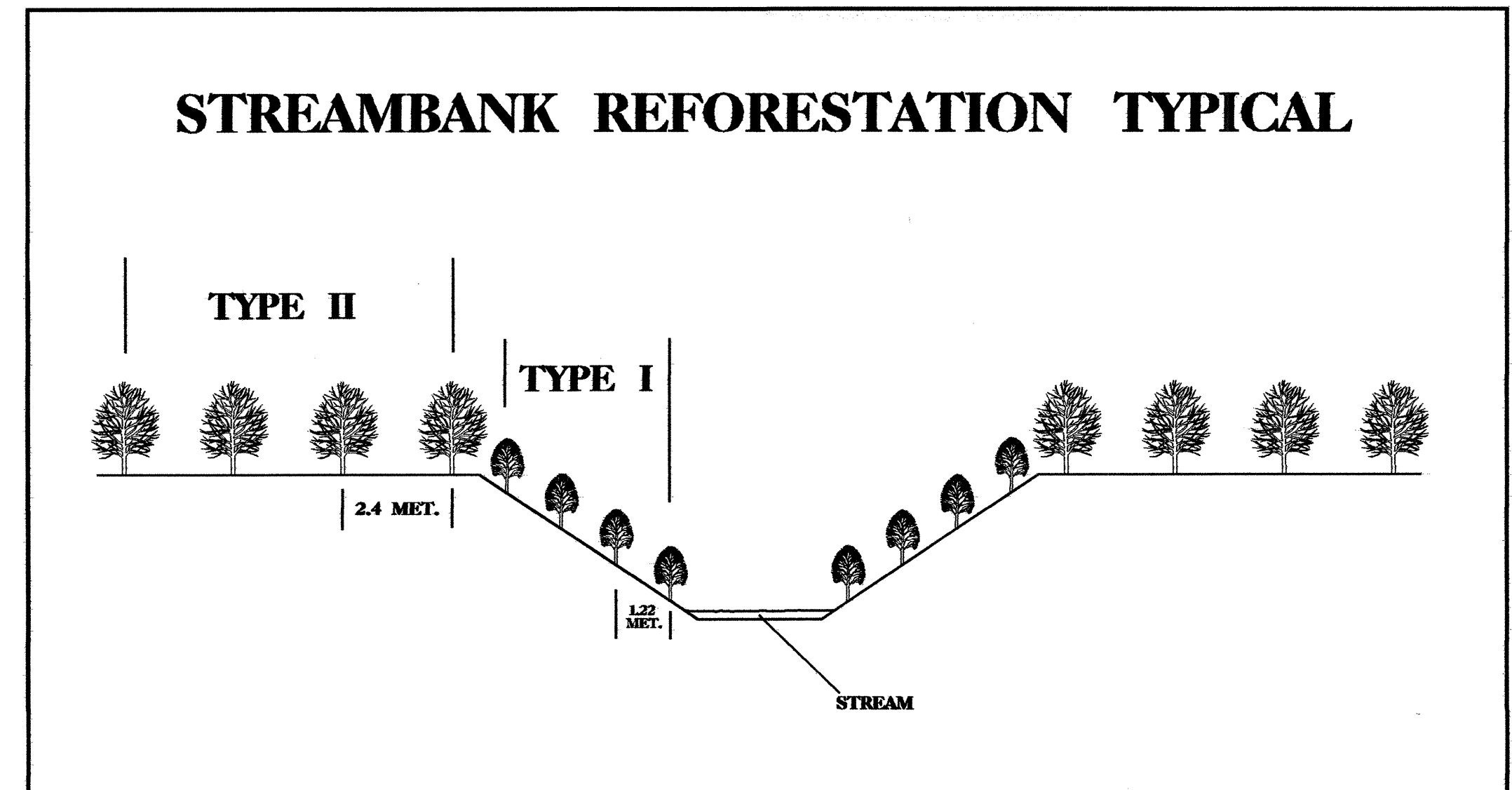

### STREAMBANK REFORESTATION

MIXTURE, TYPE, SIZE, AND FURNISH SHALL CONFORM TO THE FOLLOWING:

#### TYPE 1

50% SALIX NIGRA	BLACK WILLOW	0.6m to 1m LIVE STAKES
50% CORNUS AMOMUM	SILKY DOGWOOD	0.6m to 1m LIVE STAKES

#### TYPE 2

25% LIRIODENDRON TULIPIFERA	TULIP POPLAR	300mm - 460mm BR
25% QUERCUS PHELLOS	WILLOW OAK	300mm - 460mm BR
25% QUERCUS LAURIFOLIA	LAUREL OAK	300mm - 460mm BR
25% QUERCUS NIGRA	WATER OAK	300mm - 460mm BR

- SEE PLAN SHEETS FOR AREAS TO BE PLANTED

**STREAMBANK REFORESTATION  
DETAIL SHEET**  
N.C.D.O.T. - ROADSIDE ENVIRONMENTAL UNIT