

STAGE 1 CONSTRUCTION
(SPAN A & I)

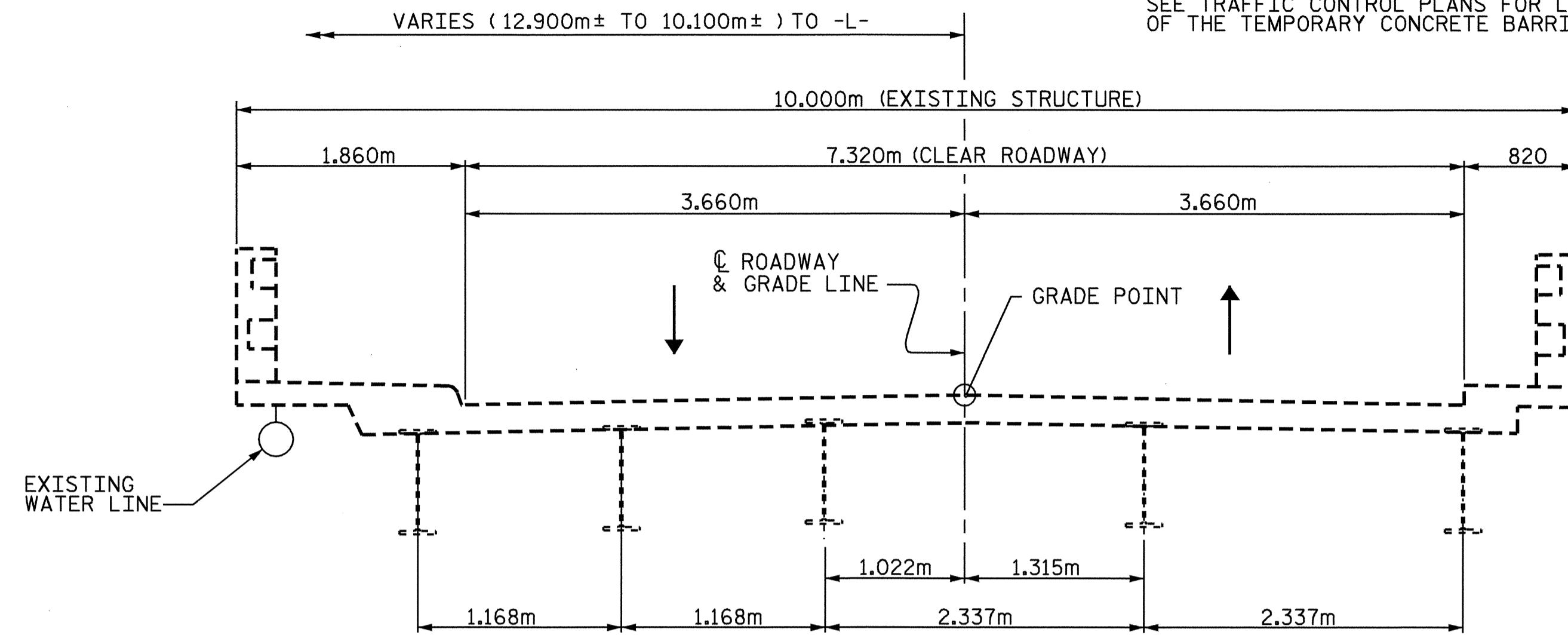

STAGE 1 TRAFFIC
(SPAN A & K EXISTING)

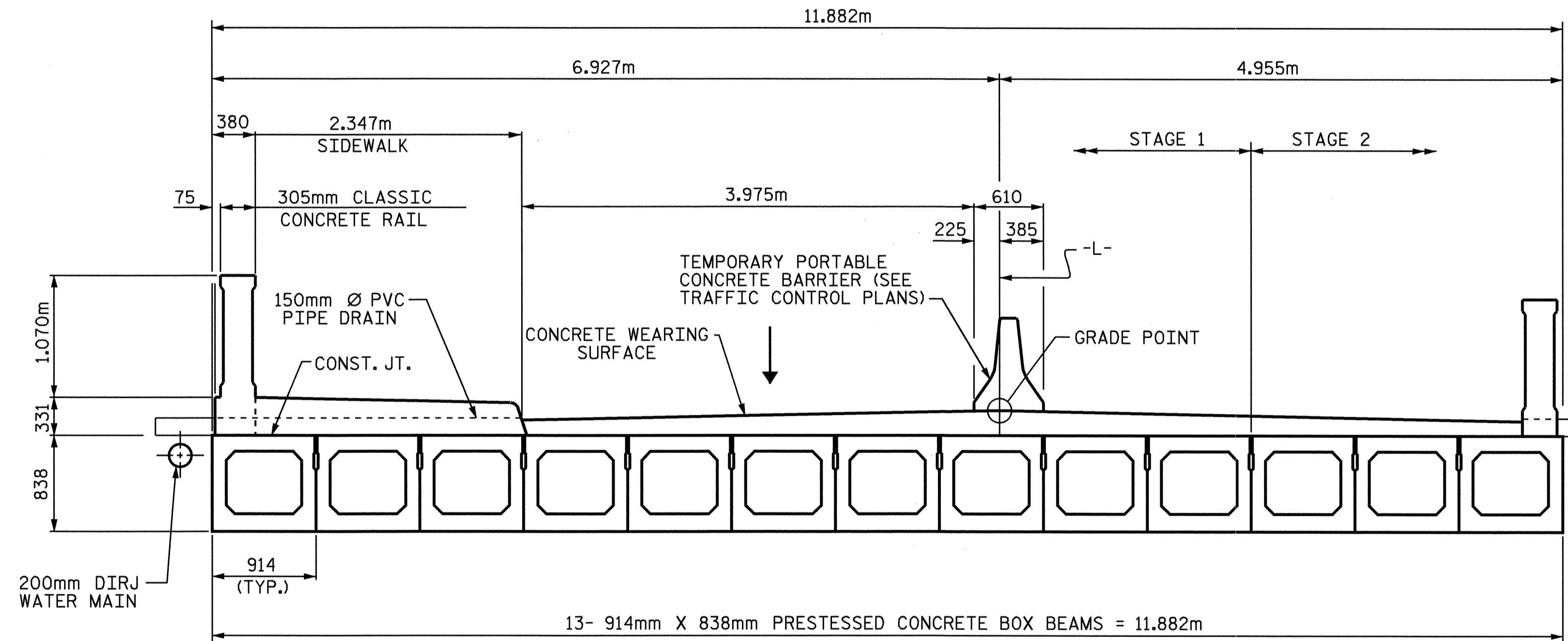

STAGE 2 TRAFFIC
(SPAN A & I)

STAGE 2 CONSTRUCTION
(SPAN A & I)

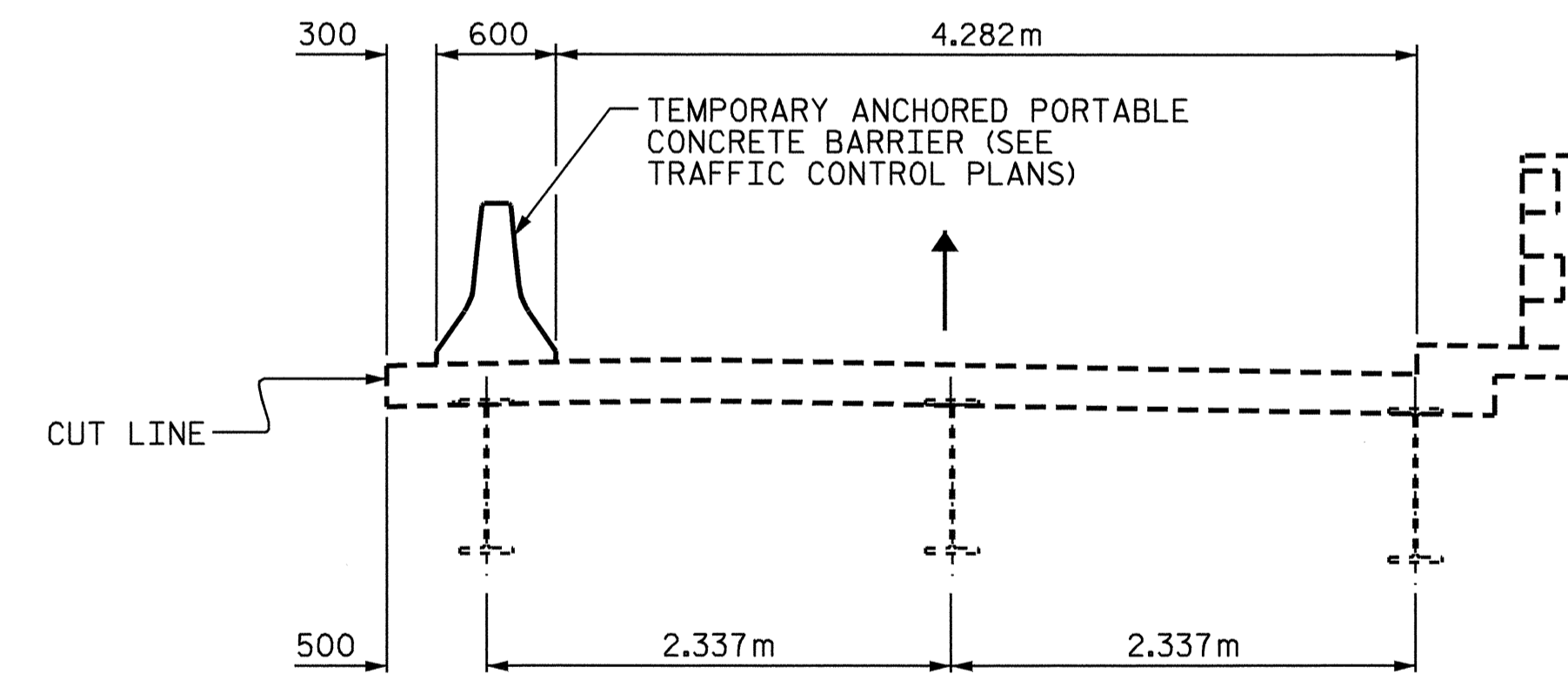

STAGE 2 TRAFFIC
(SPAN A & K EXISTING)

NOTES:
STAGE CONSTRUCTION APPLIES TO SPAN A & I FOR PROPOSED STRUCTURE AND SPAN A & K FOR EXISTING STRUCTURE.
THE EXISTING STRUCTURE SHALL NOT BE CUT UNTIL THE WATERLINE ON THE PROPOSED STRUCTURE IS IN SERVICE.
SEE TRAFFIC CONTROL PLANS FOR LOCATION AND PAY LIMITS OF THE TEMPORARY CONCRETE BARRIERS.

PROJECT NO. B-2583
MADISON COUNTY
STATION: 12+21.750 -L-

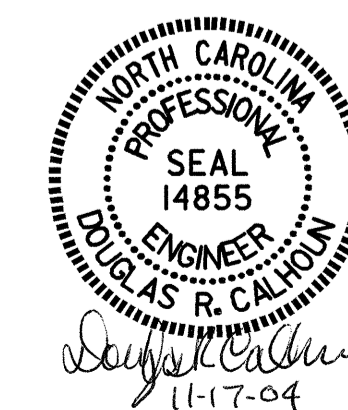

STATE OF NORTH CAROLINA DEPARTMENT OF TRANSPORTATION RALEIGH						CONSTRUCTION SEQUENCE	
REVISIONS						SHEET NO.	
NO.	BY:	DATE:	NO.	BY:	DATE:	S-7	
1			3			TOTAL SHEETS	
2			4			112	

DRAWN BY: A.L.M. & E.G.A. DATE: 6/8/04
CHECKED BY: D.R.CALHOUN DATE: 6/15/04