

POURING SEQUENCE

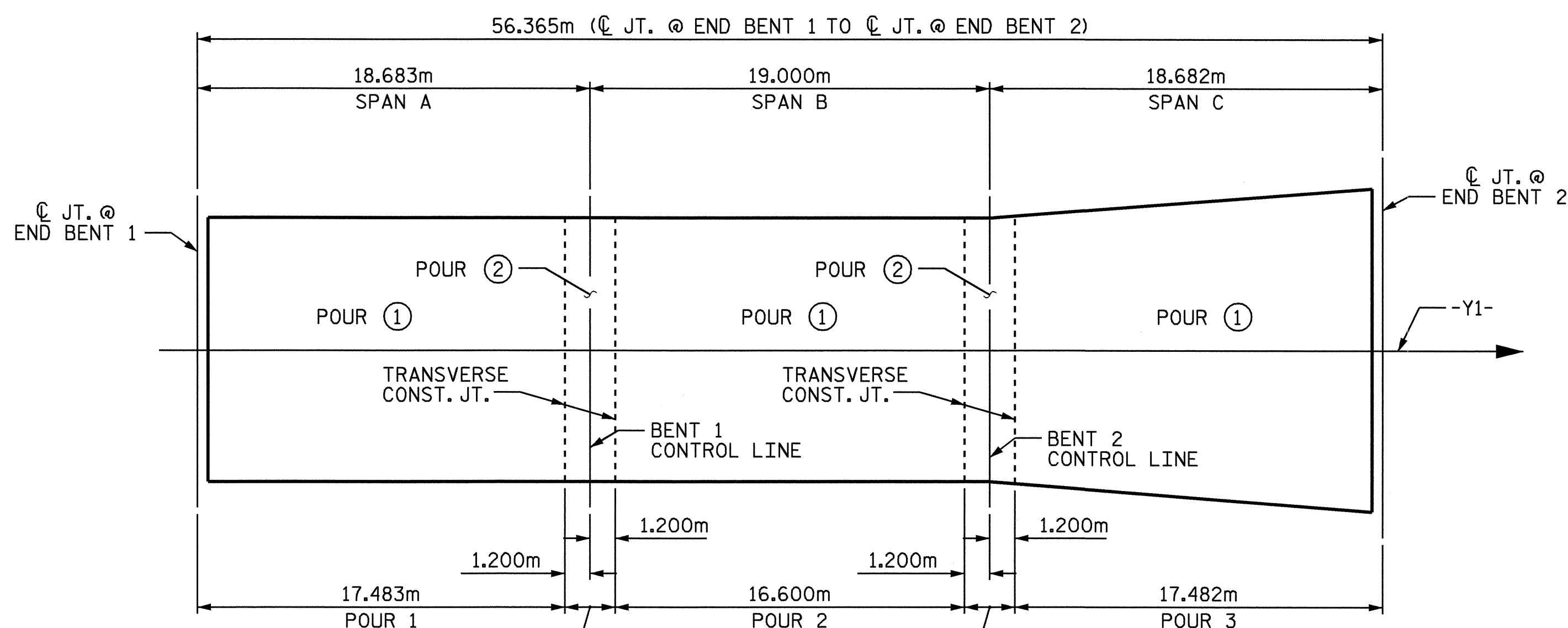

OPTIONAL POURING SEQUENCE

POUR #2 CANNOT BE STARTED UNTIL BOTH ADJACENT #1 POURS REACH A MINIMUM OF 20.7 MPa.

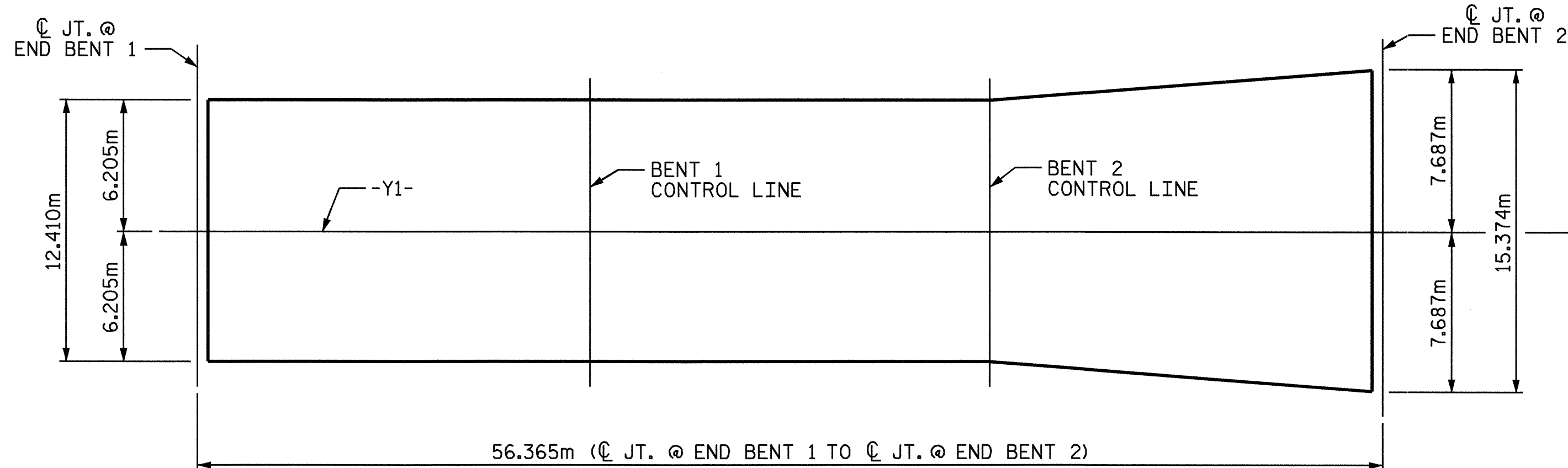

LAYOUT FOR COMPUTING AREA OF REINFORCED CONCRETE DECK SLAB (SQ. METER = 726.8)

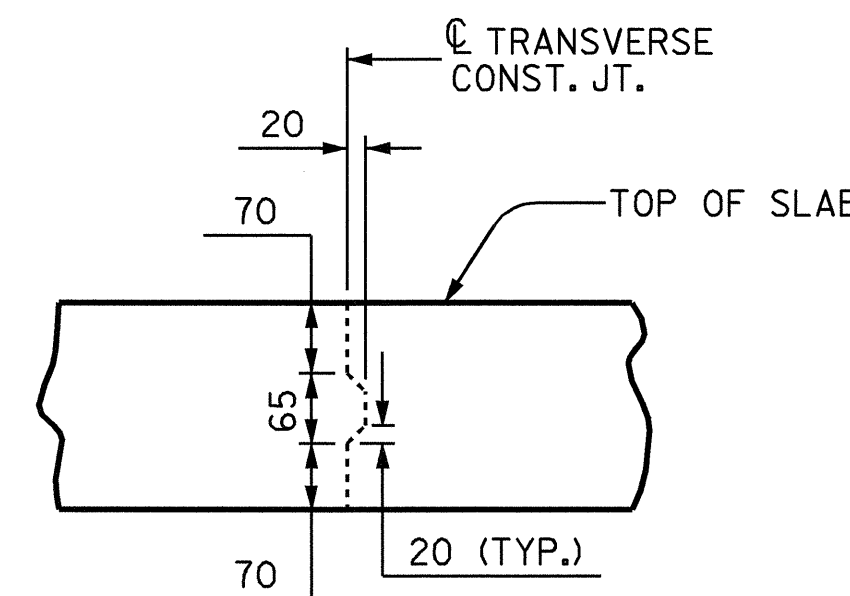

TRANSVERSE CONSTRUCTION JOINT DETAIL

NOTE: SLAB REINFORCING STEEL SHALL BE CONTINUOUS THRU JOINT

GROOVING BRIDGE FLOORS	
BRIDGE DECK	448.1 SQ.METER

CLASS AA CONCRETE BREAKDOWN	
	(CU. METER)
POUR 1	50.0
POUR 2	66.6
POUR 3	82.7
SIDEWALK	32.7
TOTAL	232.0

BILL OF MATERIAL						
BAR	NO	SIZE	TYPE	LENGTH	WEIGHT	
* A1	189	16	STR	12300	3608	
A2	189	16	STR	12300	3608	
* A3	62	16	STR	6920	666	
A4	62	16	STR	6860	660	
* A5	62	16	STR	7280	701	
A6	62	16	STR	7220	695	
* A7	62	16	STR	7660	737	
A8	62	16	STR	7600	731	
* A9	64	16	STR	8020	797	
A10	64	16	STR	7960	791	
* B1	32	16	STR	12920	642	
* B2	32	16	STR	7600	377	
* B3	4	16	STR	12960	80	
* B4	28	16	STR	12920	561	
* B5	2	16	STR	16760	52	
* B6	2	16	STR	12260	38	
* B7	2	16	STR	7860	24	
* B8	2	16	STR	3440	11	
* B9	64	16	STR	14400	1430	
* B10	112	16	STR	5700	991	
* B11	4	16	STR	14440	90	
B12	184	16	STR	14580	4164	
B13	30	16	STR	9680	451	
* B14	70	13	STR	8580	597	
* D1	162	13	STR	260	42	
* G1	1	16	STR	12300	19	
* G2	1	16	STR	15260	24	
* G3	378	13	STR	1500	564	
* K1	4	25	1	3220	51	
* K2	8	25	2	4700	149	
* K3	4	25	1	3760	60	
* K4	8	25	2	5780	184	
K5	20	16	STR	1700	53	
K6	20	16	5	1840	57	
K7	10	16	STR	2000	31	
K8	10	16	5	2140	33	
K9	20	13	STR	1580	31	
K10	40	13	STR	1760	70	
K11	20	13	STR	1080	21	
K12	16	13	STR	5660	90	
* S1	70	16	3	1460	159	
S2	95	13	4	1860	176	
S3	20	13	2	3700	74	
S4	40	13	2	4300	171	
S5	160	13	6	840	134	
* S6	504	16	7	1460	1142	
REINFORCING STEEL					kg	12041
* EPOXY COATED REINFORCING STEEL					kg	13796
* THESE BARS ARE EPOXY COATED						

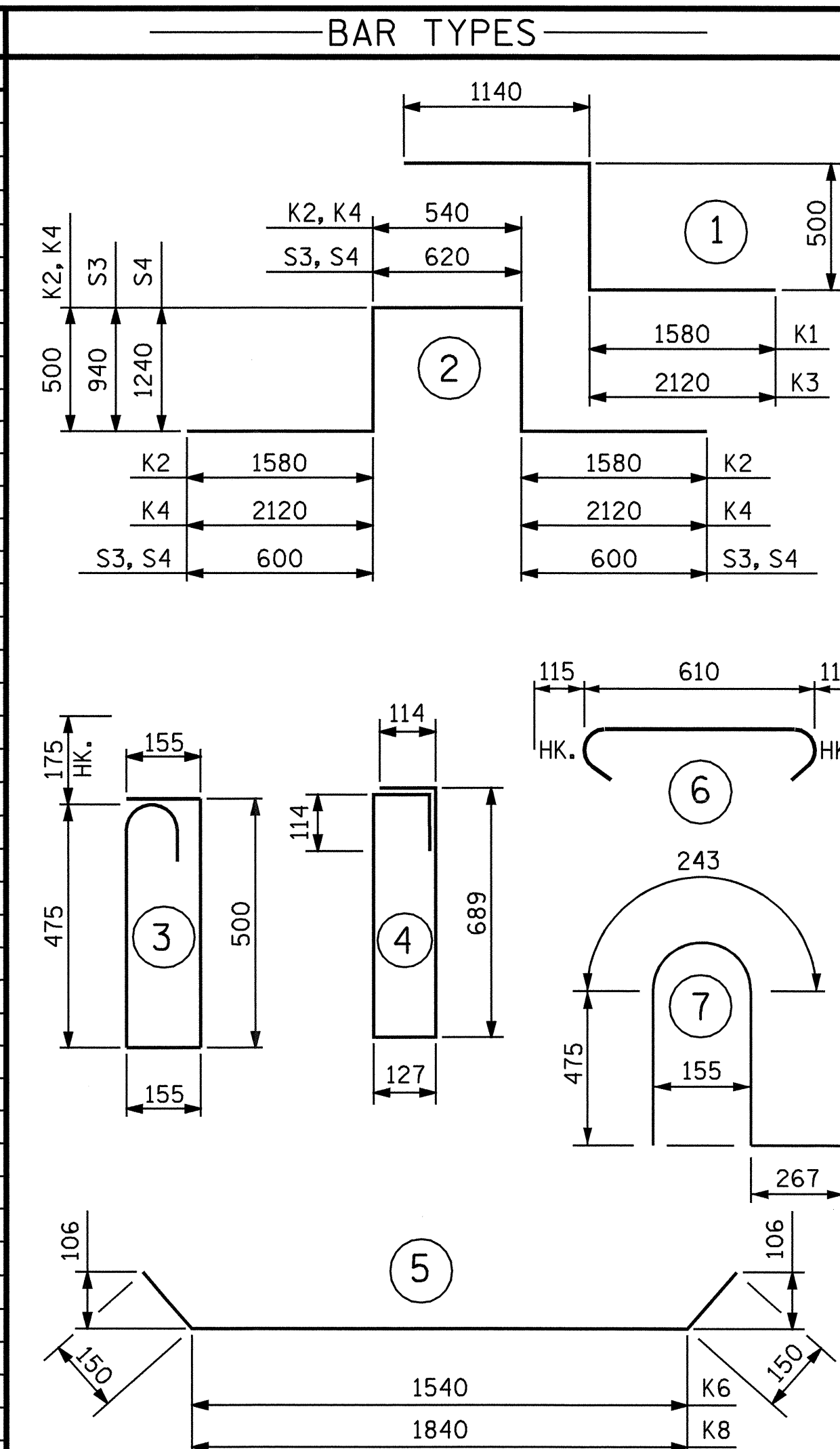

ALL BAR DIMENSIONS ARE OUT TO OUT

SUPERSTRUCTURE BILL OF MATERIAL

	CLASS AA CONCRETE	REINFORCING STEEL	EPOXY COATED REINFORCING STEEL
	(CU. METER)	(kg.)	(kg.)
SPAN A, B, AND C	232.0	12041	12565
TOTALS**	232.0	12041	12565

** QUANTITIES FOR CLASSIC CONCRETE BRIDGE RAIL NOT INCLUDED. SEE "CLASSIC CONCRETE BRIDGE RAIL AND SIDEWALK" SHEETS.

SUPERSTRUCTURE REINFORCING STEEL LENGTHS ARE BASED ON THE FOLLOWING MINIMUM SPLICE LENGTHS

BAR SIZE	SUPERSTRUCTURE EXCEPT APPROACH SLABS, PARAPET, AND BARRIER RAIL		APPROACH SLABS		PARAPET AND BARRIER RAIL
	EPOXY COATED	UNCOATED	EPOXY COATED	UNCOATED	
#13	610	540	610	540	840
#16	770	660	770	660	1050
#19	920	790	1 190	790	1330
#22	1580	1060			
#25	2080	1390			

PROJECT NO. **B-2583**
MADISON COUNTY
 STATION: **11+03.000 -Y1-**

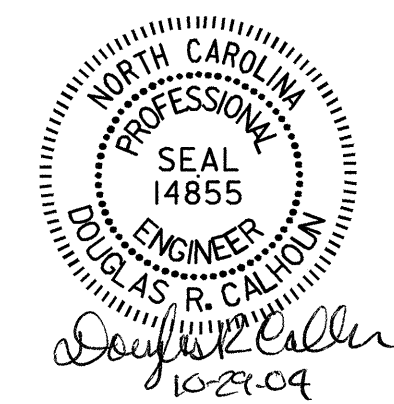

STATE OF NORTH CAROLINA
 DEPARTMENT OF TRANSPORTATION
 RALEIGH

SUPERSTRUCTURE BILL OF MATERIAL

REVISIONS						SHEET NO.	
NO.	BY:	DATE:	NO.	BY:	DATE:	S-93	
1			3			TOTAL SHEETS	
2			4			112	

ASSEMBLED BY : T. A. HARRIS DATE : 1/15/04
 CHECKED BY : W. S. ARAFAT DATE : 5/16/04
 DRAWN BY : JMB 5/87 REV. 5/16/97 EEM/RGW
 CHECKED BY : SJD 9/87