

**NOTES**

THE COST OF THE CLASSIC CONCRETE BRIDGE RAIL AND SIDEWALK ON THE APPROACH SLAB SHALL BE INCLUDED IN THE LUMP SUM CONTRACT PRICE BID FOR BRIDGE APPROACH SLABS.

APPROACH SLAB SHALL NOT BE CONSTRUCTED PRIOR TO COMPLETION OF THE BRIDGE DECK.

FOR REINFORCED BRIDGE APPROACH FILL INCLUDING FABRIC, IMPERMEABLE GEOMEMBRANE, 102mm Ø DRAINAGE PIPE, #78M STONE, AND SELECT MATERIAL, SEE ROADWAY PLANS.

TEMPORARY DRAINAGE AND TEMPORARY BERM AND SLOPE DRAINS WILL BE PAID FOR UNDER THE LUMP SUM PRICE FOR BRIDGE APPROACH SLAB.

AREA BETWEEN THE WINGWALL AND APPROACH SLAB SHALL BE GRADED TO DRAIN THE WATER AWAY FROM THE FILL FACE OF THE BRIDGE AND SHALL BE PAVED. SEE ROADWAY PLANS.

THE 150mm COMP. A.B.C. SHALL EXTEND 3m BEYOND THE END OF THE APPROACH SLAB AND 300mm OUTSIDE OF EACH EDGE OF THE SLAB.

THE CONTRACTOR MAY USE 100mm TYPE B-25.0B ASPHALT CONCRETE COURSE IN LIEU OF 150mm COMP. A.B.C. IF THIS OPTION IS USED, THE BASE COURSE SHALL EXTEND 300mm BEYOND THE END OF THE APPROACH SLAB AND THE WIDTH SHALL BE THE SAME AS THAT OF THE APPROACH SLAB.

THE CONTRACTOR MAY USE 125mm CLASS "A" CONCRETE BASE IN LIEU OF 150mm COMP. A.B.C. IF THIS OPTION IS USED, THE CONCRETE BASE SHALL EXTEND 300mm BEYOND THE END OF THE APPROACH SLAB AND THE WIDTH SHALL BE THE SAME AS THAT OF THE APPROACH SLAB. THE CONCRETE SHALL BE FINISHED TO A SMOOTH SURFACE AND A LAYER OF 13.6 kg. ROOFING FELT SHALL BE PLACED BETWEEN THE CONCRETE BASE AND THE APPROACH SLAB TO PREVENT BOND. THE APPROACH SLAB SHALL NOT BE CAST UNTIL THE CONCRETE BASE HAS REACHED AN AGE OF THREE CURING DAYS.

THE JOINT SHALL BE SAWS PRIOR TO THE CASTING OF THE CLASSIC CONCRETE BRIDGE RAIL AND SIDEWALK.

APPROACH SLAB GROOVING IS NOT REQUIRED. TINE CONCRETE ONLY WITHIN THE LIMITS OF THE ASPHALT PAVEMENT AND IN ACCORDANCE WITH ARTICLE 422-3 OF THE STANDARD SPECIFICATIONS.

WITH EVAZOTE JOINT SEAL

FOR EVAZOTE JOINT SEALS, SEE SPECIAL PROVISIONS.

THE NOMINAL UNCOMPRESSED SEAL WIDTH OF THE EVAZOTE JOINT SEAL SHALL BE 64mm.

FOR ELASTOMERIC CONCRETE, SEE SPECIAL PROVISIONS.

THE COST OF THE ELASTOMERIC CONCRETE WILL BE INCLUDED IN THE PAY ITEM FOR "EVAZOTE JOINT SEALS."

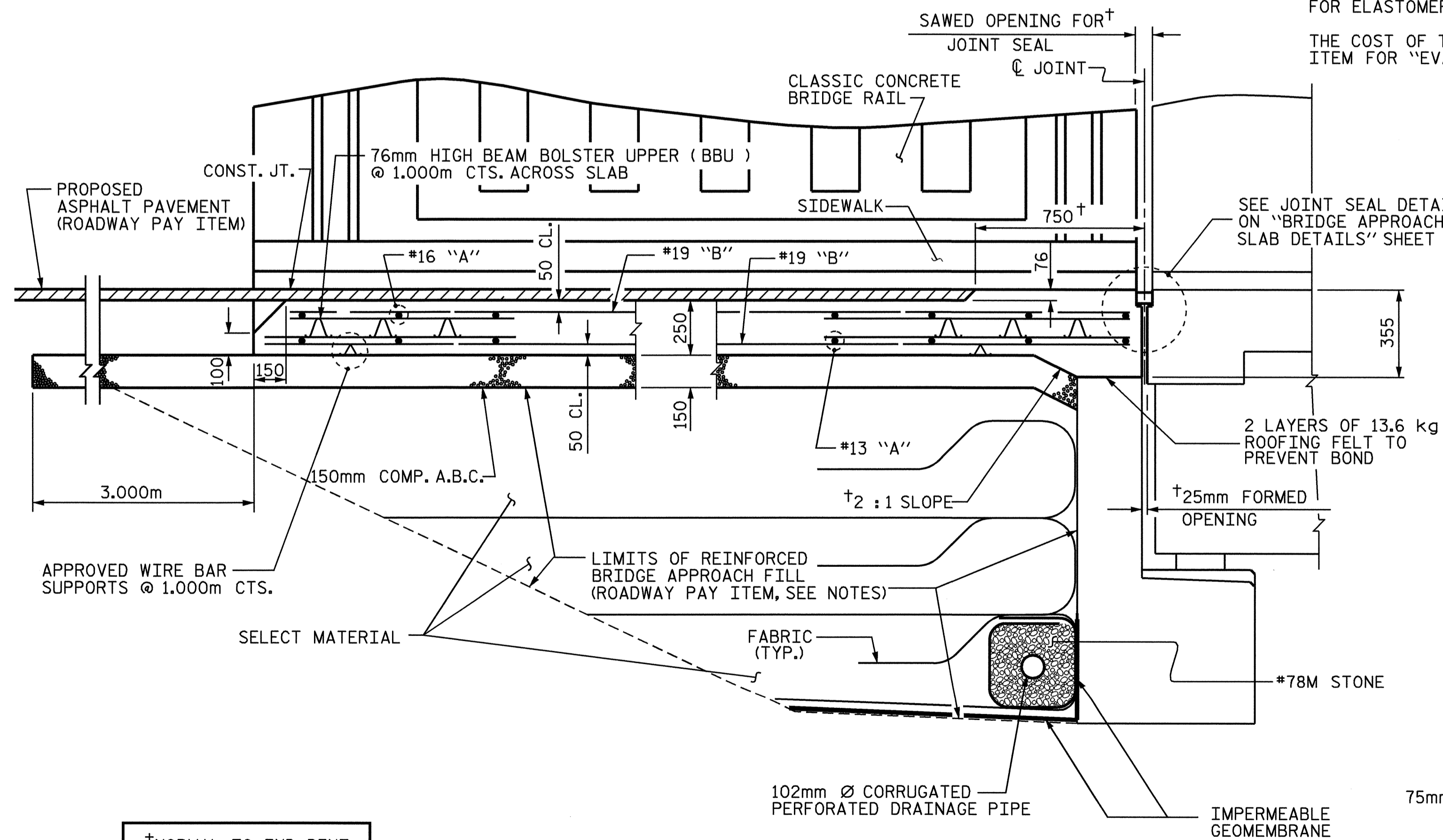

**SECTION THRU SLAB**

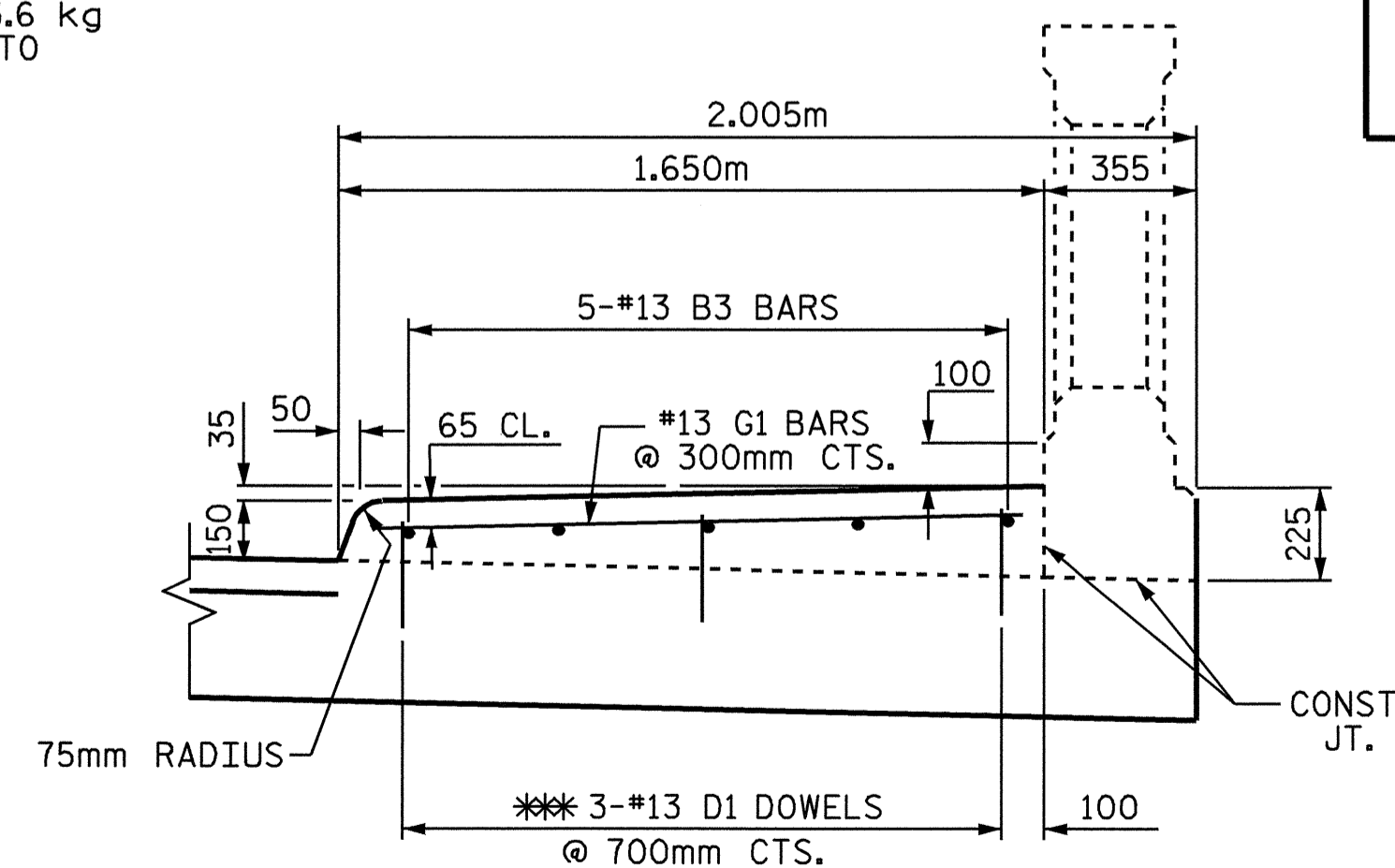

**SECTION THRU SIDEWALK**

\*\*\* DOWELS MAY BE PUSHED INTO GREEN CONCRETE AFTER SPAN HAS BEEN SCREEDED OFF.

**BILL OF MATERIAL**

APPROACH SLAB @ END BENT 1						APPROACH SLAB @ END BENT 2					
BAR	NO.	SIZE	TYPE	LENGTH	WEIGHT	BAR	NO.	SIZE	TYPE	LENGTH	WEIGHT
*A1	24	#16	STR	12300	458	*A3	48	#16	STR	8320	620
A2	18	#13	STR	6440	115	A4	18	#13	STR	8200	147
*B1	82	#19	STR	3420	627	*B1	106	#19	STR	3420	810
B2	82	#19	STR	3560	652	B2	106	#19	STR	3560	843
*B3	10	#13	STR	3560	35	*B3	10	#13	STR	3560	35
*B4	8	#16	STR	3560	44	*B4	8	#16	STR	3560	44
*B5	4	#22	STR	3560	43	*B5	4	#22	STR	3560	43
*D1	12	#13	STR	260	3	*D1	12	#13	STR	260	3
*G1	24	#13	STR	1540	37	*G1	24	#13	STR	1540	37
*S1	34	#16	1	2600	137	H1	4	#13	STR	2000	8
*S6	34	#16	2	1460	77	H2	8	#13	STR	1120	9
						*S1	34	#16	1	2600	137
						*S6	34	#16	2	1460	77
REINFORCING STEEL kg. 767						REINFORCING STEEL kg. 1007					
*EPOXY COATED REINFORCING STEEL kg. 1461						*EPOXY COATED REINFORCING STEEL kg. 1806					
CLASS AA CONCRETE BREAKDOWN						CLASS AA CONCRETE BREAKDOWN					
SLAB			C. M.	12.1		SLAB			C. M.	15.3	
SIDEWALK			C. M.	2.1		SIDEWALK			C. M.	2.1	
RAIL			C. M.	2.4		RAIL			C. M.	2.6	
						FOOTING SUPPORT			C. M.	0.5	
CLASS AA CONCRETE			C. M.	16.6		CLASS AA CONCRETE			C. M.	20.5	

**BAR TYPES**

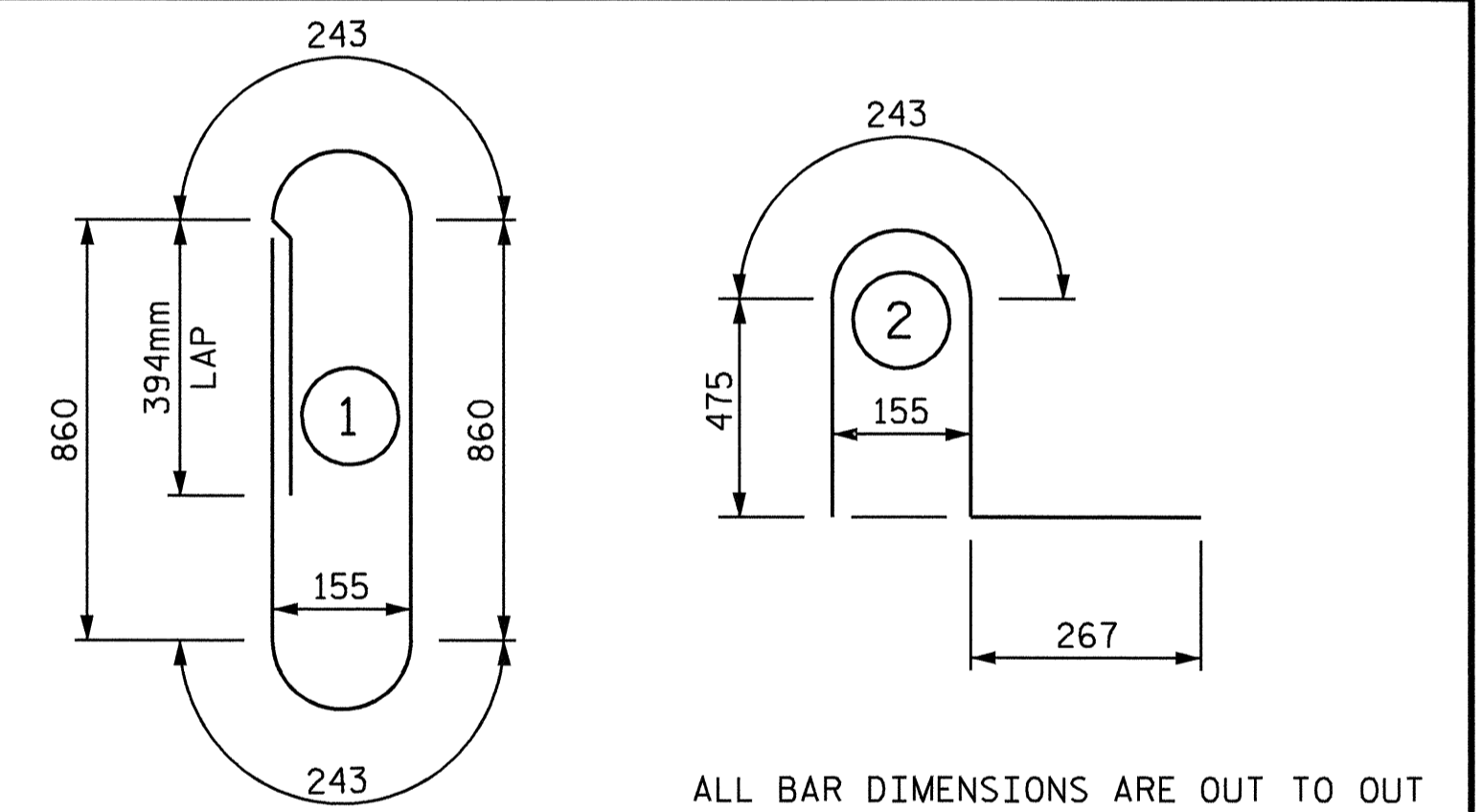

ALL BAR DIMENSIONS ARE OUT TO OUT

**SPLICE LENGTH CHART**

BAR	SIZE	SPLICE LENGTH
A2, A4	13	540
A3	16	770

PROJECT NO. B-2583  
MADISON COUNTY  
 STATION: 11+03.000 -Y1-

SHEET 1 OF 4

STATE OF NORTH CAROLINA  
 DEPARTMENT OF TRANSPORTATION  
 RALEIGH  
 STANDARD  
 BRIDGE APPROACH SLAB  
 FOR FLEXIBLE PAVEMENT  
 WITH CLASSIC CONCRETE  
 BRIDGE RAIL



REVISIONS						SHEET NO.
NO.	BY:	DATE:	NO.	BY:	DATE:	S-106
1			3			TOTAL SHEETS
2			4			112

ASSEMBLED BY : T.A. HARRIS	DATE : 6/22/04
CHECKED BY : W. S. ARAFAT	DATE : 7/9/04
DRAWN BY : RWW	8/01
CHECKED BY : LES	8/01
ADDED 12/01	REV. 5/7/03
RWW/JTE	