

5/28/99

PROJECT REFERENCE NO. 1-2102	SHEET NO. 17
ROADWAY DESIGN ENGINEER	HYDRAULICS ENGINEER
	
<i>Elyne Ambrose</i>	<i>Paul A. Fisher</i>

Notes:  
 (1) SEE SHEET 5, SHEET 7, SHEET 8 FOR PLAN VIEW OF Y4

-Y4-

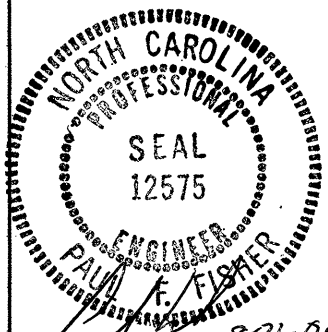
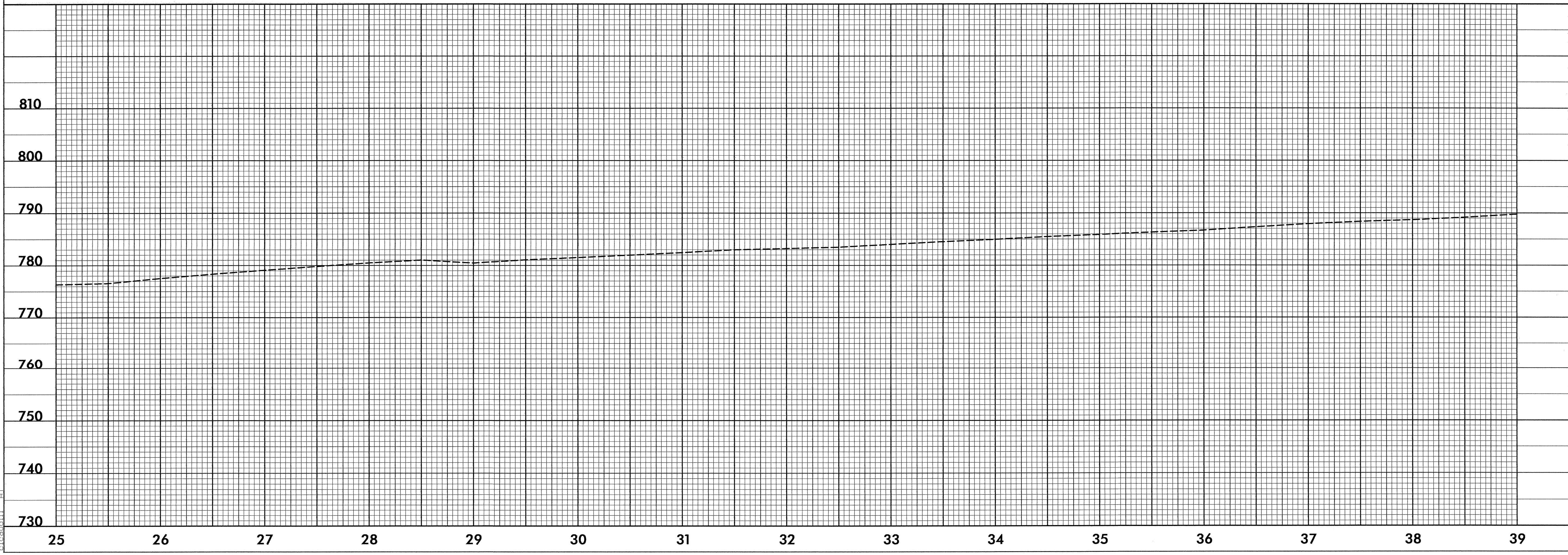
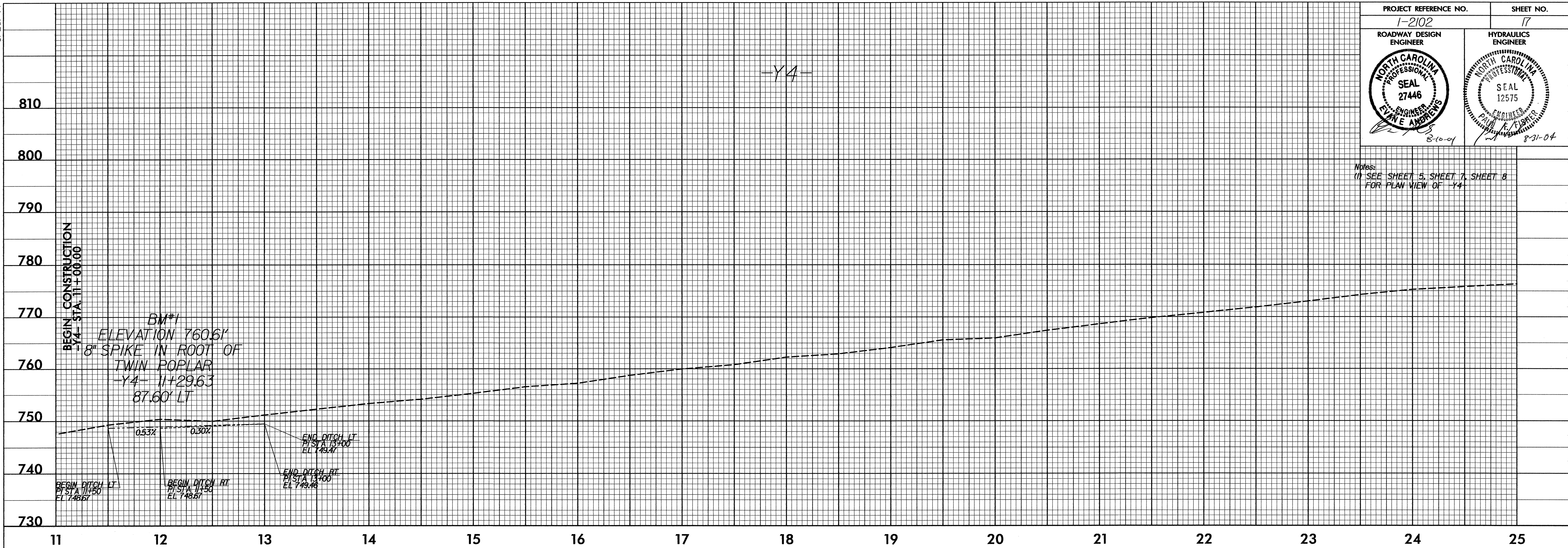

09-AUG-2004 11:21  
 R:\2102\140.PFL  
 E:\caughill AT