

TIP NO.	SHEET NO.
I-2102	SIGN-9

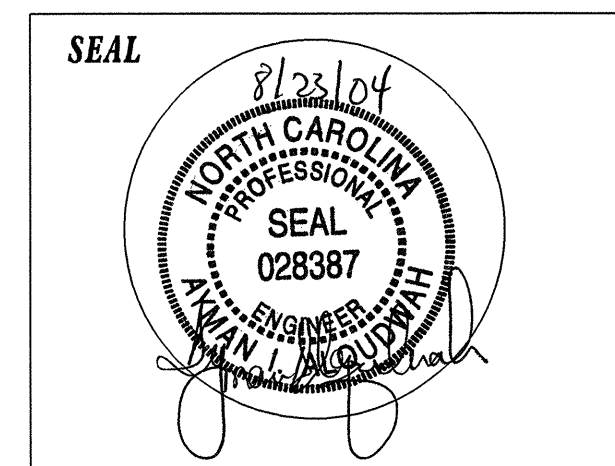

**EXISTING/PROPOSED SIGNS
STA 19+50 TO STA 10+00
-Y4- ROUTE DESCRIPTION**

SCALE	NONE
DATE	06-09-04
DESIGN BY	K. Fowler
REVIEWED BY	K. Jordan
APPROVED BY	A. Alquodwah, P.E.

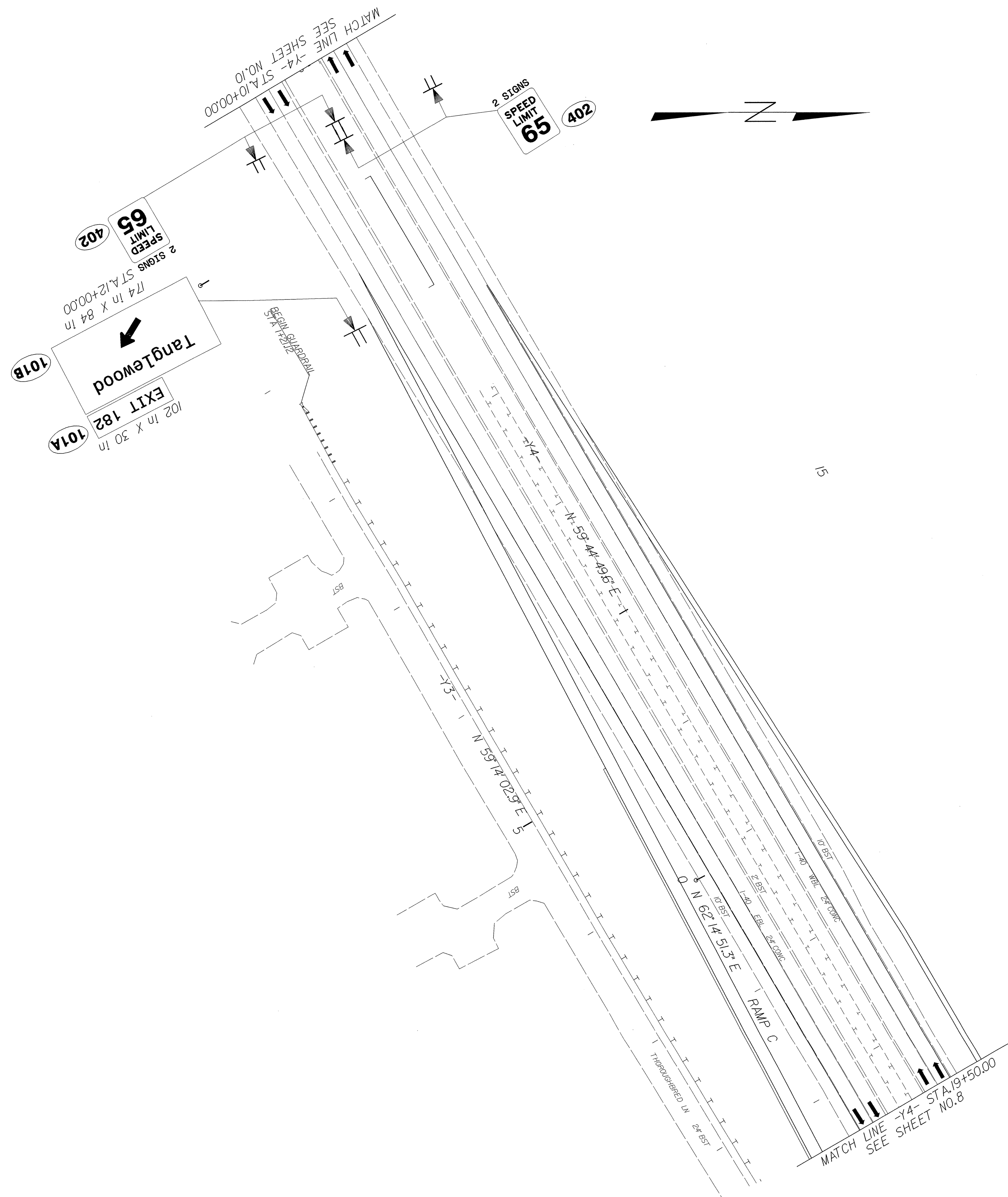
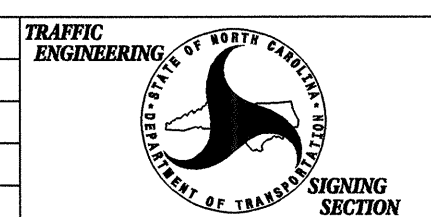

REVISIONS	