

5/14/99
11/02/2004 PM
03:46:55
R-2237B

NOTE:
DESIGN EXCEPTION REQUIRED FOR MAX.GRADE
STA.-L- 168+10 TO STA.-L- 208+20
REFERENCE: FOR PLAN VIEW SEE
PLAN SHEET 17

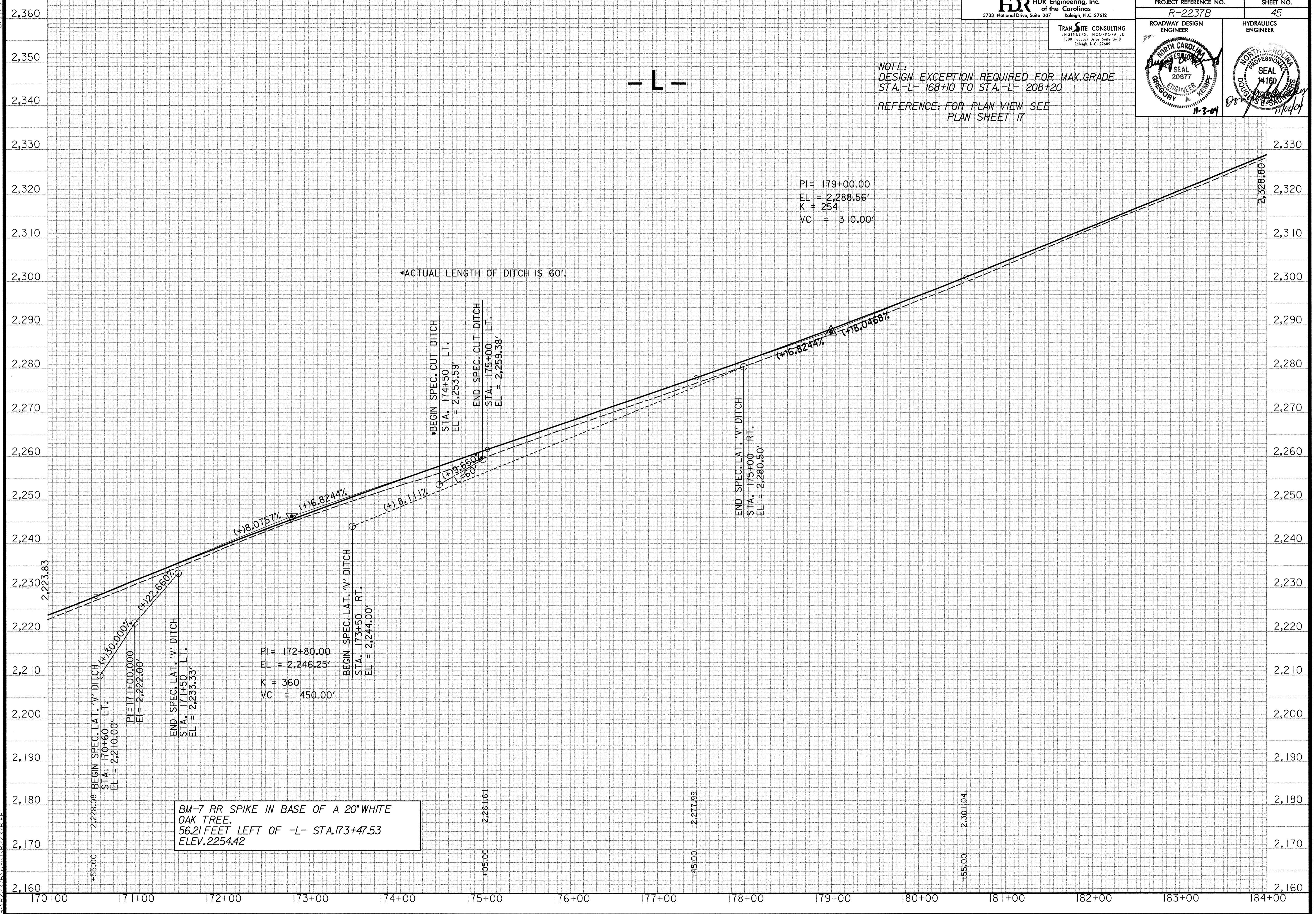

BM-7 RR SPIKE IN BASE OF A 20' WHITE
OAK TREE.
56.21 FEET LEFT OF -L- STA.173+47.53
ELEV.2254.42