

5/14/99

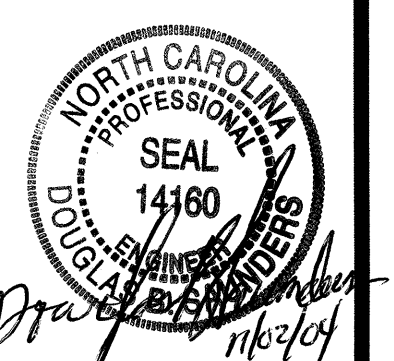
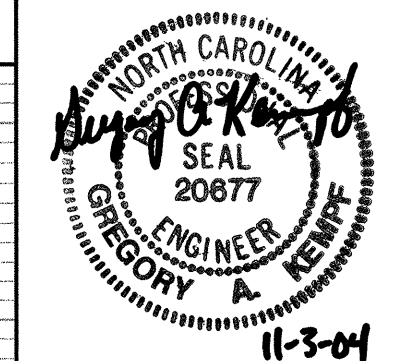

NOTE:
 DESIGN EXCEPTION REQUIRED FOR MAX.GRADE
 STA. -L- 168+10 TO STA. -L- 208+20

REFERENCE: FOR PLAN VIEW SEE
 PLAN SHEET 18

- L -

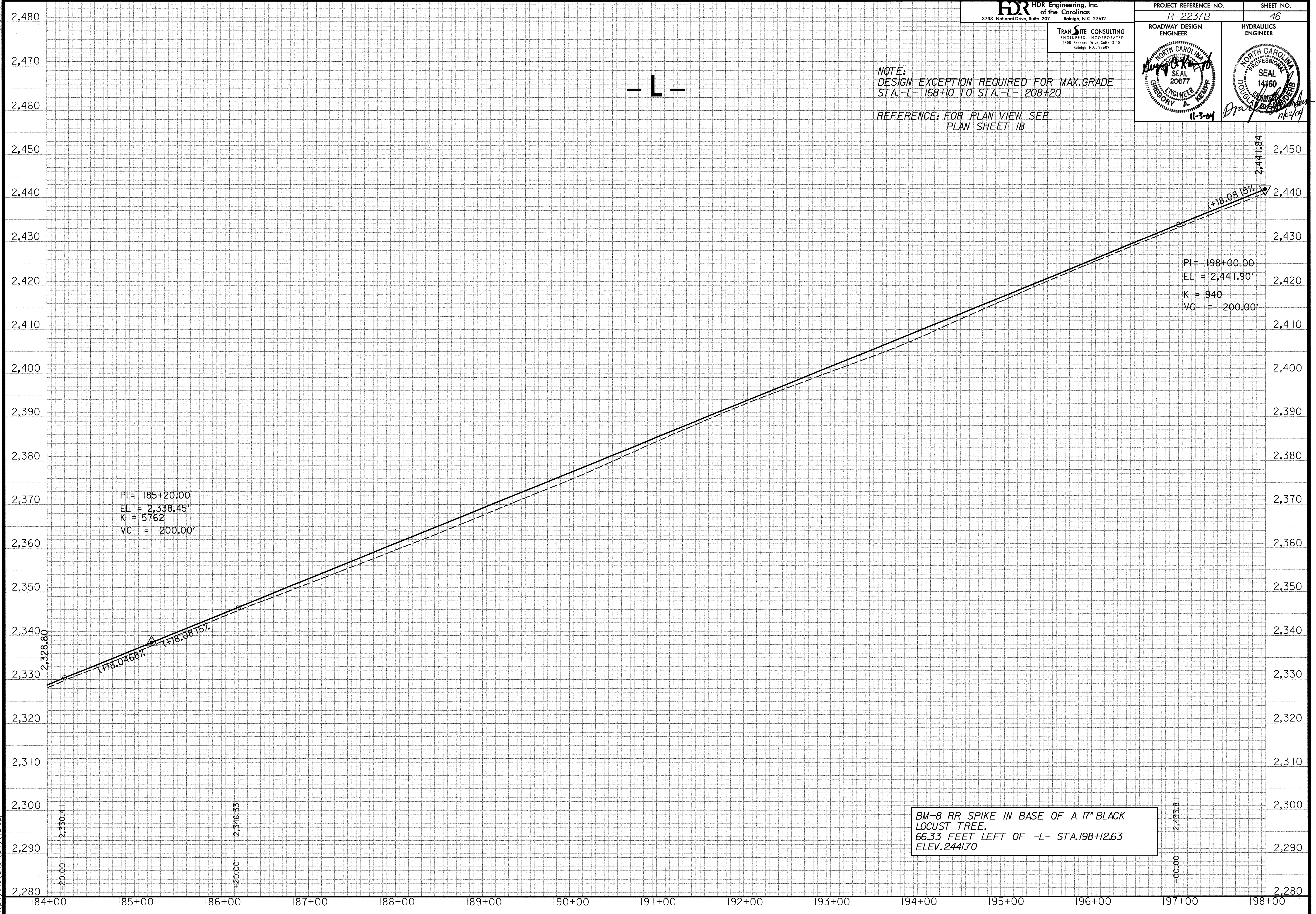

PI = 185+20.00
 EL = 2,338.45'
 K = 5762
 VC = 200.00'

PI = 198+00.00
 EL = 2,441.90'
 K = 940
 VC = 200.00'

BM-8 RR SPIKE IN BASE OF A 17" BLACK
 LOCUST TREE.
 66.33 FEET LEFT OF -L- STA.198+12.63
 ELEV.2441.70

11/02/2004
 10:24:26 PM
 R:\R2237B\Drawings\182237B.PEF