

BM-II RR SPIKE IN BASE OF A 29" SUGAR MAPLE TREE.
37.12 FEET LEFT OF -L- STA. 271+54.99
ELEV. 2673.63

NOTE:
DESIGN EXCEPTION REQUIRED FOR MAX. GRADE
STA. -L- 262+00 TO STA. -L- 267+70
REFERENCE: FOR PLAN VIEW SEE
PLAN SHEET 24

- L -

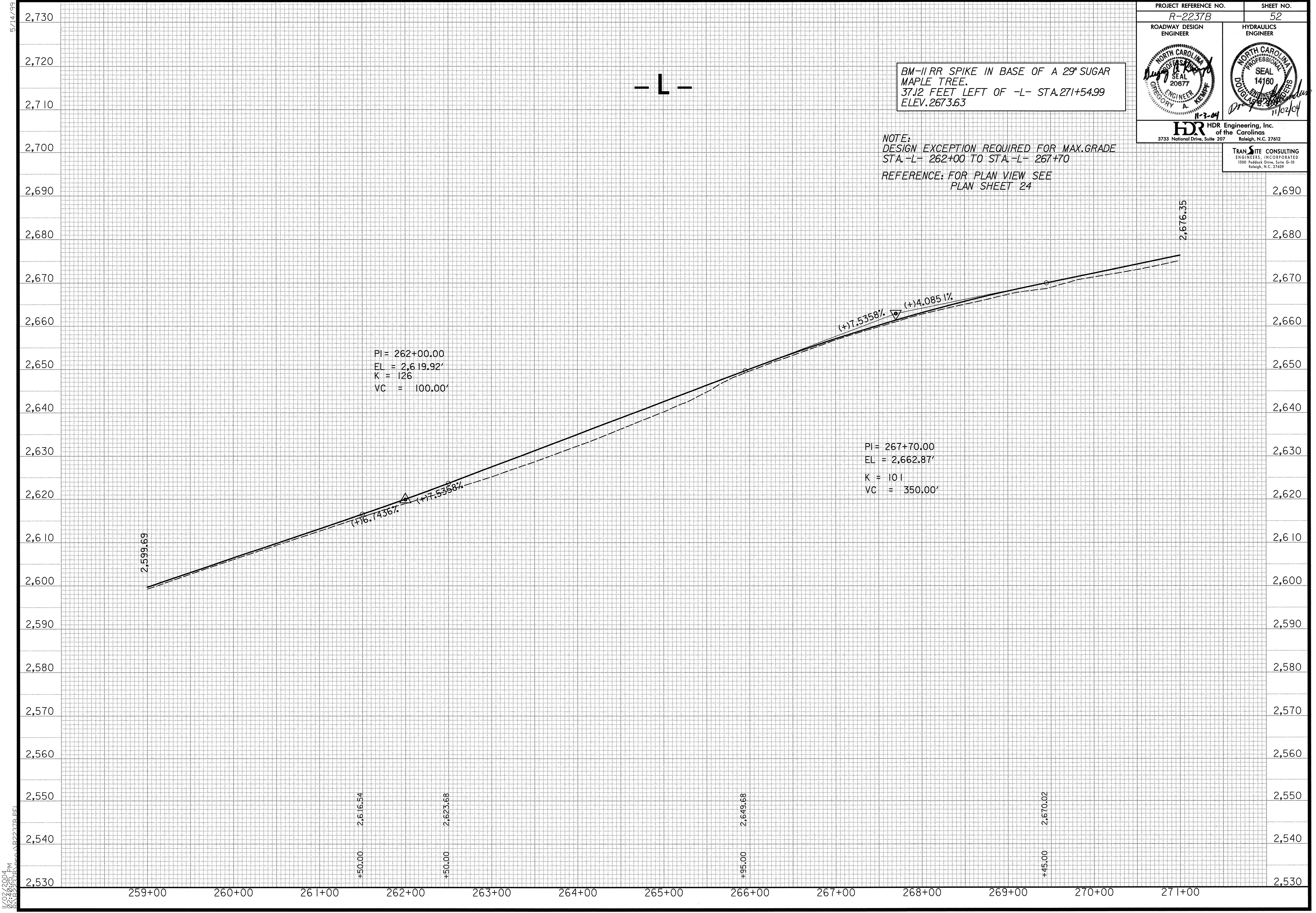

5/14/99

11/02/2004
2:24:26 PM
R:\2237B\Drawings\2237B-PE1