

PROJECT REFERENCE NO.		SHEET NO.	
R-2237B		EC-40/CONST II	
RW SHEET NO.			
ROADWAY DESIGN ENGINEER		HYDRAULICS ENGINEER	
42104	ADDED PLUS AND DISTANCES AND EIP'S		

-L-	-L-
CURVE LR6	CURVE LR7
PI = 87+86.86	PI = 103+92.34
Δ = 18° 54' 31.0" (LT)	Δ = 18° 05' 12.2" (LT)
Dc = 2' 00" 00.0"	Dc = 2' 00" 00.0"
Θ_s = 1' 30' 00.0"	Θ_s = 1' 30' 00.0"
Ls = 150.00'	Ls = 150.00'
Ts = 552.11'	Ts = 531.01'
Lc = 795.43'	Lc = 754.34'
Rc = 2,864.79'	Rc = 2,864.79'
LT = 100.00'	LT = 100.00'
ST = 50.00'	ST = 50.00'
e = 0.04	e = 0.04
DS = 50 mph	DS = 50 mph

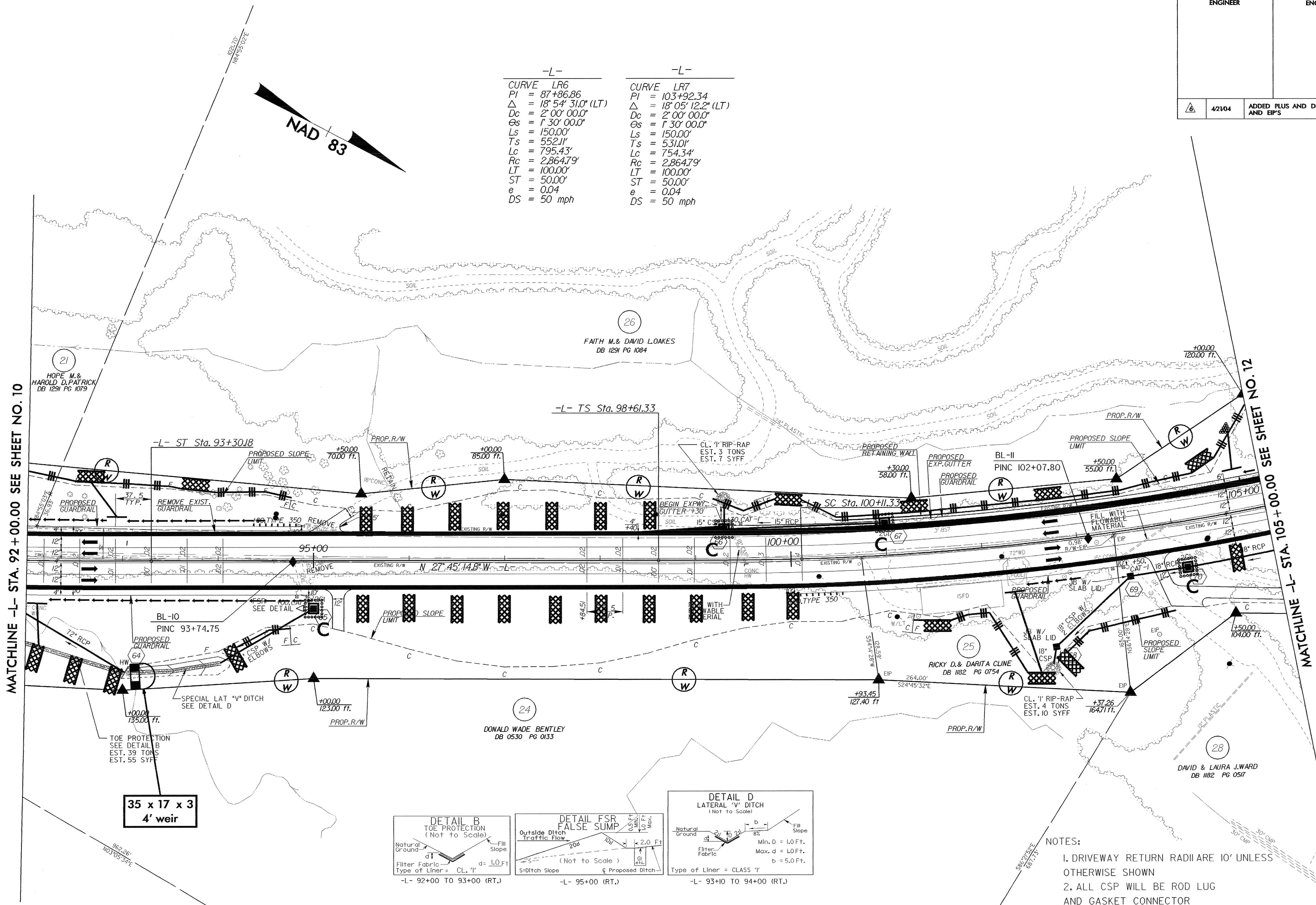

MATCHLINE -L- STA. 92+00.00 SEE SHEET NO. 10

MATCHLINE -L- STA. 105+00.00 SEE SHEET NO. 12

**35 x 17 x 3
4' weir**

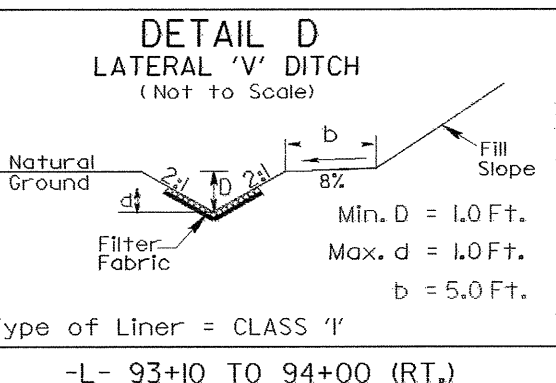
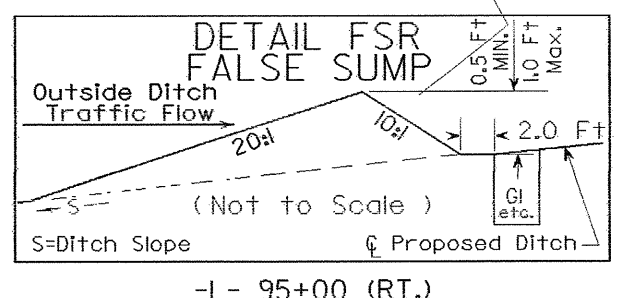
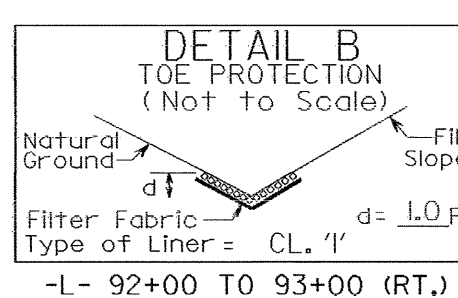

NOTES:
 1. DRIVEWAY RETURN RADII ARE 10' UNLESS OTHERWISE SHOWN
 2. ALL CSP WILL BE ROD LUG AND GASKET CONNECTOR

REFERENCES:
 FOR -L- PROFILE SEE SHEET 39