

PROJECT REFERENCE NO. R-2237B	SHEET NO. EC-41/CONST 12
RW SHEET NO.	
ROADWAY DESIGN ENGINEER	HYDRAULICS ENGINEER

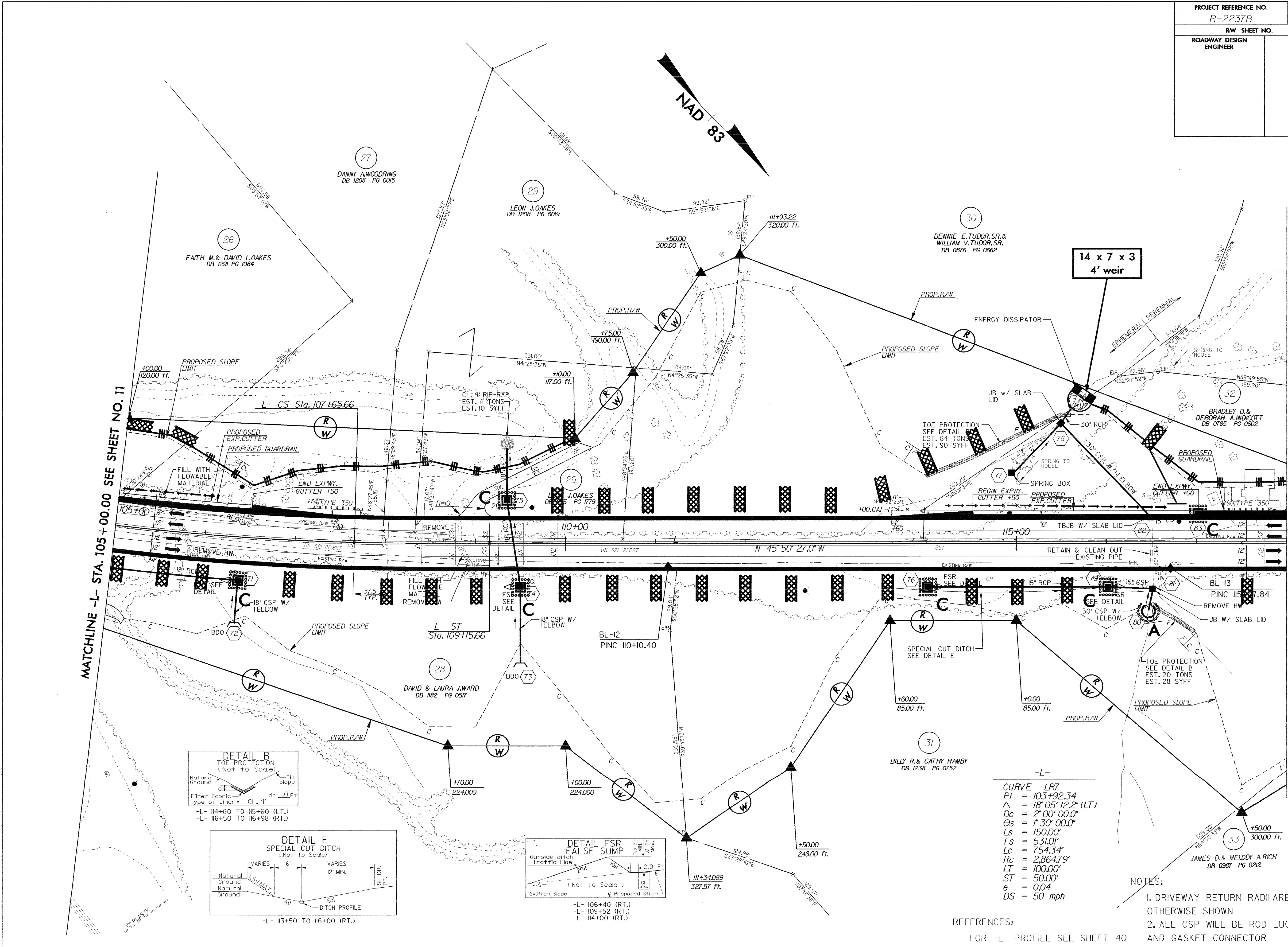

MATCHLINE -L- STA. 105+00.00 SEE SHEET NO. 11

MATCHLINE -L- STA. 118+00.00 SEE SHEET NO. 13

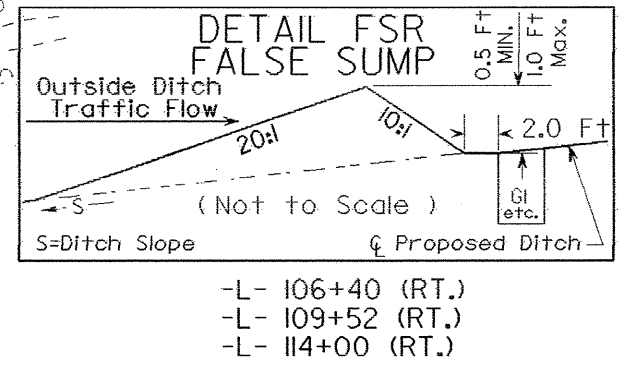
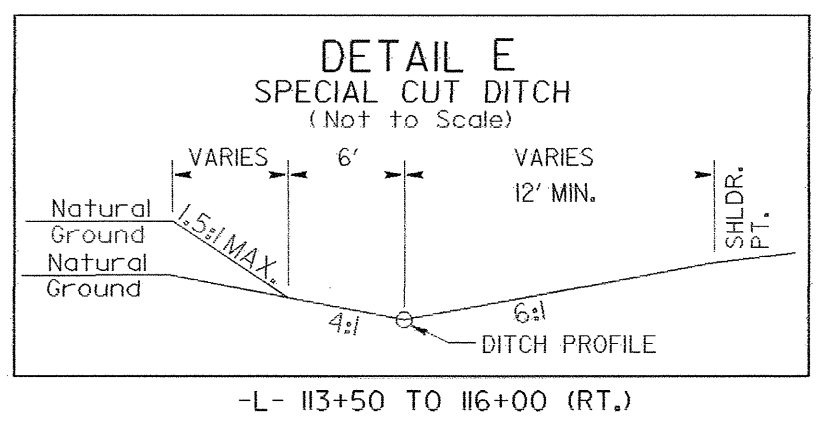
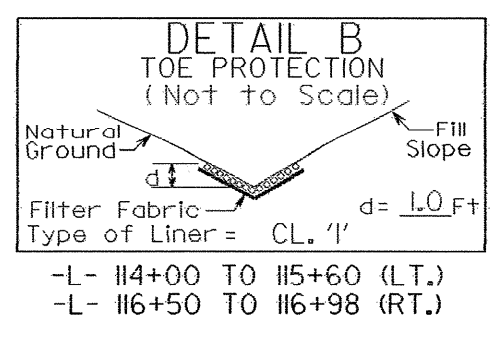

-L-  
CURVE LR7  
PI = 103+92.34  
 $\Delta$  = 18° 05' 12.2" (LT.)  
Dc = 2' 00" 00.0"  
Ds = 1' 30" 00.0"  
Ls = 150.00'  
Ts = 531.01'  
Lc = 754.34'  
Rc = 2,864.79'  
LT = 100.00'  
ST = 50.00'  
e = 0.04  
DS = 50 mph

REFERENCES:  
FOR -L- PROFILE SEE SHEET 40

NOTES:  
1. DRIVEWAY RETURN RADII ARE 10' UNLESS OTHERWISE SHOWN  
2. ALL CSP WILL BE ROD LUG AND GASKET CONNECTOR