

MATCHLINE -L- STA. 132+00.00 SEE SHEET NO. 13

MATCHLINE -L- STA. 145+00.00 SEE SHEET NO. 15

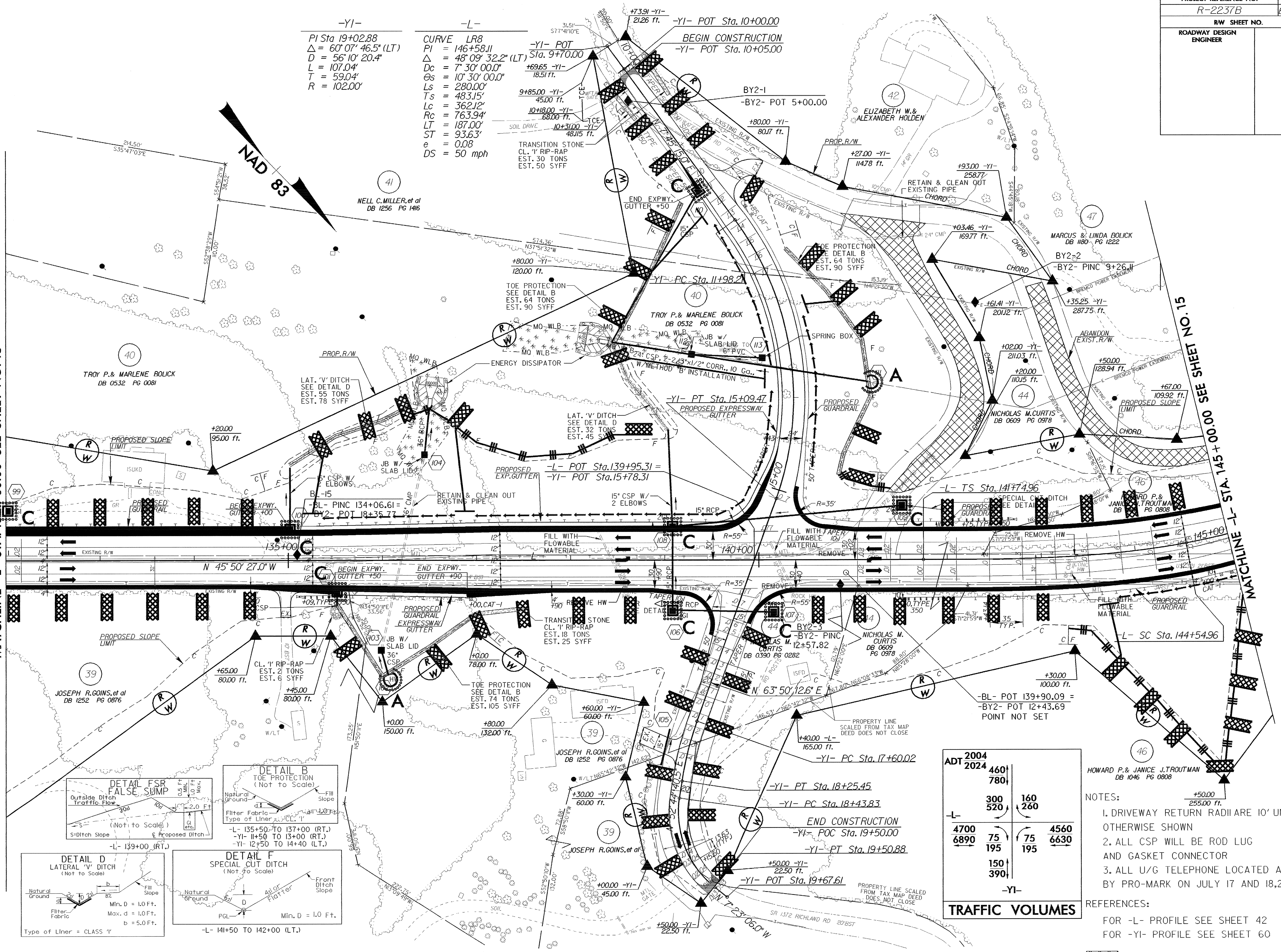

-YI-
 PI Sta 19+02.88
 $\Delta = 60^{\circ}07'46.5''$ (LT)
 $D = 56^{\circ}10'20.4''$
 $L = 107.04'$
 $T = 59.04'$
 $R = 102.00'$

-L-
 CURVE LR8
 PI = 146+58.11
 $\Delta = 48^{\circ}09'32.2''$ (LT)
 $Dc = 7^{\circ}30'00.0''$
 $\Theta_s = 10^{\circ}30'00.0''$
 $Ls = 280.00'$
 $Ts = 483.15'$
 $Lc = 362.12'$
 $Rc = 763.94'$
 $LT = 187.00'$
 $ST = 93.63'$
 $e = 0.08$
 $DS = 50$ mph

ADT 2004			
2024			
460	780	160	260
300	520	75	195
4700	6890	75	195
150	390	75	195
-YI-			
4560			
6630			

TRAFFIC VOLUMES

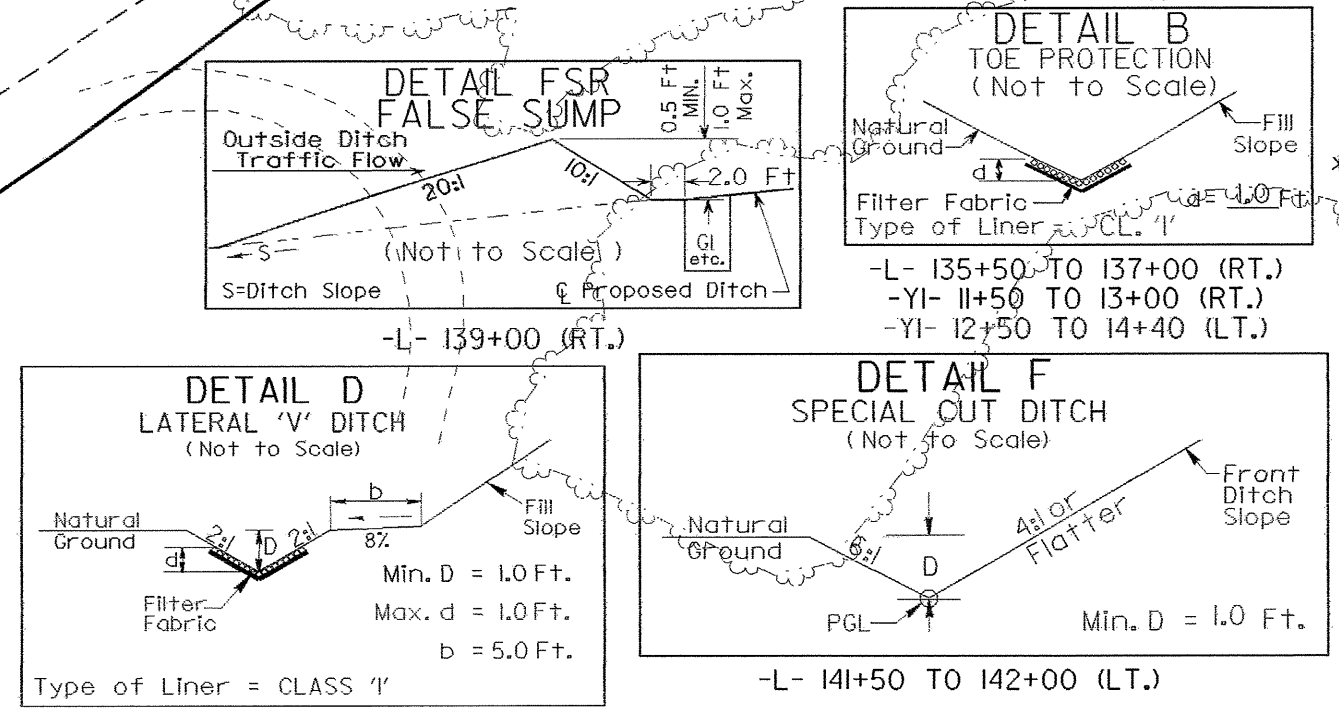

- NOTES:**
- DRIVEWAY RETURN RADII ARE 10' UNLESS OTHERWISE SHOWN
 - ALL CSP WILL BE ROD LUG AND GASKET CONNECTOR
 - ALL U/G TELEPHONE LOCATED AS MARKED BY PRO-MARK ON JULY 17 AND 18, 2000
- REFERENCES:**
- FOR -L- PROFILE SEE SHEET 42
 - FOR -YI- PROFILE SEE SHEET 60

ROADWAY TO BE OBLITERATED