

PROJECT REFERENCE NO.	SHEET NO.
R-2237B	EC-57/CONST 28
RW SHEET NO.	
ROADWAY DESIGN ENGINEER	HYDRAULICS ENGINEER

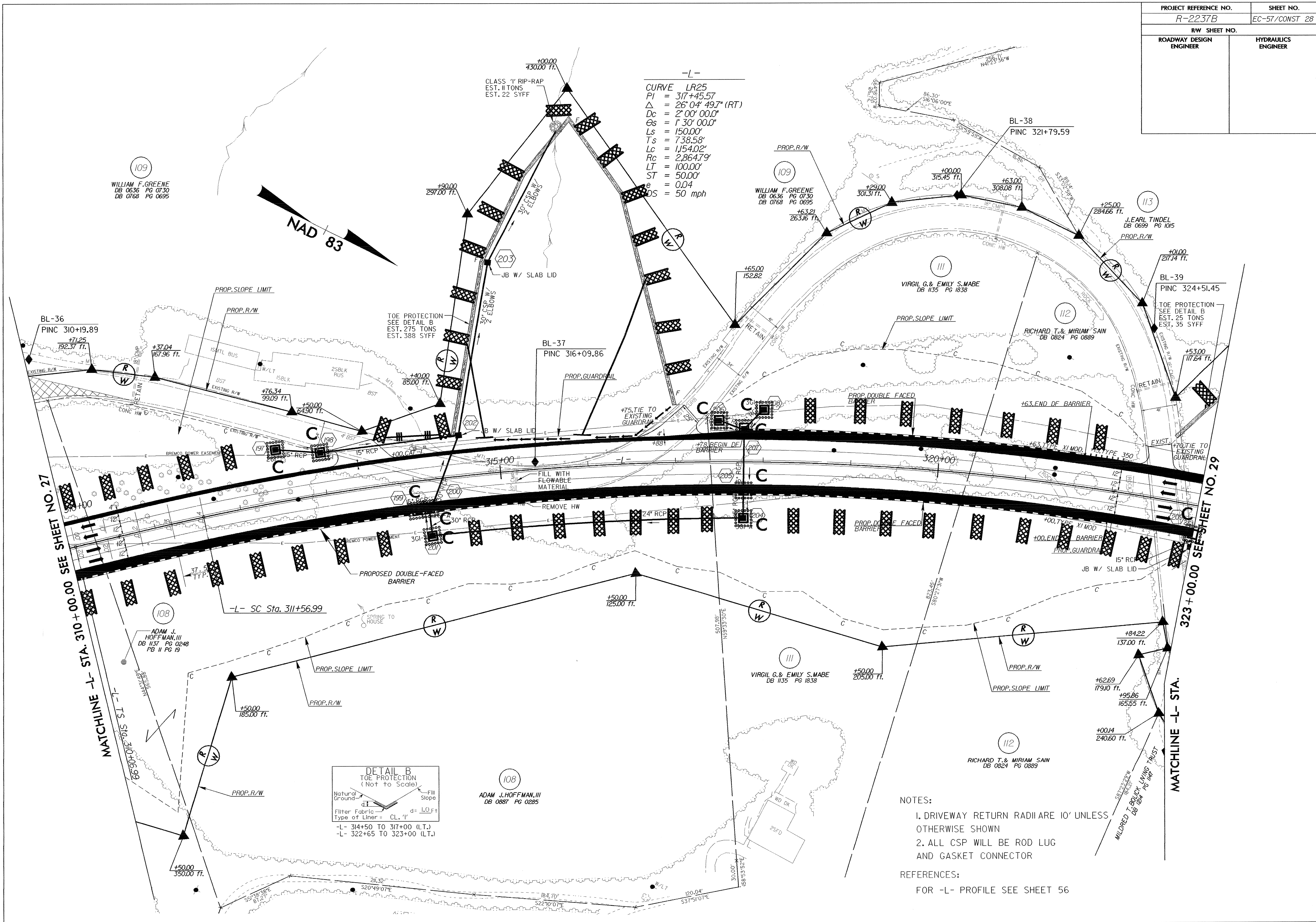

-L-
 CURVE LR25
 PI = 317+45.57
 $\Delta = 26^{\circ}04'49.7''$ (RT)
 $D_c = 2^{\circ}00'00.0''$
 $\Theta_s = 1^{\circ}30'00.0''$
 $L_s = 150.00'$
 $T_s = 738.58'$
 $L_c = 1154.02'$
 $R_c = 2,864.79'$
 $LT = 100.00'$
 $ST = 50.00'$
 $e = 0.04$
 $OS = 50$ mph

109
 WILLIAM F. GREENE
 DB 0636 PG 0730
 DB 0768 PG 0695

109
 WILLIAM F. GREENE
 DB 0636 PG 0730
 DB 0768 PG 0695

113
 J. EARL TINDEL
 DB 0699 PG 1015

111
 VIRGIL G. & EMILY S. MABE
 DB 1135 PG 1838

112
 RICHARD T. & MIRIAM SAIN
 DB 0824 PG 0889

108
 ADAM J. HOFFMAN, III
 DB 1137 PG 0248
 PB II PG 19

108
 ADAM J. HOFFMAN, III
 DB 0887 PG 0285

112
 RICHARD T. & MIRIAM SAIN
 DB 0824 PG 0889

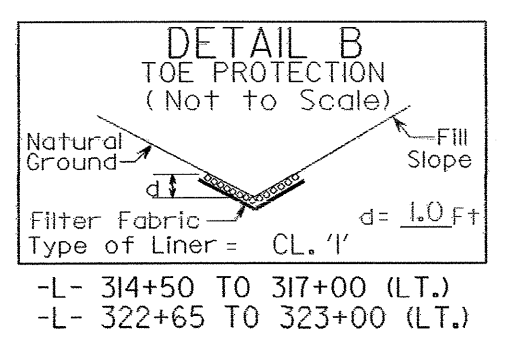

- NOTES:
1. DRIVEWAY RETURN RADII ARE 10' UNLESS OTHERWISE SHOWN
 2. ALL CSP WILL BE ROD LUG AND GASKET CONNECTOR

REFERENCES:
 FOR -L- PROFILE SEE SHEET 56

MATCHLINE -L- STA. 310+00.00 SEE SHEET NO. 27

MATCHLINE -L- STA. 323+00.00 SEE SHEET NO. 29