

CONST. REV.
R/W REV.

| | | | |
|---------------------------------|--|-----------------|--|
| PROJECT REFERENCE NO. R2562D | | SHEET NO. 17 | |
| ROADWAY DESIGN ENGINEER | | | |
| HYDRAULICS ENGINEER | | | |
| | | | |
| 10/12/04 | | | |

WETHERILL ENGINEERING
559 Jones Franklin Rd. Suite 164
Raleigh, N.C. 27606
Bus: 919-851-8077 Fax: 919-851-8107

TRANSPORTATION PLANNING/DESIGN - BRIDGE/STRUCTURE DESIGN
CIVIL/SITE DESIGN - GIS/GPS - CONSTRUCTION OBSERVATION

KCI Associates of North Carolina, P.A.
SUITE 200, LANDMARK CENTER I, 4601 SIX FORKS RD.
RALEIGH, NC 27609-5210 (919) 783-9244
ENGINEERS • PLANNERS • ECOLOGISTS

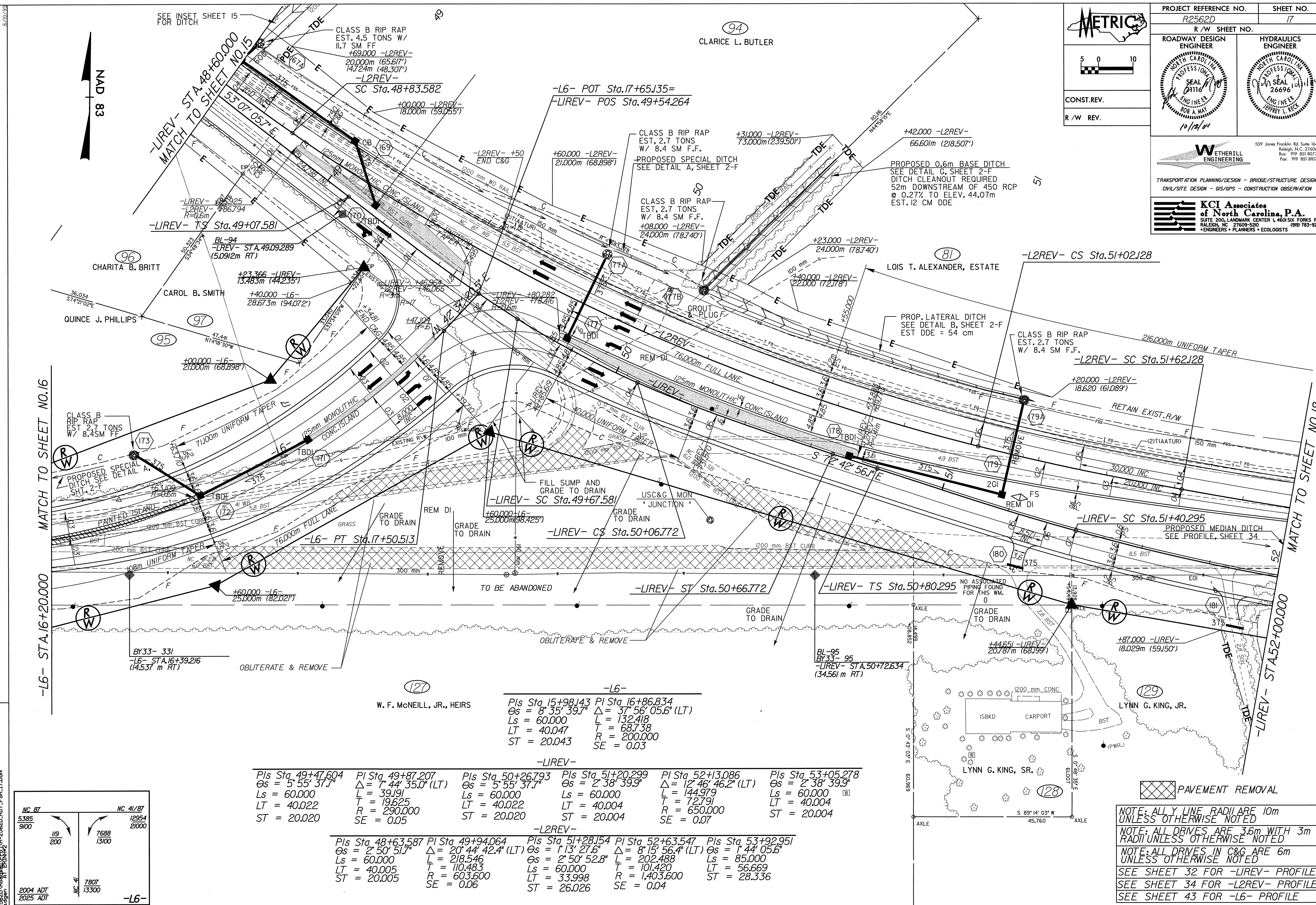

MATCH TO SHEET NO.16
-L6- STA.16+20.000

MATCH TO SHEET NO.18
-LIREV- STA.52+00.000

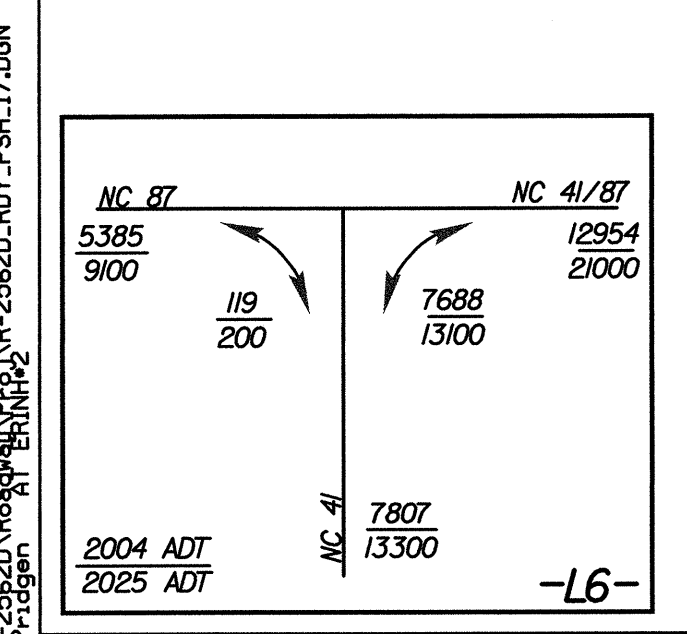

| | | | | | |
|--|--|--|--|--|--|
| -L6- Pls Sta. 15+98.143 PI Sta. 16+86.834 Os = 8' 35' 39.7" Δ = 37' 56' 05.6" (LT) Ls = 60.000 L = 132.418 LT = 40.047 T = 68.738 ST = 20.043 SE = 0.03 | | | | | |
| -LIREV- Pls Sta. 49+47.604 PI Sta. 49+87.207 Os = 5' 55' 37.7" Δ = 7' 44' 35.0" (LT) Ls = 60.000 L = 39.191 LT = 40.022 T = 19.625 ST = 20.020 SE = 0.05 | | Pls Sta. 50+26.793 PI Sta. 51+20.299 Os = 5' 55' 37.7" Δ = 2' 38' 39.9" Ls = 60.000 L = 60.000 LT = 40.022 T = 40.004 ST = 20.020 SE = 0.07 | | Pls Sta. 51+20.299 PI Sta. 52+13.086 Os = 2' 38' 39.9" Δ = 12' 46' 46.2" (LT) Ls = 60.000 L = 144.979 LT = 40.004 T = 72.791 ST = 20.004 SE = 0.07 | |
| Pls Sta. 48+63.587 PI Sta. 49+94.064 Os = 2' 50' 51.7" Δ = 20' 44' 42.4" (LT) Ls = 60.000 L = 218.546 LT = 40.005 T = 110.483 ST = 20.005 SE = 0.06 | | Pls Sta. 51+28.154 PI Sta. 52+63.547 Os = 1' 13' 27.6" Δ = 8' 15' 56.4" (LT) Ls = 60.000 L = 202.488 LT = 33.998 T = 101.420 ST = 26.026 SE = 0.04 | | Pls Sta. 53+92.951 Os = 1' 44' 05.5" Δ = 8' 15' 56.4" (LT) Ls = 85.000 L = 56.669 ST = 28.336 SE = 0.04 | |

PAVEMENT REMOVAL

NOTE: ALL Y LINE RADII ARE 10m UNLESS OTHERWISE NOTED

NOTE: ALL DRIVES ARE 3.6m WITH 3m RADII UNLESS OTHERWISE NOTED

NOTE: ALL DRIVES IN C&G ARE 6m UNLESS OTHERWISE NOTED

SEE SHEET 32 FOR -LIREV- PROFILE

SEE SHEET 34 FOR -L2REV- PROFILE

SEE SHEET 43 FOR -L6- PROFILE

15-OCT-2004 14:22
 R:\2562D\2562D_R-2562D_P01_P01.L7.DGN
 6/20/04