

**METRIC**

CONST. REV.  
R/W REV.

PROJECT REFERENCE NO. R-2562D	SHEET NO. 28
ROADWAY DESIGN ENGINEER	HYDRAULICS ENGINEER
<b>INCOMPLETE PLANS</b> DO NOT USE FOR R/W ACQUISITION <b>PRELIMINARY PLANS</b> DO NOT USE FOR CONSTRUCTION	

TBM #17 -LREV- STA 20+37.57  
 OFFSET 71889 LT. RR SPIKE SET  
 IN BASE OF 18" COTTONWOOD TREE  
 ELEV. 37.901

**Soil Sample Test Results**

SAMPLE NO.	STATION	OFFSET	DEPTH INTERVAL	AASHTO CLASS.	LL	PI	% BY WEIGHT				% PASSING (SIEVES)			% MOISTURE	% ORGANIC
							CSAND	FSAND	SILT	CLAY	2.0 mm	425 um	75 um		
S-6	22+00	5m RT	0.30-0.80	A-2-4(0)	17	NP	14.9	54.9	13.9	16.2	100	95	34		
S-7	22+00	5m RT	0.80-1.40	A-2-4(0)	17	4	13.3	52.9	11.5	22.2	100	95	35		
S-8	22+00	5m RT	1.40-1.90	A-6(6)	33	17	8.9	35.4	13.3	42.4	100	97	56	25.8	
S-9	23+80	5m LT	0.30-1.40	A-2-4(0)	15	NP	16.2	64.0	9.7	10.1	100	96	21		
S-10	23+80	5m LT	1.40-1.60	A-4(0)	28	NP	8.5	54.9	26.5	10.1	100	97	38		
S-11	23+80	5m LT	1.60-1.90	A-2-4(0)	13	NP	10.3	61.0	16.6	12.1	100	97	30		

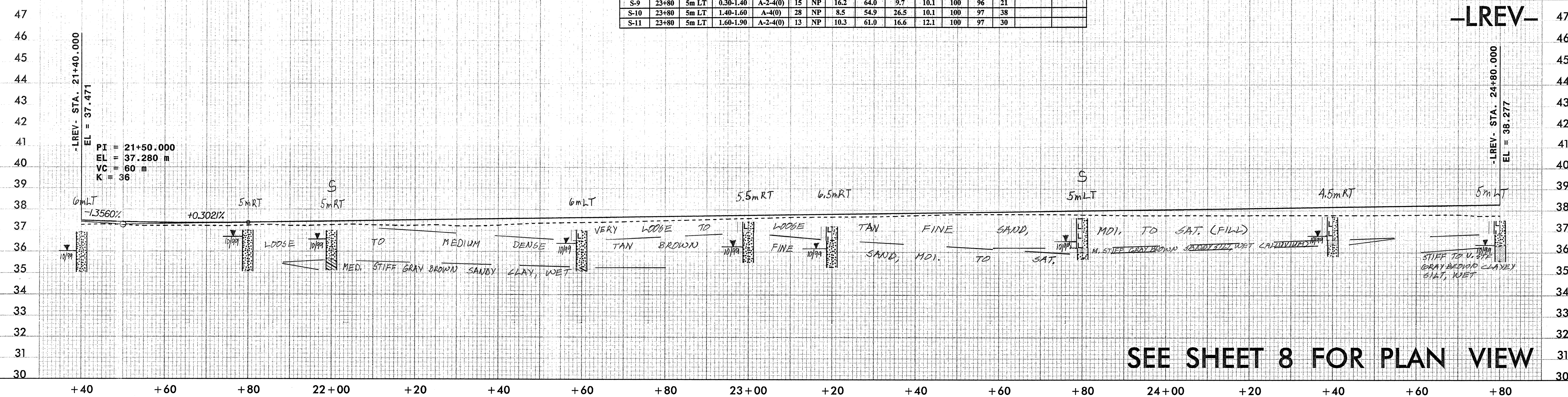

**SEE SHEET 8 FOR PLAN VIEW**

TBM #17 -LREV- STA 20+37.57  
 OFFSET 71889 LT. RR SPIKE SET  
 IN BASE OF 18" COTTONWOOD TREE  
 ELEV. 37.901

**Soil Sample Test Results**

SAMPLE NO.	STATION	OFFSET	DEPTH INTERVAL	AASHTO CLASS.	LL	PI	% BY WEIGHT				% PASSING (SIEVES)			% MOISTURE	% ORGANIC
							CSAND	FSAND	SILT	CLAY	2.0 mm	425 um	75 um		
SS-13	25+00	6.5m LT	0.30-0.45	A-2-4(0)	16	NP	10.7	60.4	10.7	18.2	100	97	30		
SS-14	25+00	6.5m LT	1.52-1.92	A-4(1)	17	6	8.5	27.1	20.0	44.4	100	97	65	18.4	
SS-15	25+00	6.5m LT	2.44-2.74	A-2-4(0)	14	NP	23.6	57.4	4.8	14.1	100	94	19		
S-12	26+80	10m LT	0.30-0.90	A-2-4(0)	22	4	11.7	61.6	4.4	22.2	100	98	27		
S-13	26+80	10m LT	0.90-1.90	A-7-6(31)	66	40	2.2	27.3	16.0	54.5	100	100	75	37.1	
S-14	28+00	8m RT	0.30-1.90	A-2-4(0)	27	9	15.2	51.7	4.8	28.3	100	97	34		

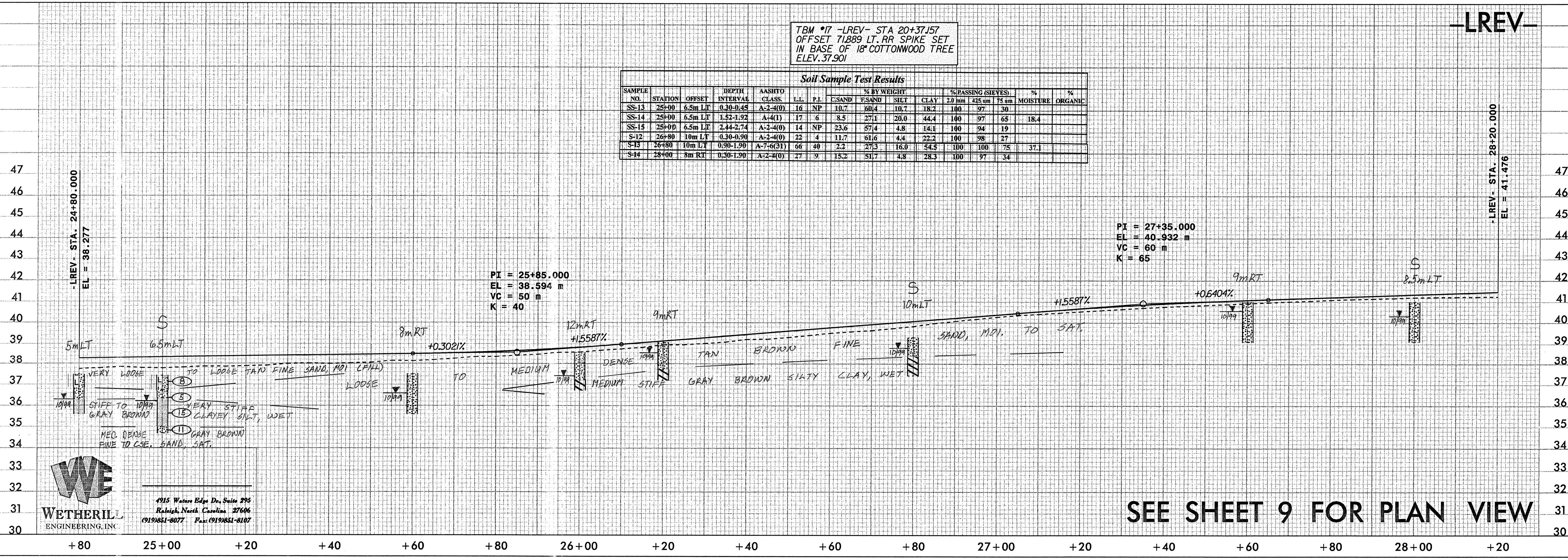

**SEE SHEET 9 FOR PLAN VIEW**

**WE**  
**WETHERILL ENGINEERING, INC.**  
 4915 Waters Edge Dr. Suite 295  
 Raleigh, North Carolina 27606  
 (919)851-8077 Fax: (919)851-8107

6/09/2011  
 15-016-C-1088-1101  
 15-016-C-1088-1101\proj\2562d.rvt