

PROJECT REFERENCE NO. R-2562C		SHEET NO. EC-54/CONST.22	
R/W SHEET NO.			
ROADWAY DESIGN ENGINEER		HYDRAULICS ENGINEER	
CONST.REV.			
R/W REV.			

SHEET 21
MATCH LINE -L- REV. STA. 156+40

MATCH LINE -L- REV. STA. 159+91.5
SHEET 23

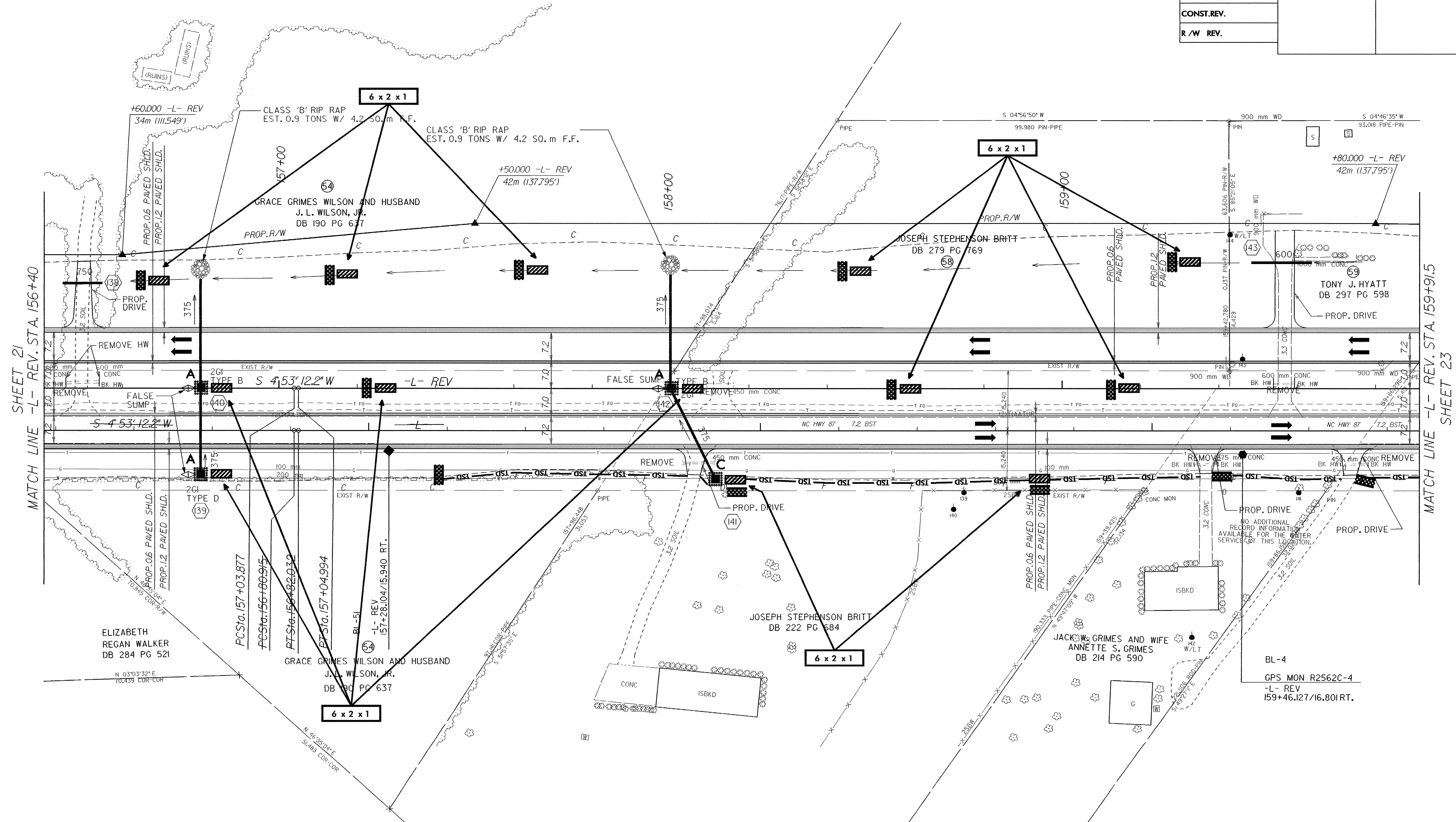

- DRIVEWAY NOTES:**
1. ALL PROP. DRIVEWAY RADII 3.0m UNLESS OTHERWISE SHOWN.
 2. PROP. DRIVEWAY WIDTHS AT END OF RADII SHALL BE 4.9m MIN. UNLESS OTHERWISE SHOWN. TAPER DRIVEWAY TO EXISTING DRIVEWAY WIDTH.

SEE SHEET 41 FOR -L- REV. PROFILE

28-OCT-2004 15:02
d:\REV\156+40\156+40\Roadway\pco\1-2562c-a22.pht
Jungmann