

8/22/99

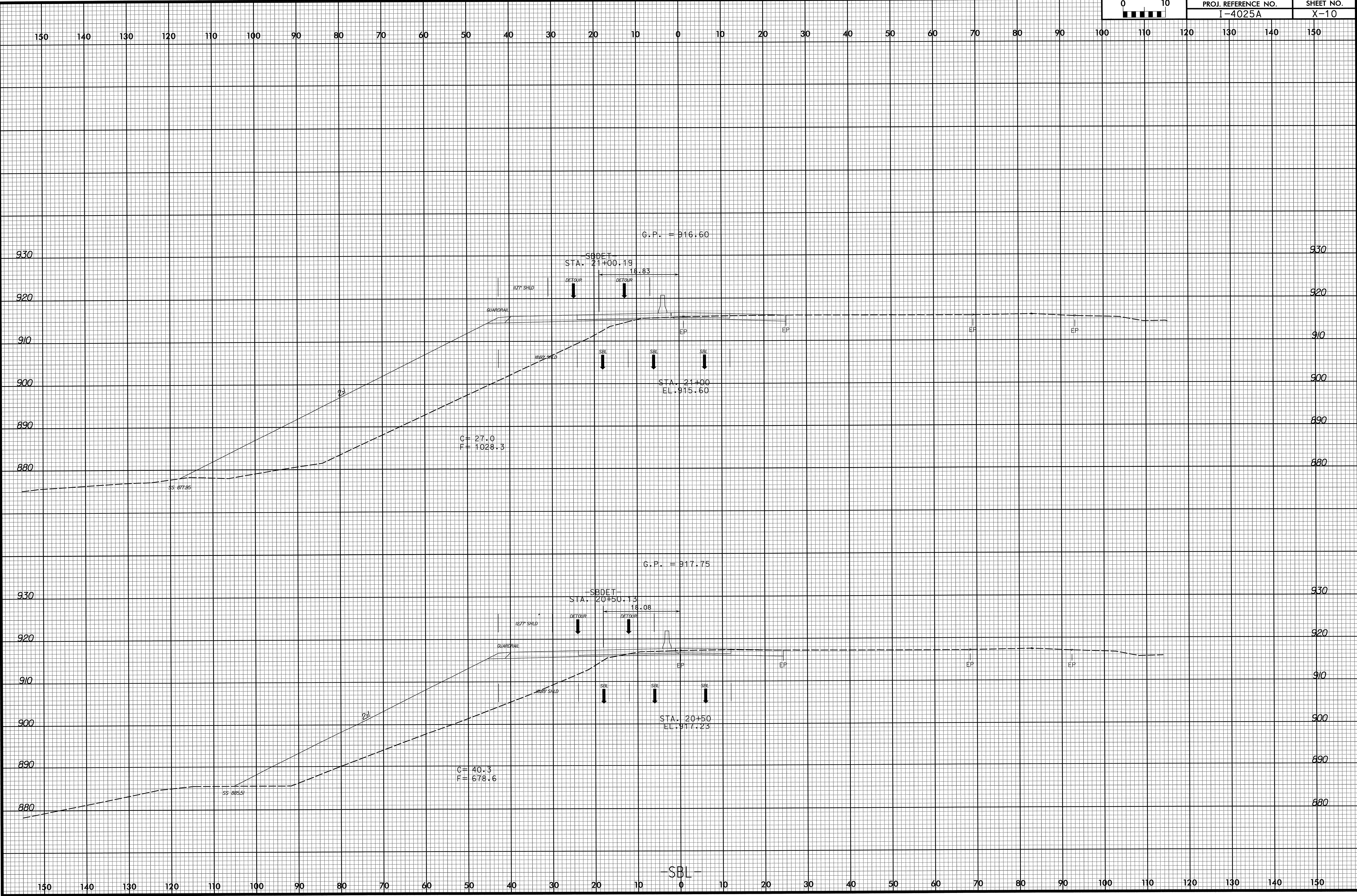

PROJ. REFERENCE NO.
I-4025A

SHEET NO.
X-10



C = 27.0
F = 1028.3

G.P. = 916.60

SBDT
STA. 21+00.19

G.P. = 917.75

SBDT
STA. 20+50.13

STA. 21+00
EL. 915.60

SBL

C = 40.3
F = 678.6

04/07/2004
C:\Program Files\Xsc\...
Ko & Associates, P.C.