

Note:
**DESIGN EXCEPTION REQUIRED
FOR DESIGN SPEED**

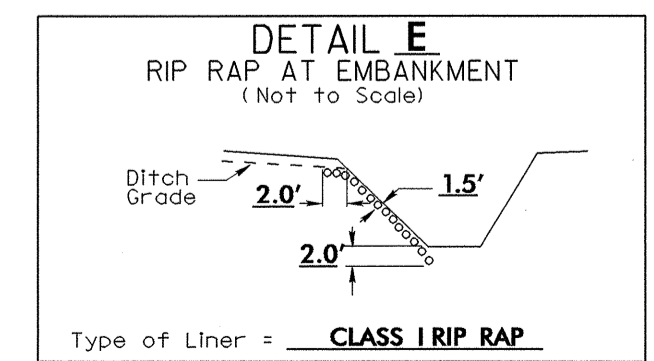

STA 15+00.00 -L- BEGIN TIP PROJECT B-3695

STA 24+50.00 -L- END TIP PROJECT B-3695

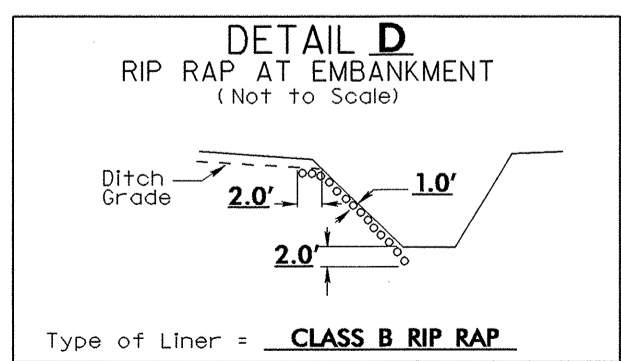
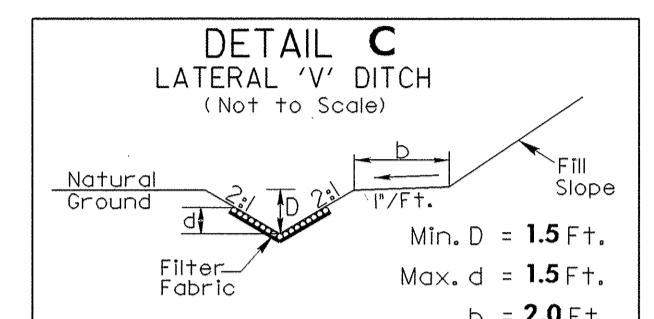
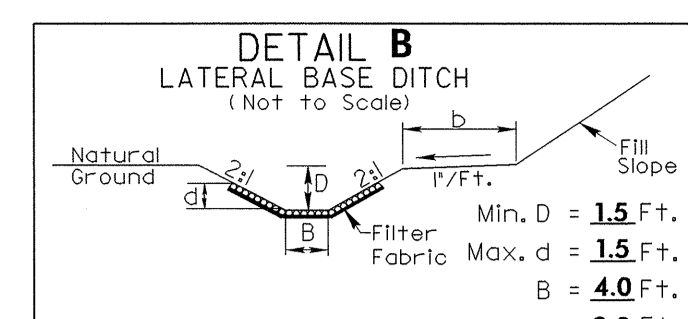
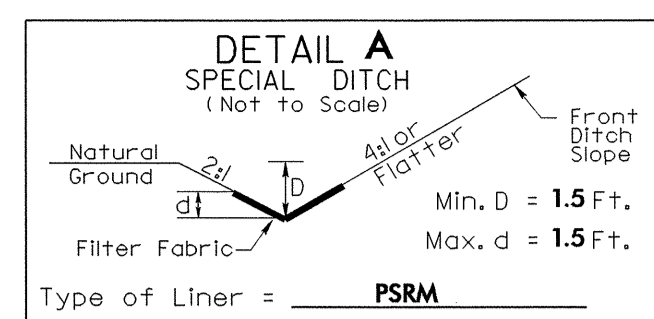
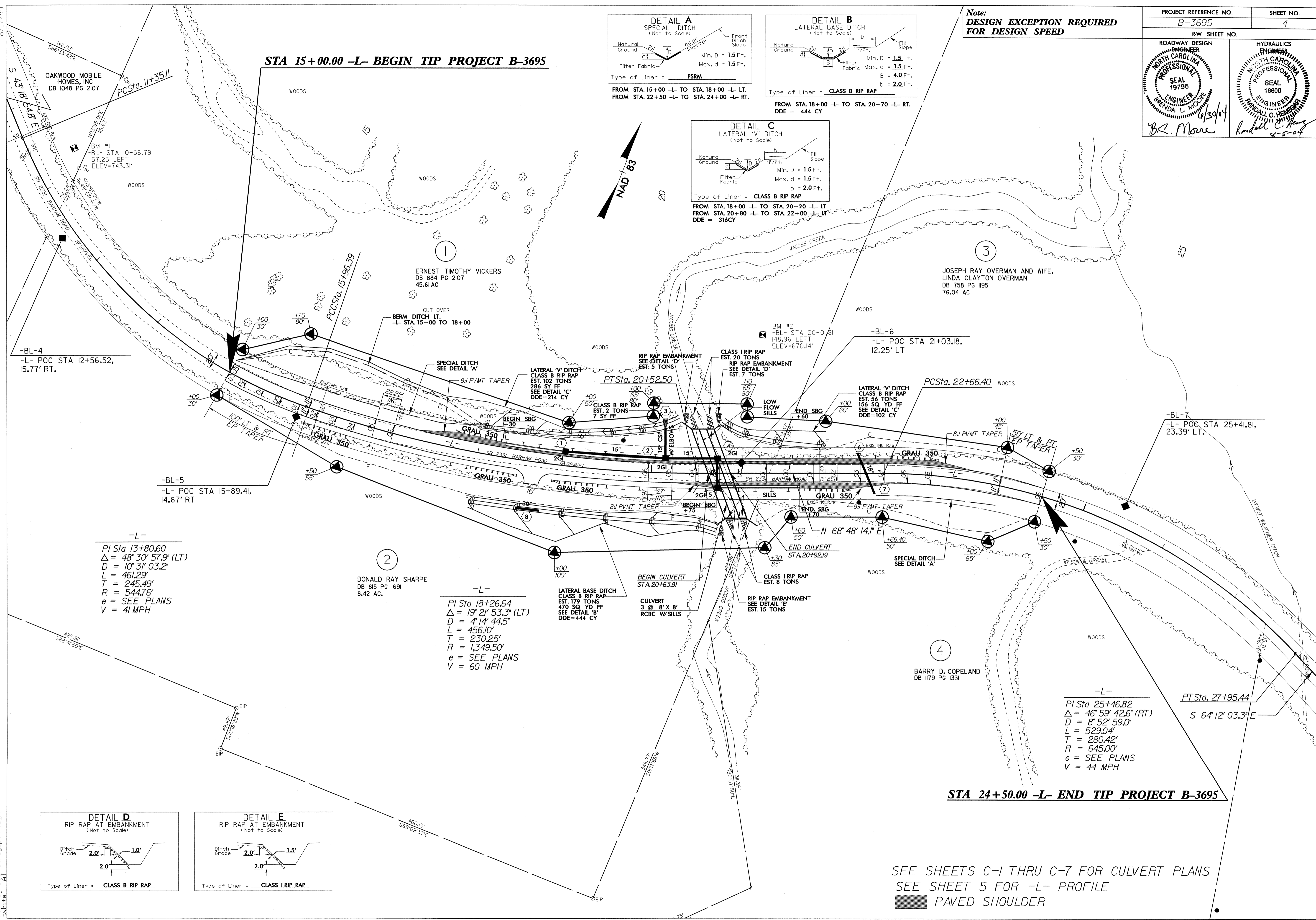

-L-
PI Sta 13+80.60
 $\Delta = 48^\circ 30' 57.9''$ (LT)
D = 10' 31' 03.2"
L = 461.29'
T = 245.49'
R = 544.76'
e = SEE PLANS
V = 41 MPH

-L-
PI Sta 18+26.64
 $\Delta = 19^\circ 21' 53.3''$ (LT)
D = 4' 14' 44.5"
L = 456.10'
T = 230.25'
R = 1,349.50'
e = SEE PLANS
V = 60 MPH

-L-
PI Sta 25+46.82
 $\Delta = 46^\circ 59' 42.6''$ (RT)
D = 8' 52' 59.0"
L = 529.04'
T = 280.42'
R = 645.00'
e = SEE PLANS
V = 44 MPH

SEE SHEETS C-1 THRU C-7 FOR CULVERT PLANS
SEE SHEET 5 FOR -L- PROFILE
PAVED SHOULDER

14-JUN-2004 02:18
RD196590.dwg
RD196590.dwg
RD196590.dwg