

PROJECT REFERENCE NO.	SHEET NO.
B-3695	EC-5/CONST.4
R/W SHEET NO.	
ROADWAY DESIGN ENGINEER	HYDRAULICS ENGINEER

Note:  
**DESIGN EXCEPTION REQUIRED  
FOR DESIGN SPEED (40MPH)**

**STA 15+00.00 -L- BEGIN TIP PROJECT B-3695**

**STA 24+50.00 -L- END TIP PROJECT B-3695**

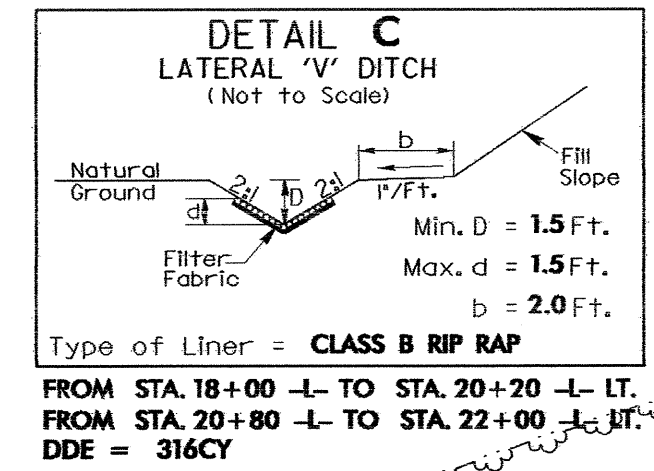
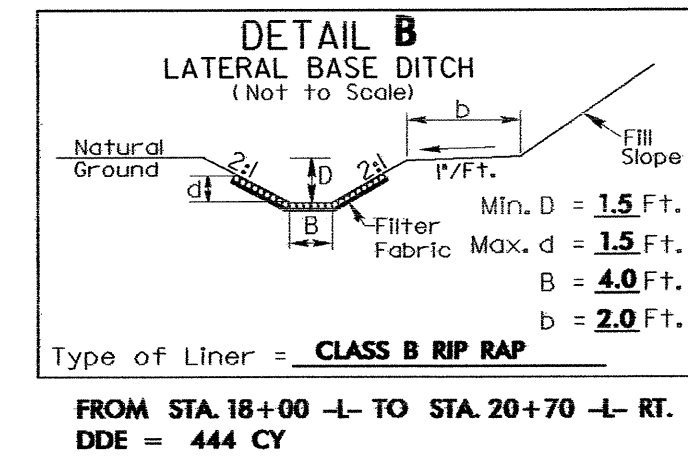
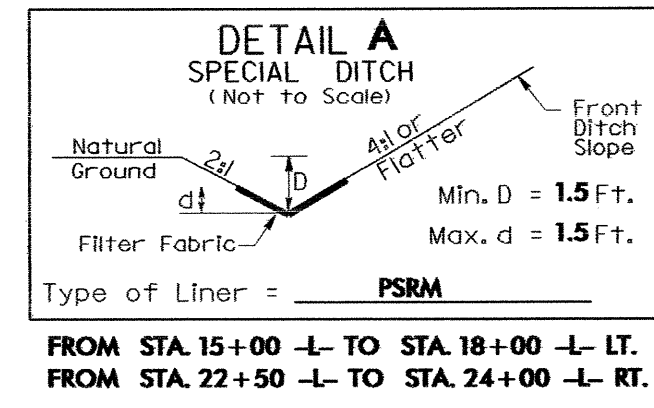
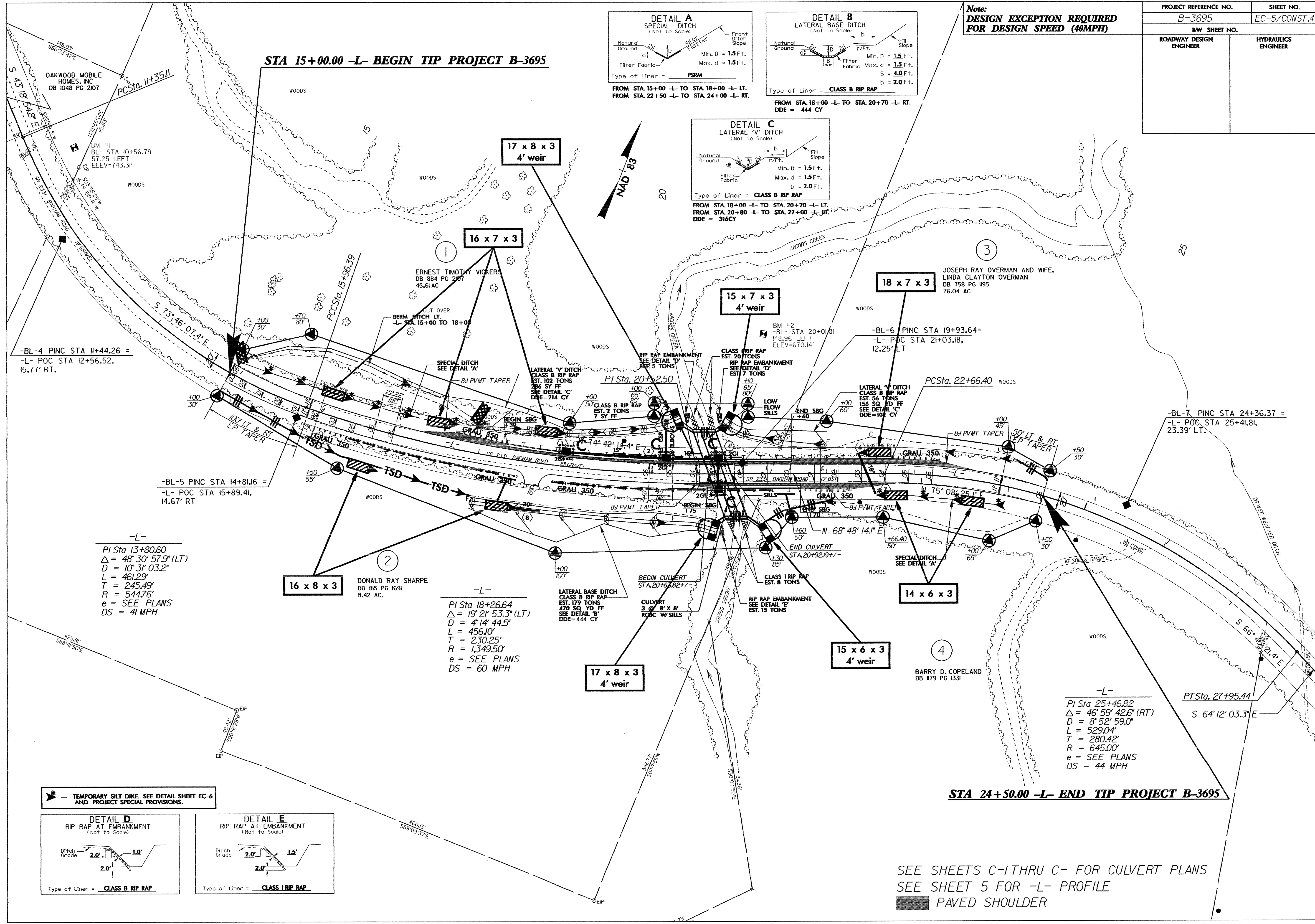

-BL-4 PINC STA 11+44.26 =  
-L- POC STA 12+56.52,  
15.77' RT.

-BL-5 PINC STA 14+81.16 =  
-L- POC STA 15+89.41,  
14.67' RT

-L-  
PI Sta 13+80.60  
Δ = 48° 30' 57.9" (LT)  
D = 10' 31' 03.2"  
L = 461.29'  
T = 245.49'  
R = 544.76'  
e = SEE PLANS  
DS = 41 MPH

-L-  
PI Sta 18+26.64  
Δ = 19° 21' 53.3" (LT)  
D = 4' 14' 44.5"  
L = 456.10'  
T = 230.25'  
R = 1,349.50'  
e = SEE PLANS  
DS = 60 MPH

-L-  
PI Sta 18+26.64  
Δ = 19° 21' 53.3" (LT)  
D = 4' 14' 44.5"  
L = 456.10'  
T = 230.25'  
R = 1,349.50'  
e = SEE PLANS  
DS = 60 MPH

-L-  
PI Sta 25+46.82  
Δ = 46° 59' 42.6" (RT)  
D = 8' 52' 59.0"  
L = 529.04'  
T = 280.42'  
R = 645.00'  
e = SEE PLANS  
DS = 44 MPH

★ — TEMPORARY SILT DIKE. SEE DETAIL SHEET EC-6  
AND PROJECT SPECIAL PROVISIONS.

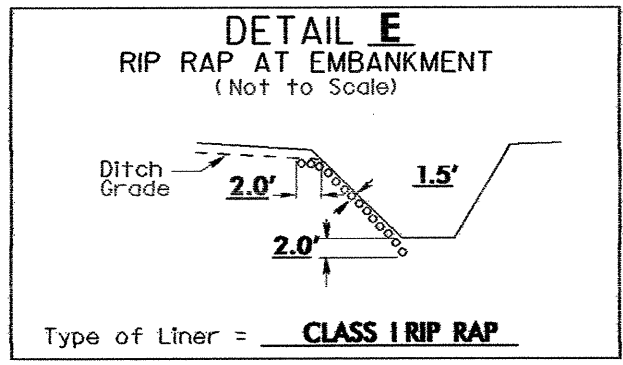
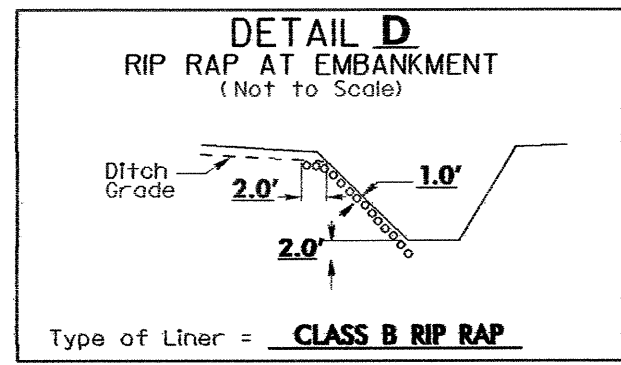

SEE SHEETS C-1 THRU C- FOR CULVERT PLANS  
SEE SHEET 5 FOR -L- PROFILE  
PAVED SHOULDER