

CONTRACT: C200970 TIP PROJECT: R-0513A/R-0513BA

STATE OF NORTH CAROLINA

DEPARTMENT OF TRANSPORTATION

DIVISION OF HIGHWAYS GEOTECHNICAL UNIT

SUBSURFACE INVESTIGATION

CONTENTS: See Sheet 2A for R-513BA Investigation

LINE	STATION	SHEET NO.
-L-	85+80 TO 153+80	4-23, 27-36
-SR3-	25+82 TO 26+37	4, 46
-Y1-	11+90 TO 20+00	11, 26, 37, 38
-LPB-	10+00 TO 12+69	11, 40
-RPB-	10+00 TO 15+05	10, 11, 38, 39
-LPC-	10+00 TO 14+76	11, 41
-RPC-	10+00 TO 18+86	10, 11, 39, 40
-SRI-	10+00 TO 31+50	11, 24, 25, 13-17, 42-44
-SR2-	10+06 TO 21+01	11-15, 45, 46
-SR4-	10+00 TO 12+94	26, 47

STATE PROJECT 34336.3.8 I.D. NO. R-0513BA
 F.A. PROJECT _____
 COUNTY ROBESON
 DESCRIPTION US 74 FROM 1.87 km EAST OF SR 1166 (CABINET ROAD)
TO WEST OF SR 1157 (HENRY BERRY ROAD)
 (INVENTORY)

STATE	N.C.	STATE PROJECT REFERENCE NO.	R-513A/R-513BA	SHEET NO.	1	TOTAL SHEETS	47
STATE PROJ. NO.	34336.1.2	F.A. PROJ. NO.	NHF-18-4(19)	DESCRIPTION	PE (R-0513-A)		
	34336.2.1		NHF-18-4(19)		RW & UTIL (R-0513A)		
	34336.3.8				CONST. (R-0513A)		
	34336.1.2		NHF-18-4(19)		PE (R-0513-BA)		
	34336.2.3				RW & UTIL (R-0513BA)		
	34336.3.8				CONST. (R-0513BA)		

CAUTION NOTICE

THE SUBSURFACE INFORMATION AND THE SUBSURFACE INVESTIGATION ON WHICH IT IS BASED WAS MADE FOR THE PURPOSE OF STUDY, PLANNING AND DESIGN, AND NOT FOR CONSTRUCTION OR PAY PURPOSES. THE VARIOUS FIELD BORING LOGS, ROCK CORES, AND SOIL TEST DATA AVAILABLE MAY BE REVIEWED OR INSPECTED IN RALEIGH BY CONTACTING THE N.C. DEPARTMENT OF TRANSPORTATION, GEOTECHNICAL UNIT @ (919) 250-4088. NEITHER THE SUBSURFACE PLANS AND REPORTS, NOR THE FIELD BORING LOGS, ROCK CORES, OR SOIL TEST DATA IS PART OF THE CONTRACT.

GENERAL SOIL AND ROCK STRATA DESCRIPTIONS AND INDICATED BOUNDARIES ARE BASED ON A GEOTECHNICAL INTERPRETATION OF ALL AVAILABLE SUBSURFACE DATA AND MAY NOT NECESSARILY REFLECT THE ACTUAL SUBSURFACE CONDITIONS BETWEEN BORINGS OR BETWEEN SAMPLED STRATA WITHIN THE BOREHOLE. THE LABORATORY SAMPLE DATA AND THE IN SITU (IN-PLACE) TEST DATA CAN BE RELIED ON ONLY TO THE DEGREE OF RELIABILITY INHERENT IN THE STANDARD TEST METHOD. THE OBSERVED WATER LEVELS OR SOIL MOISTURE CONDITIONS INDICATED IN THE SUBSURFACE INVESTIGATIONS ARE AS RECORDED AT THE TIME OF THE INVESTIGATION. THESE WATER LEVELS OR SOIL MOISTURE CONDITIONS MAY VARY CONSIDERABLY WITH TIME ACCORDING TO CLIMATIC CONDITIONS INCLUDING TEMPERATURES, PRECIPITATION AND WIND, AS WELL AS OTHER NON-CLIMATIC FACTORS.

THE BIDDER OR CONTRACTOR IS CAUTIONED THAT DETAILS SHOWN ON THE SUBSURFACE PLANS ARE PRELIMINARY ONLY AND IN MANY CASES THE FINAL DESIGN DETAILS ARE DIFFERENT. FOR BIDDING AND CONSTRUCTION PURPOSES, REFER TO THE CONSTRUCTION PLANS AND DOCUMENTS FOR FINAL DESIGN INFORMATION ON THIS PROJECT. THE DEPARTMENT DOES NOT WARRANT OR GUARANTEE THE SUFFICIENCY OR ACCURACY OF THE INVESTIGATION MADE, NOR THE INTERPRETATIONS MADE OR OPINION OF THE DEPARTMENT AS TO THE TYPE OF MATERIALS AND CONDITIONS TO BE ENCOUNTERED. THE BIDDER OR CONTRACTOR IS CAUTIONED TO MAKE SUCH INDEPENDENT SUBSURFACE INVESTIGATIONS AS HE DEEMS NECESSARY TO SATISFY HIMSELF AS TO CONDITIONS TO BE ENCOUNTERED ON THIS PROJECT. THE CONTRACTOR SHALL HAVE NO CLAIM FOR ADDITIONAL COMPENSATION OR FOR AN EXTENSION OF TIME FOR ANY REASON RESULTING FROM THE ACTUAL CONDITIONS ENCOUNTERED AT THE SITE DIFFERING FROM THOSE INDICATED IN THE SUBSURFACE INFORMATION.

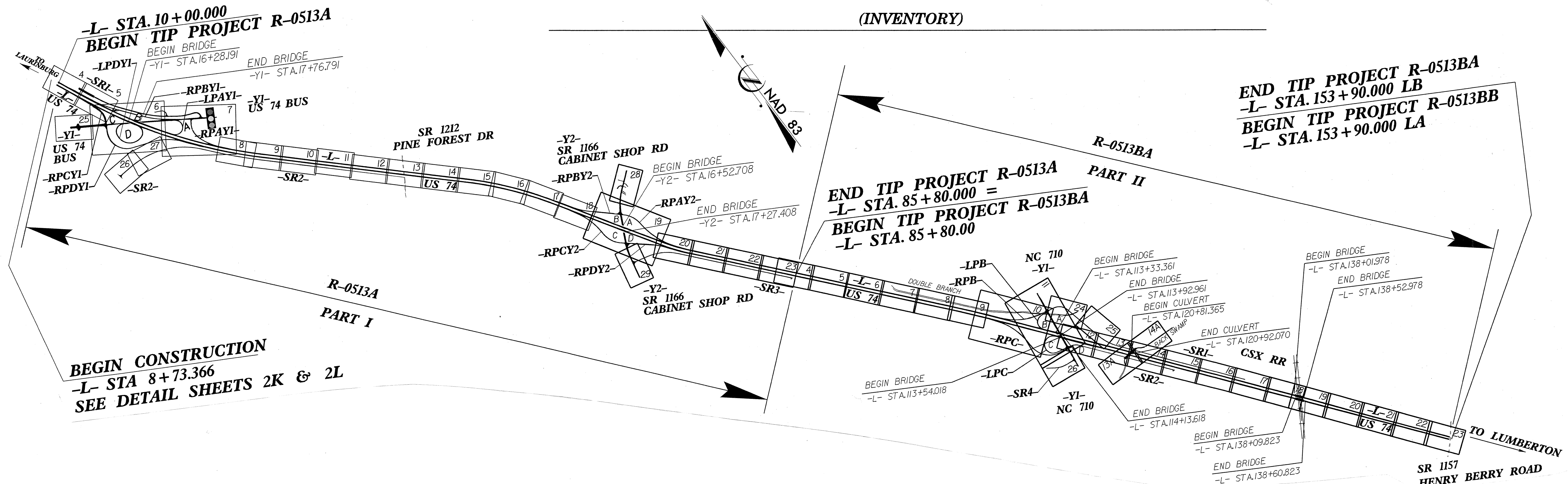

INVESTIGATED BY: PQL PERSONNEL: RLE
 CHECKED BY: PQL PQL DBC
 SUBMITTED BY: RRW MBO
 DATE: NOVEMBER, 2001 JEB

DRAWN BY: PQL, RLE, MLW

NOTE - THE INFORMATION CONTAINED HEREIN IS NOT IMPLIED OR GUARANTEED BY THE N.C. DEPARTMENT OF TRANSPORTATION AS BEING ACCURATE NOR IS IT CONSIDERED TO BE PART OF THE PLANS, SPECIFICATIONS, OR CONTRACT FOR THE PROJECT.

NOTE - BY HAVING REQUESTED THIS INFORMATION THE CONTRACTOR SPECIFICALLY WAIVES ANY CLAIMS FOR INCREASED COMPENSATION OR EXTENSION OF TIME BASED ON DIFFERENCES BETWEEN THE CONDITIONS INDICATED HEREIN AND THE ACTUAL CONDITIONS AT THE PROJECT SITE.

Professional Engineer Seal for Robert Ray White, License No. 254, State of North Carolina. Includes signature of Robert Ray White.