

UTILITIES BY OTHERS

NOTE: ALL PROPOSED UTILITY WORK SHOWN ON THIS SHEET WILL BE DONE BY OTHERS

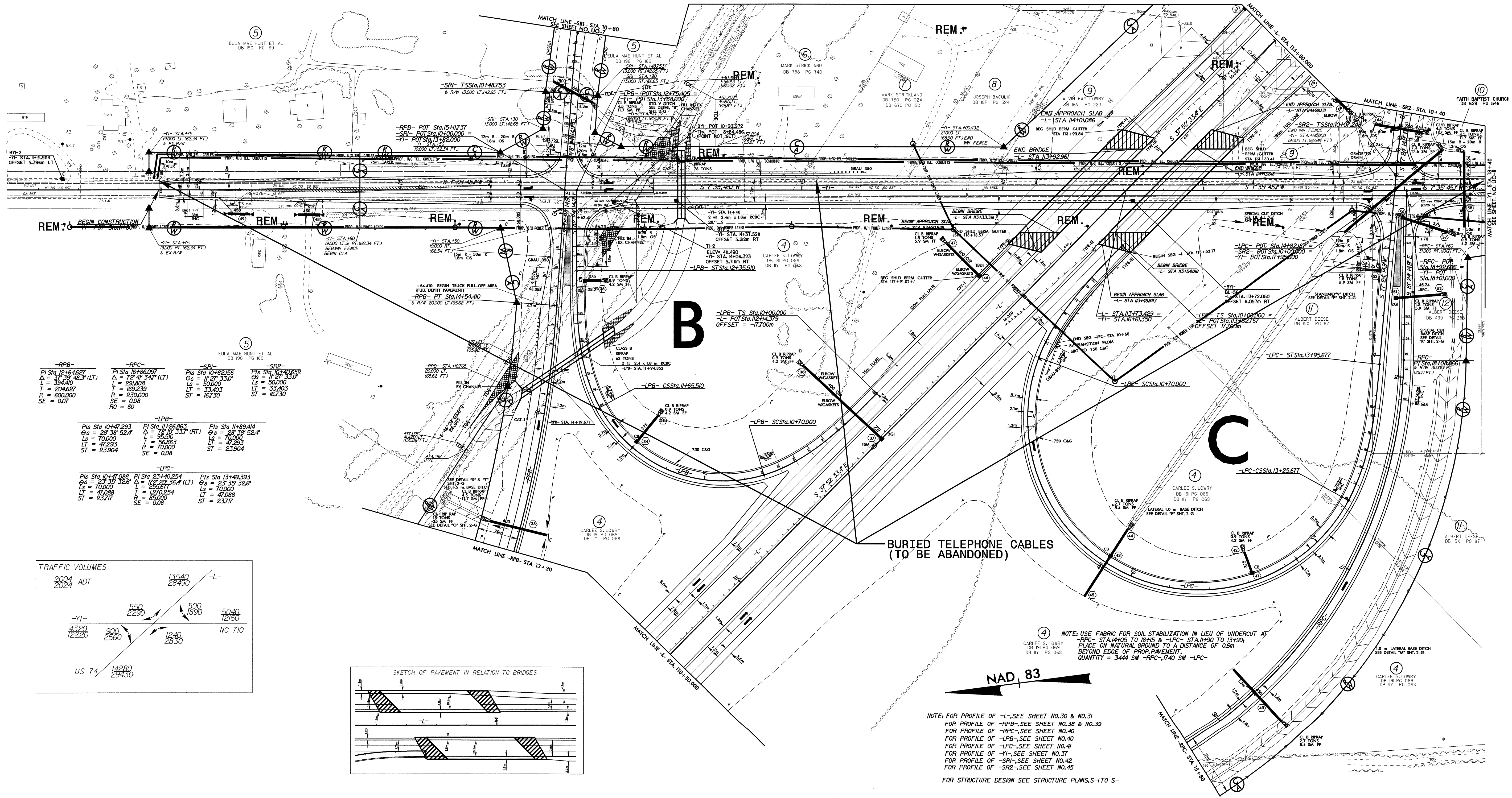

<p><b>-RPB-</b></p> <p>PI Sta 12+64.627 Δs = 17' 39" 48.3" (LT) L = 304.40 T = 204.627 R = 800.000 SE = 0.07</p>	<p><b>-RPC-</b></p> <p>PI Sta 16+86.097 Δs = 12' 4" 34.7" (LT) L = 290.00 T = 169.239 R = 230.000 SE = 0.08 RO = 60</p>	<p><b>-SRI-</b></p> <p>PIs Sta 10+82.156 Os = 17' 27" 33.0" Ls = 50.000 Ls = 33.403 LT = 167.30</p>	<p><b>-SR2-</b></p> <p>PIs Sta 10+40.652 Os = 11' 57" 33.0" Ls = 50.000 Ls = 33.403 LT = 167.30</p>
<p><b>-LPB-</b></p> <p>PIs Sta 10+47.293 Os = 28' 38" 52.4" Ls = 70.000 Ls = 47.293 ST = 23.904</p>	<p><b>-LPC-</b></p> <p>PIs Sta 11+26.863 Os = 16' 10" 33.7" (RT) Ls = 95.510 Ls = 66.263 LT = 70.000 SE = 0.08</p>	<p><b>-LPC-</b></p> <p>PIs Sta 11+89.414 Os = 28' 38" 52.4" Ls = 70.000 Ls = 47.293 ST = 23.904</p>	<p><b>-LPC-</b></p> <p>PIs Sta 13+49.393 Os = 23' 33" 32.8" Ls = 125.877 Ls = 70.000 Ls = 47.088 ST = 23.717</p>

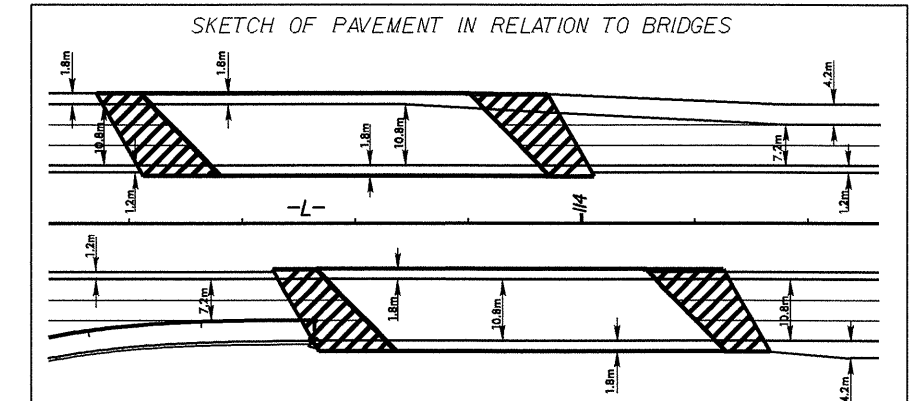
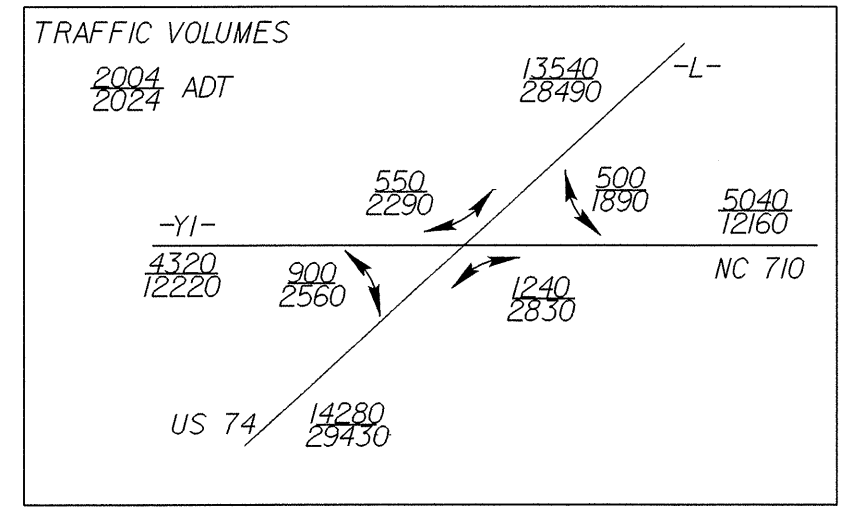

BURIED TELEPHONE CABLES (TO BE ABANDONED)

NAD 83

NOTE: FOR PROFILE OF -L-, SEE SHEET NO.30 & NO.31  
 FOR PROFILE OF -RPB-, SEE SHEET NO.38 & NO.39  
 FOR PROFILE OF -RPC-, SEE SHEET NO.40  
 FOR PROFILE OF -LPB-, SEE SHEET NO.40  
 FOR PROFILE OF -LPC-, SEE SHEET NO.41  
 FOR PROFILE OF -YI-, SEE SHEET NO.37  
 FOR PROFILE OF -SRI-, SEE SHEET NO.42  
 FOR PROFILE OF -SR2-, SEE SHEET NO.45  
 FOR STRUCTURE DESIGN SEE STRUCTURE PLANS, S-1 TO S-7

15-JUN-2004 14:58 sgdbold\15-jun-2004 14:58 0613ba.uo-2.dwg