

UTILITIES BY OTHERS

NOTE:  
ALL PROPOSED UTILITY WORK  
SHOWN ON THIS SHEET WILL  
BE DONE BY OTHERS

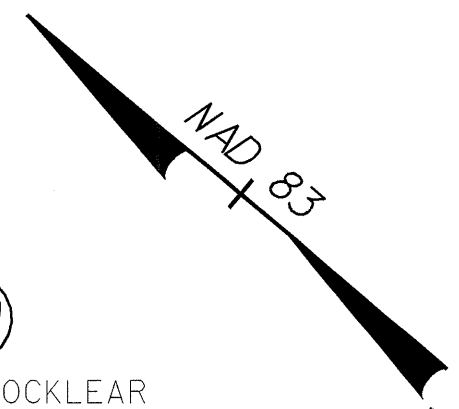

MATCHLINE SEE SHEET UO-5 -L- Sta. 72+50

MATCHLINE SEE SHEET UO-7 -L- Sta. 75+80

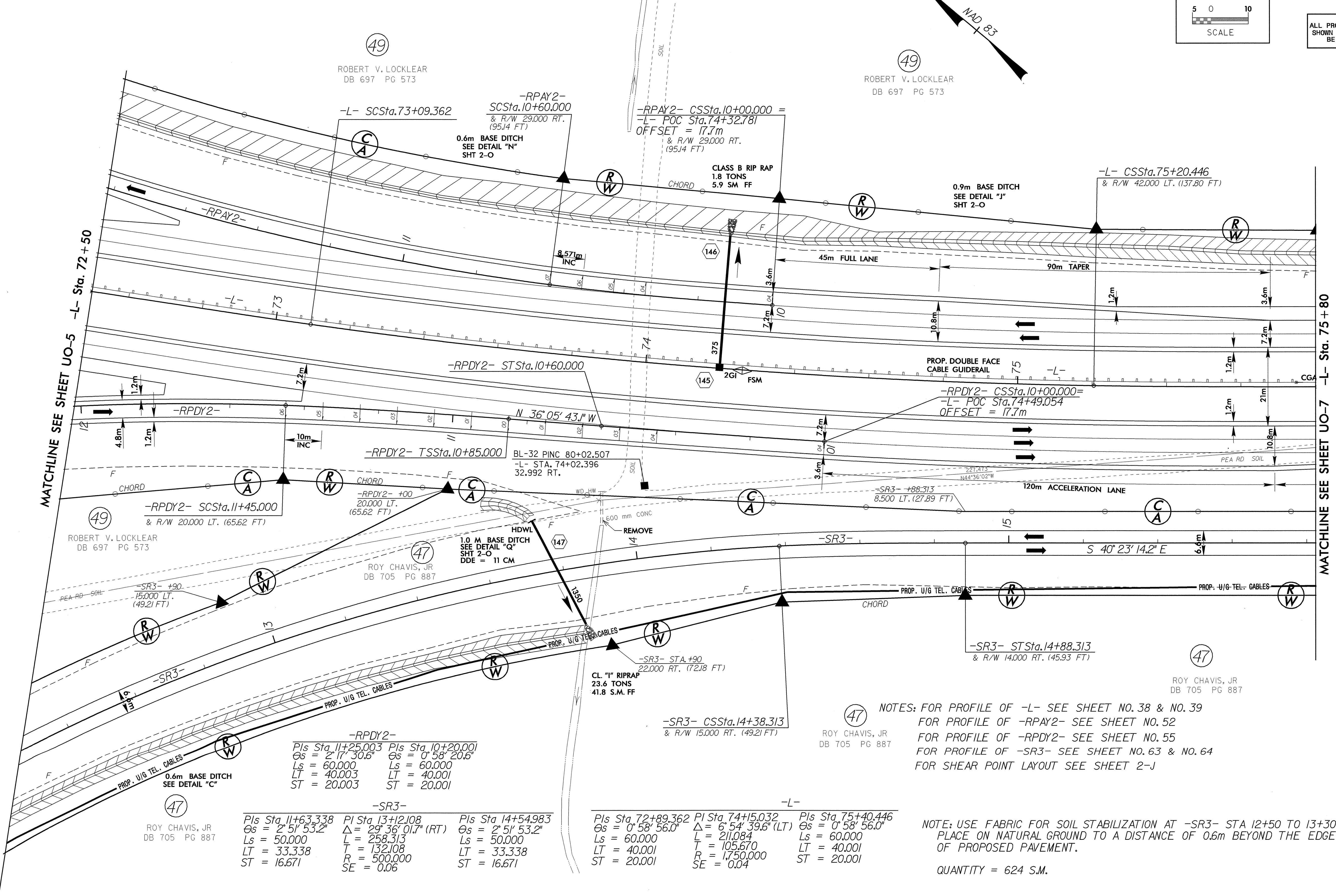

-RPDY2-

Pls Sta 11+25.003	Pls Sta 10+20.001
Os = 2° 17' 30.6"	Os = 0° 58' 20.6"
Ls = 60.000	Ls = 60.000
LT = 40.003	LT = 40.001
ST = 20.003	ST = 20.001

-SR3-

Pls Sta 11+63.338	Pls Sta 13+12.108	Pls Sta 14+54.983
Os = 2° 51' 53.2"	Δ = 29° 36' 01.7" (RT)	Os = 2° 51' 53.2"
Ls = 50.000	L = 258.313	Ls = 50.000
LT = 33.338	T = 132.108	LT = 33.338
ST = 16.671	R = 500.000	ST = 16.671
	SE = 0.06	

-L-

Pls Sta 72+89.362	Pls Sta 74+15.032	Pls Sta 75+40.446
Os = 0° 58' 56.0"	Δ = 6° 54' 39.6" (LT)	Os = 0° 58' 56.0"
Ls = 60.000	L = 211.084	Ls = 60.000
LT = 40.001	T = 105.670	LT = 40.001
ST = 20.001	R = 1,750.000	ST = 20.001
	SE = 0.04	

47 NOTES: FOR PROFILE OF -L- SEE SHEET NO. 38 & NO. 39  
FOR PROFILE OF -RPAY2- SEE SHEET NO. 52  
FOR PROFILE OF -RPDY2- SEE SHEET NO. 55  
FOR PROFILE OF -SR3- SEE SHEET NO. 63 & NO. 64  
FOR SHEAR POINT LAYOUT SEE SHEET 2-J

NOTE: USE FABRIC FOR SOIL STABILIZATION AT -SR3- STA 12+50 TO 13+30,  
PLACE ON NATURAL GROUND TO A DISTANCE OF 0.6m BEYOND THE EDGE  
OF PROPOSED PAVEMENT.

QUANTITY = 624 S.M.

15-JUN-2004 16:16 \\gpc-0513as20.psh  
egodho12 11:41 AM '04