

VICINITY MAP

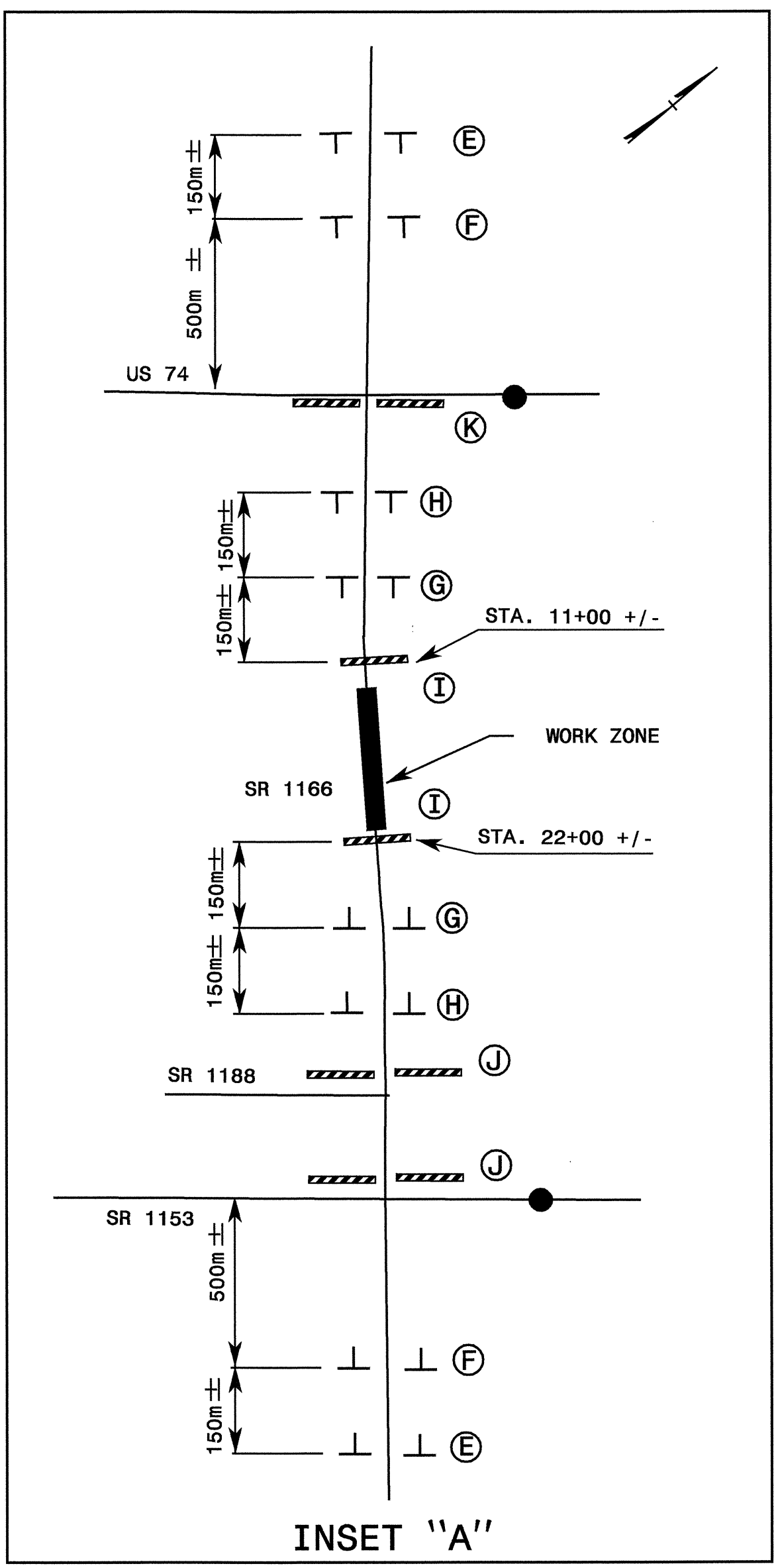

DETOUR ROUTE



INSET "A"

N. C. DEPARTMENT OF TRANSPORTATION
DIVISION OF HIGHWAYS
TRAFFIC ENGINEERING BRANCH
SIGNING DEPARTMENT

SIGN NUMBER: 03503	BACKG COLOR: Orange	DESIGN BY: CL DOWNEY	CHECKED BY:	STD #:
TYPE: D	COPY COLOR: Black	PROJECT ID: R-0513A	DIV: DIV	DATE: Oct 06, 2003
QUANTITY: 1				

SYMBOL	X	Y	WID	HT

SIGN WIDTH: 1100mm
HEIGHT: 600mm
TOTAL AREA: 0.7 Sq.m

BORDER TYPE: FLUSH
RECESS: 10mm
WIDTH: 15mm
RADI: 40mm

NO. Z BARS:
LENGTH:

MAT'L: 0.080" (2.0 mm) ALUMINUM

USE NOTES: 1, 2
1. Legend and border shall be direct applied non-reflective sheeting.
2. Background shall be Type VII or higher reflective sheeting.

BORDER
R=40mm
TH=15mm
IN=10mm

Letter spacings are to start of next letter

Series/Size	Text Length
C150	676
C150	783

Spacing Factor is 1 unless specified otherwise

FILENAME: CABINET

NORTH CAROLINA D.O.T. SIGN DETAIL

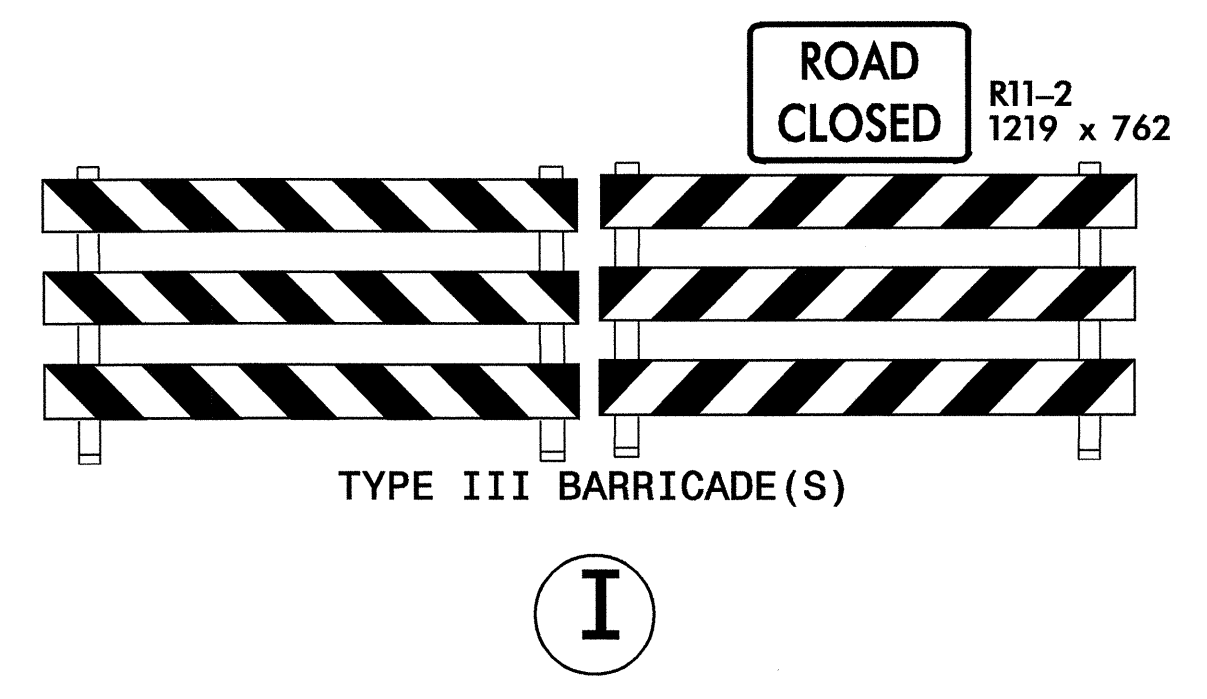
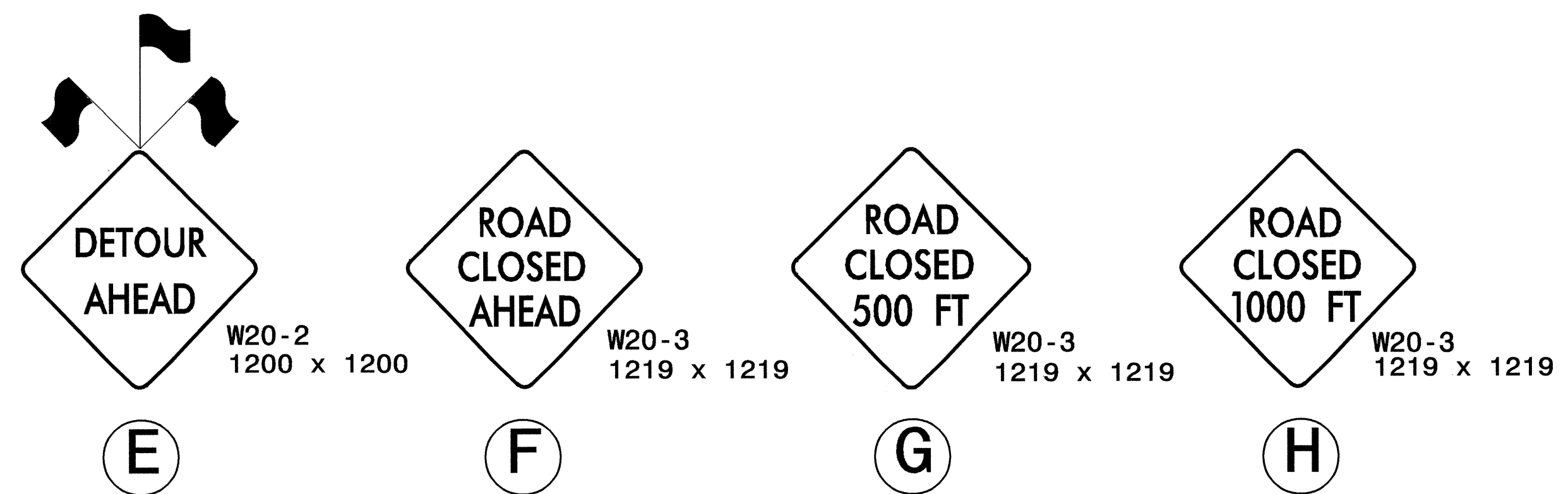
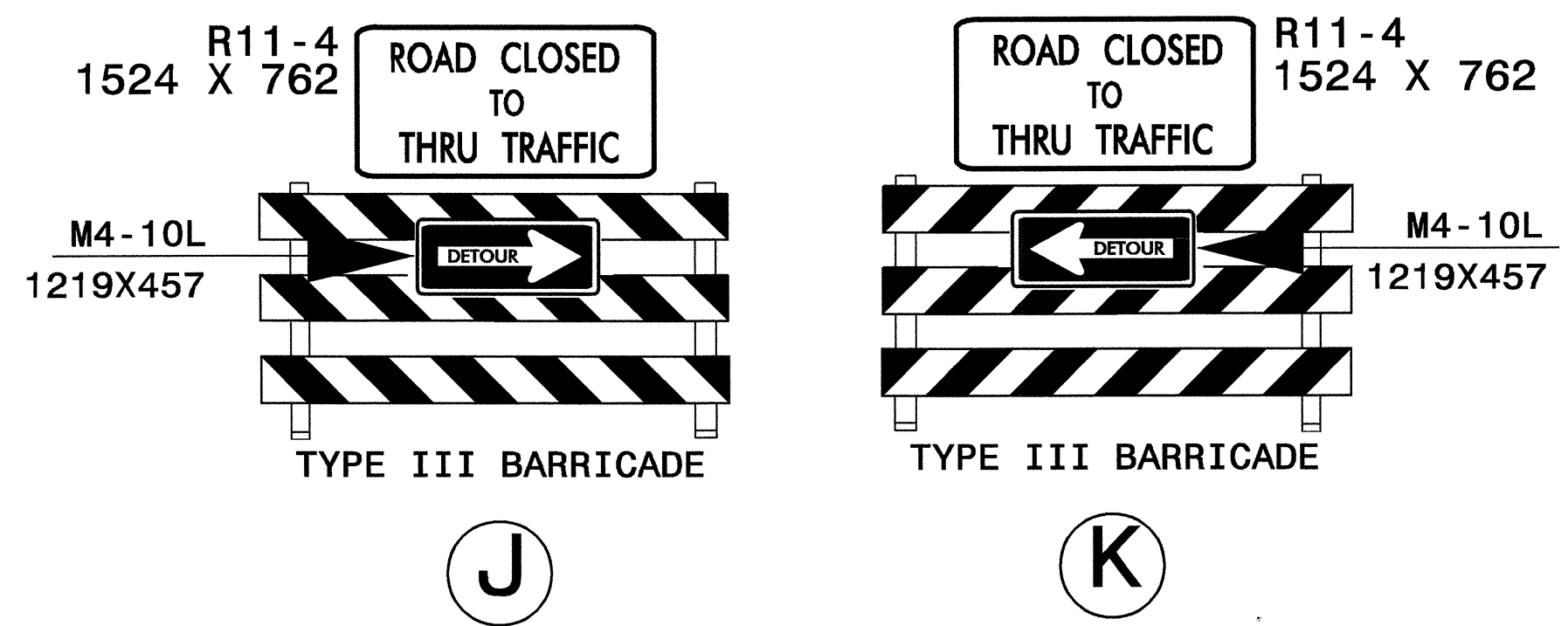
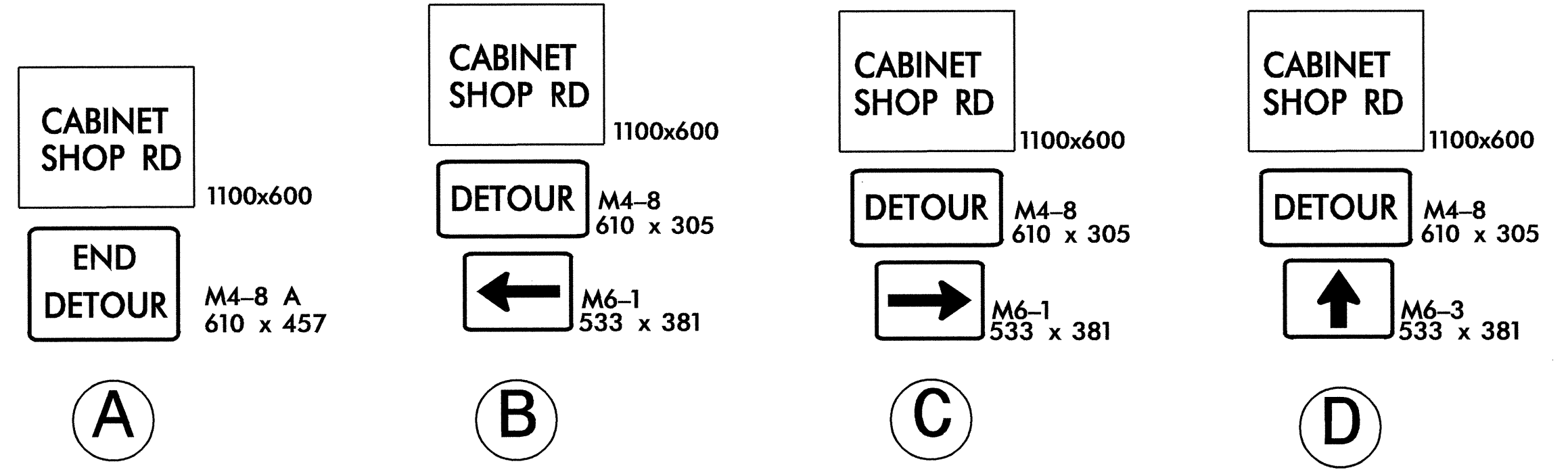

APPROVED: *[Signature]* DATE: 8/29/04

SEAL

OFFSITE DETOUR FOR SR 1166

SCALE: NONE	REVISIONS
DATE: 09/03	
DWG. BY: DAH	
DESIGN BY: DAH	
REVIEWED BY: JDK	

SEAL
NORTH CAROLINA PROFESSIONAL ENGINEERING EXAMINING BOARD
JOHN S. KITE, II
ENGINEER

19-AUG-2004 15:55
T:\CP\Phase1\N0513A_TC_Topil_PHL.dgn
ahayes AT 11/09/2004