

8/17/99

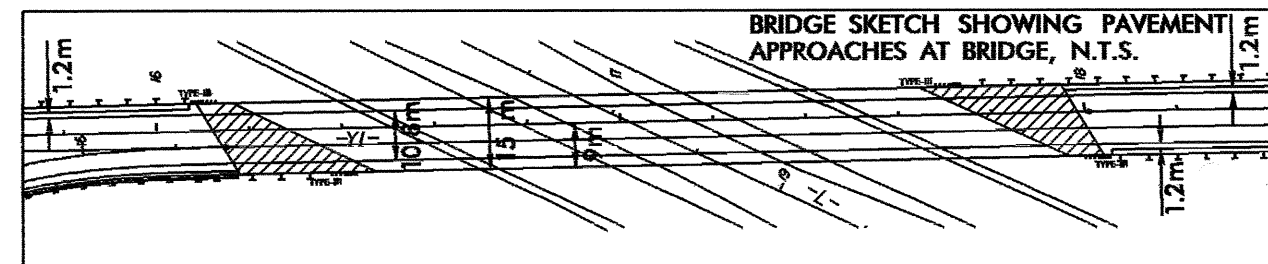

NOTE: SEE STRUCTURE PLANS FOR THE ACCURATE LOCATION OF THE APPROACH SLABS.

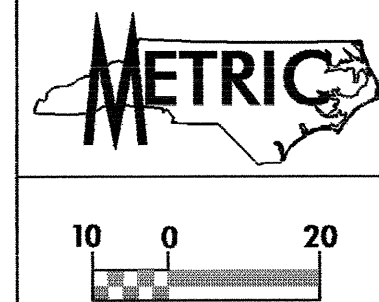

PROJECT REFERENCE NO. R-0513A	SHEET NO. EC-31/CONST.6
ROADWAY DESIGN ENGINEER R/W SHEET NO.	HYDRAULICS ENGINEER
CONST. REV.	
R/W REV.	

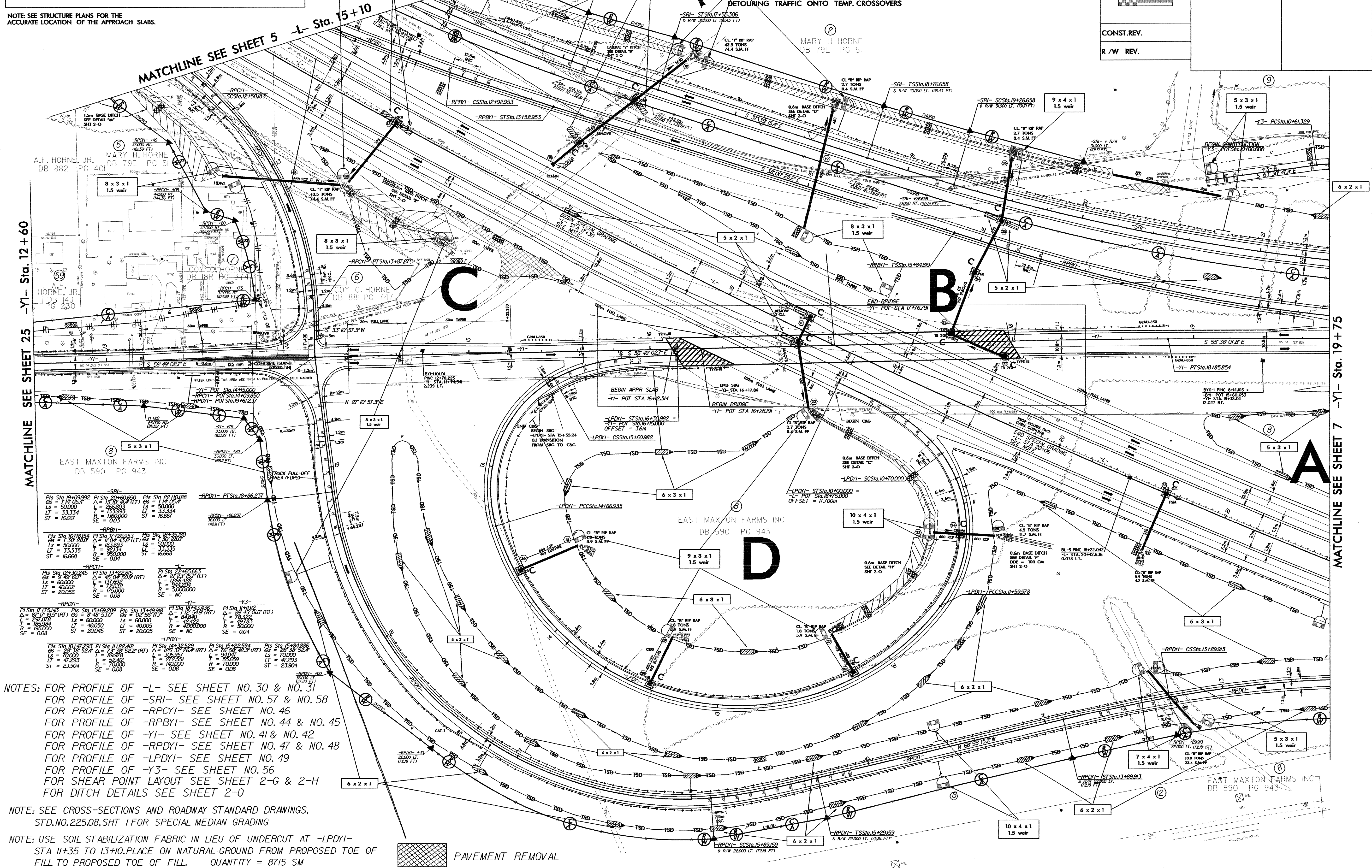

MATCHLINE SEE SHEET 25 -Y1- Sta. 12+60

MATCHLINE SEE SHEET 5 -L- Sta. 15+10

MATCHLINE SEE SHEET 7 -Y1- Sta. 19+75

-SRI- Pts Sta 13+10.292 GS = 1.14 LS = 50.000 LT = 33.334 ST = 16.667 SE = 0.03	-RPCYI- Pts Sta 12+10.128 GS = 1.14 LS = 50.000 LT = 33.334 ST = 16.667 SE = 0.03	-RPCYI- Pts Sta 11+15.000 GS = 1.14 LS = 50.000 LT = 33.334 ST = 16.667 SE = 0.03	-RPCYI- Pts Sta 10+20.245 GS = 1.14 LS = 50.000 LT = 33.334 ST = 16.667 SE = 0.03	-RPCYI- Pts Sta 9+25.482 GS = 1.14 LS = 50.000 LT = 33.334 ST = 16.667 SE = 0.03	-RPCYI- Pts Sta 8+30.719 GS = 1.14 LS = 50.000 LT = 33.334 ST = 16.667 SE = 0.03	-RPCYI- Pts Sta 7+35.956 GS = 1.14 LS = 50.000 LT = 33.334 ST = 16.667 SE = 0.03	-RPCYI- Pts Sta 6+41.193 GS = 1.14 LS = 50.000 LT = 33.334 ST = 16.667 SE = 0.03	-RPCYI- Pts Sta 5+46.430 GS = 1.14 LS = 50.000 LT = 33.334 ST = 16.667 SE = 0.03	-RPCYI- Pts Sta 4+51.667 GS = 1.14 LS = 50.000 LT = 33.334 ST = 16.667 SE = 0.03	-RPCYI- Pts Sta 3+56.904 GS = 1.14 LS = 50.000 LT = 33.334 ST = 16.667 SE = 0.03	-RPCYI- Pts Sta 2+62.141 GS = 1.14 LS = 50.000 LT = 33.334 ST = 16.667 SE = 0.03	-RPCYI- Pts Sta 1+67.378 GS = 1.14 LS = 50.000 LT = 33.334 ST = 16.667 SE = 0.03
---	---	---	---	--	--	--	--	--	--	--	--	--

NOTES: FOR PROFILE OF -L- SEE SHEET NO. 30 & NO. 31
 FOR PROFILE OF -SRI- SEE SHEET NO. 57 & NO. 58
 FOR PROFILE OF -RPCYI- SEE SHEET NO. 46
 FOR PROFILE OF -RPBYI- SEE SHEET NO. 44 & NO. 45
 FOR PROFILE OF -Y1- SEE SHEET NO. 41 & NO. 42
 FOR PROFILE OF -RPDYI- SEE SHEET NO. 47 & NO. 48
 FOR PROFILE OF -LPDYI- SEE SHEET NO. 49
 FOR PROFILE OF -Y3- SEE SHEET NO. 56
 FOR SHEAR POINT LAYOUT SEE SHEET 2-G & 2-H
 FOR DITCH DETAILS SEE SHEET 2-0

NOTE: SEE CROSS-SECTIONS AND ROADWAY STANDARD DRAWINGS, STD.NO.225.08,SHT 1 FOR SPECIAL MEDIAN GRADING

NOTE: USE SOIL STABILIZATION FABRIC IN LIEU OF UNDERCUT AT -LPDYI- STA 11+35 TO 13+10.PLACE ON NATURAL GROUND FROM PROPOSED TOE OF FILL TO PROPOSED TOE OF FILL. QUANTITY = 8715 SM

