

09/09/99

CONTRACT: C200970 TIP PROJECT: R-0513A/R-0513BA

See Sheet 1-A For Index of Sheets
See Sheet 1-B For Conventional Symbols

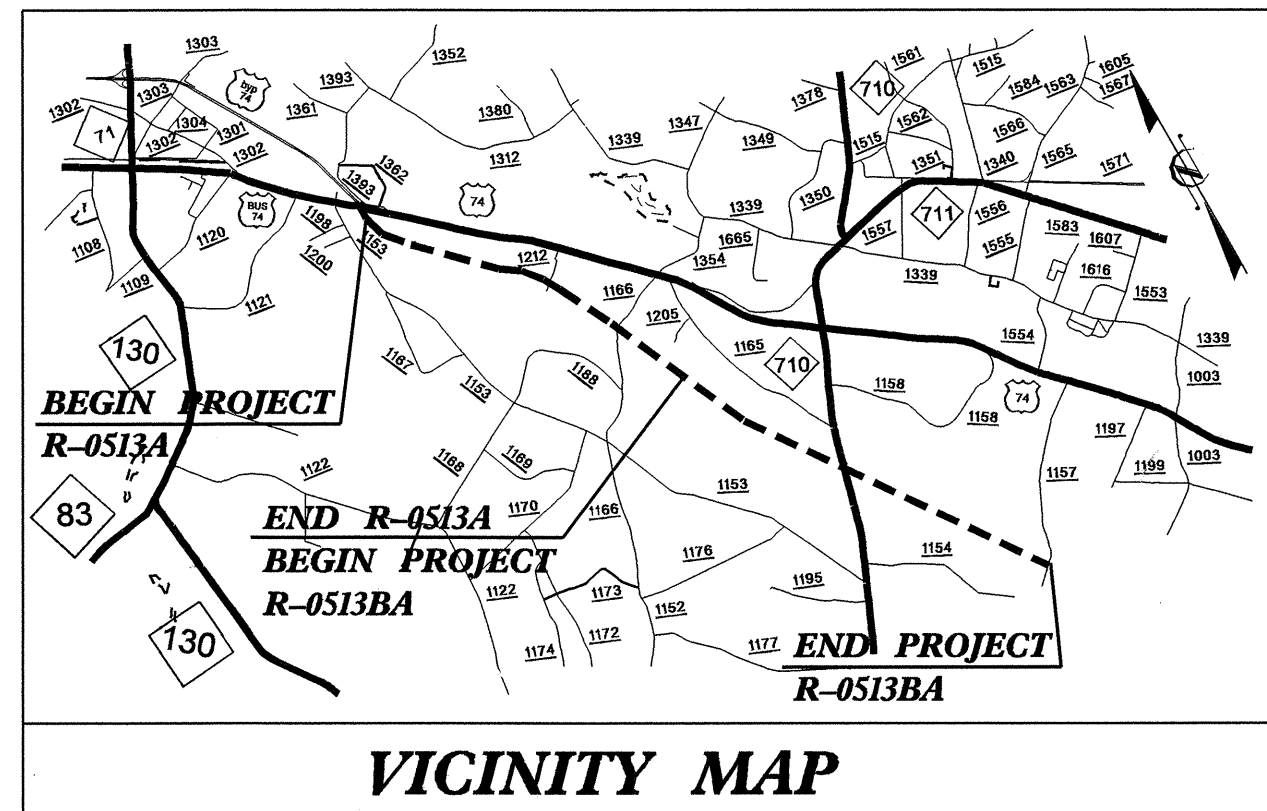

STATE OF NORTH CAROLINA DIVISION OF HIGHWAYS

ROBESON COUNTY

STATE	STATE PROJECT REFERENCE NO.	SHEET NO.	TOTAL SHEETS
N.C.	R-513A/R-513BA	1	
STATE PROJ. NO.	F.A. PROJ. NO.	DESCRIPTION	
34336.1.2	NHF-18-4(19)	PE (R-0513-A)	
34336.2.1	NHF-18-4(19)	R/W & UTIL (R-0513A)	
34336.3.8		CONST. (R-0513A)	
34336.1.2	NHF-18-4(19)	PE (R-0513-BA)	
34336.2.3		R/W & UTIL (R-0513BA)	
34336.3.8		CONST. (R-0513BA)	

ALL DIMENSIONS IN THESE PLANS ARE IN METERS AND/OR MILLIMETERS UNLESS OTHERWISE SHOWN

LOCATION: US 74 FROM MAXTON BYPASS 1.82 KILOMETERS EAST OF SR 1166 (CABINET SHOP ROAD); US 74 FROM EAST OF SR 1166 TO WEST OF SR 1157 (HENRY BERRY ROAD)

TYPE OF WORK: GRADING, DRAINAGE, PAVING, STRUCTURES, SIGNING, SIGNALS AND GUIDERAIL

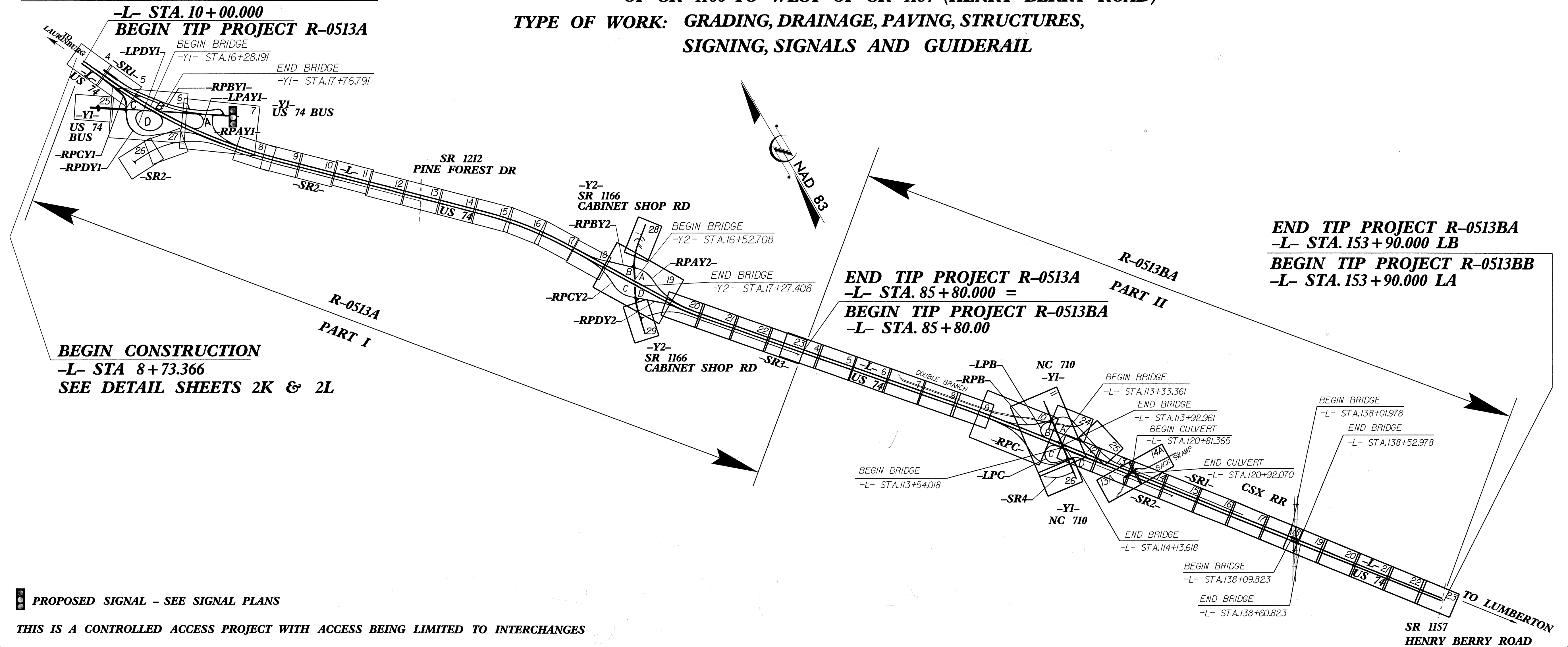

PROPOSED SIGNAL - SEE SIGNAL PLANS

THIS IS A CONTROLLED ACCESS PROJECT WITH ACCESS BEING LIMITED TO INTERCHANGES

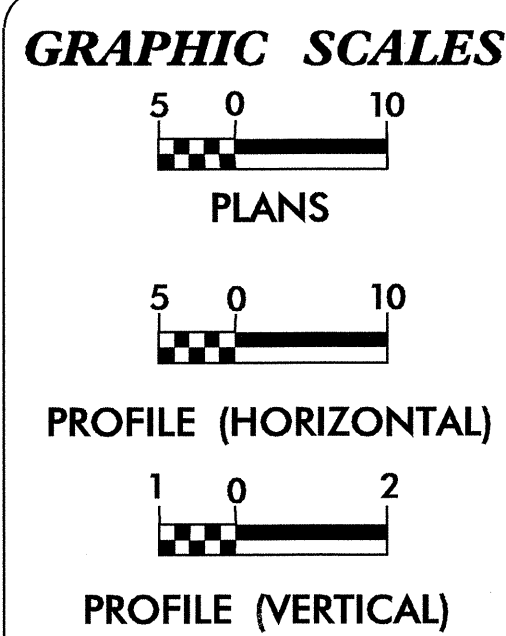

PROJECT LENGTH	
COMBINED LENGTH ROADWAY TIP PROJECT R-0513A/BA =	14.266 km
COMBINED LENGTH STRUCTURES TIP PROJECT R-0513A/BA =	0.121 km
COMBINED TOTAL LENGTH TIP PROJECT R-0513A/BA =	14.390 km

	DESIGN DATA					
	ADT (2004)	ADT (2024)	DHV	D	T	V
R-0513A	17,740	37,000	10%	55%	22% TTST 10% DUAL	110 km/h
R-0513BA	14,280	29,430	10%	55%	22% TTST 10% DUAL	110 km/h

Prepared in the Office of:
DIVISION OF HIGHWAYS
1000 Birch Ridge Dr., Raleigh, NC 27610

2002 STANDARD SPECIFICATIONS

RIGHT OF WAY DATE:
JULY 16, 2002(R-0513A)
DEC. 20, 2002(R-0513BA)

LETTING DATE:
NOVEMBER 16, 2004

**DIVISION OF HIGHWAYS
STATE OF NORTH CAROLINA**

Out Millan P.E.
STATE DESIGN ENGINEER

**DEPARTMENT OF TRANSPORTATION
FEDERAL HIGHWAY ADMINISTRATION**

APPROVED
DIVISION ADMINISTRATOR

DATE

24 SEP 2004 12:06
CALVIGI AT RD0513A.dgn