

8/17/04  
09-JUL-2004 15:01  
C:\p04\p041501\Drawings\187165.dwg  
MICROSOFT AT 187165

**METRIC**  
5 0 10  
CONST. REV.  
R/W REV. 11/26/03

PROJECT REFERENCE NO. R-0513A	SHEET NO. 21
R/W SHEET NO.	
ROADWAY DESIGN ENGINEER	HYDRAULICS ENGINEER
R. LOVE 25873	T. STEPHENS 20754
9-24-04	

TGS Engineers  
975 Walnut Street, Suite 141  
Cary, NC 27511  
9-29-04

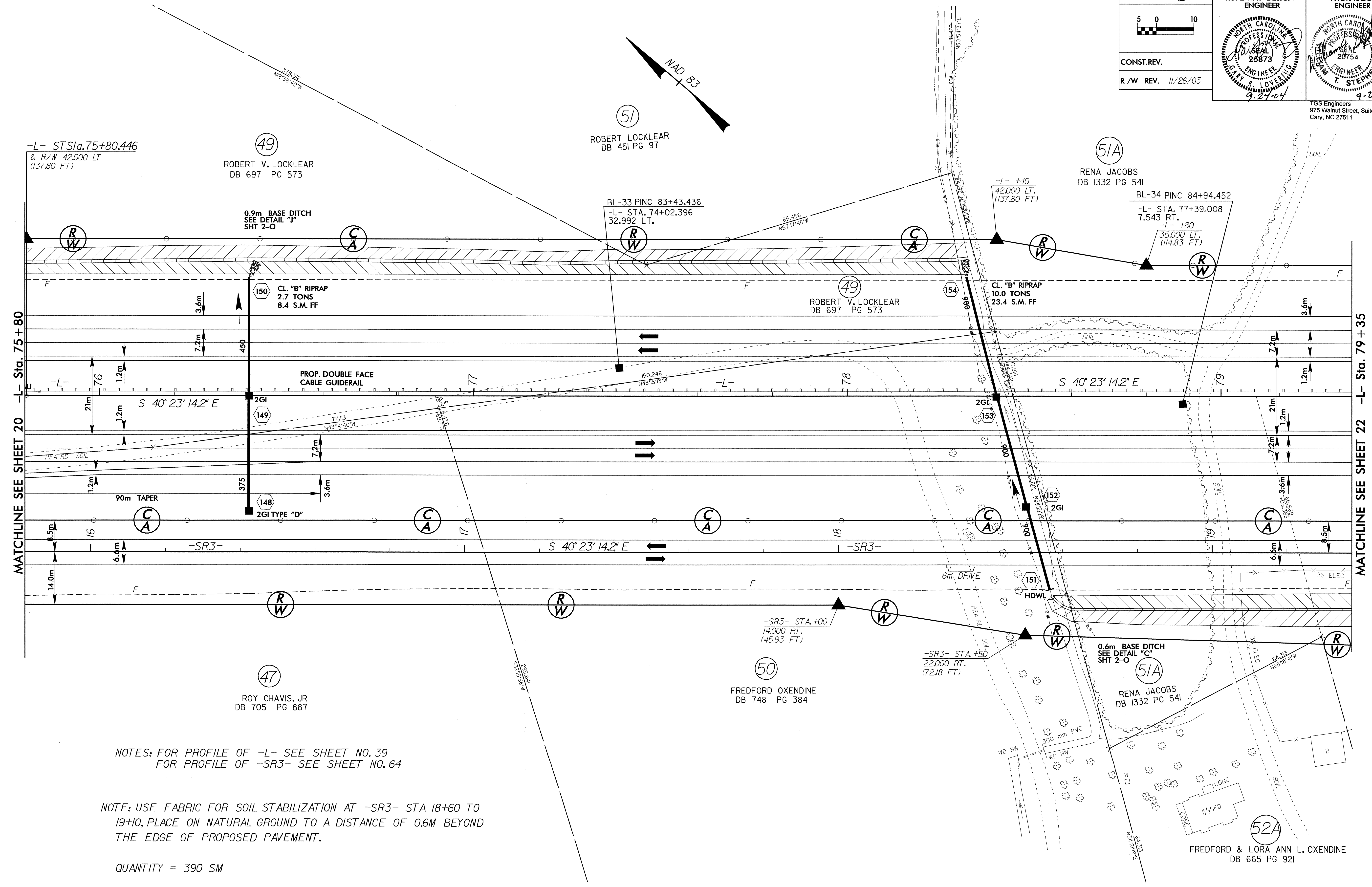

NOTES: FOR PROFILE OF -L- SEE SHEET NO. 39  
FOR PROFILE OF -SR3- SEE SHEET NO. 64

NOTE: USE FABRIC FOR SOIL STABILIZATION AT -SR3- STA 18+60 TO 19+10, PLACE ON NATURAL GROUND TO A DISTANCE OF 0.6M BEYOND THE EDGE OF PROPOSED PAVEMENT.

QUANTITY = 390 SM