

6/29/95

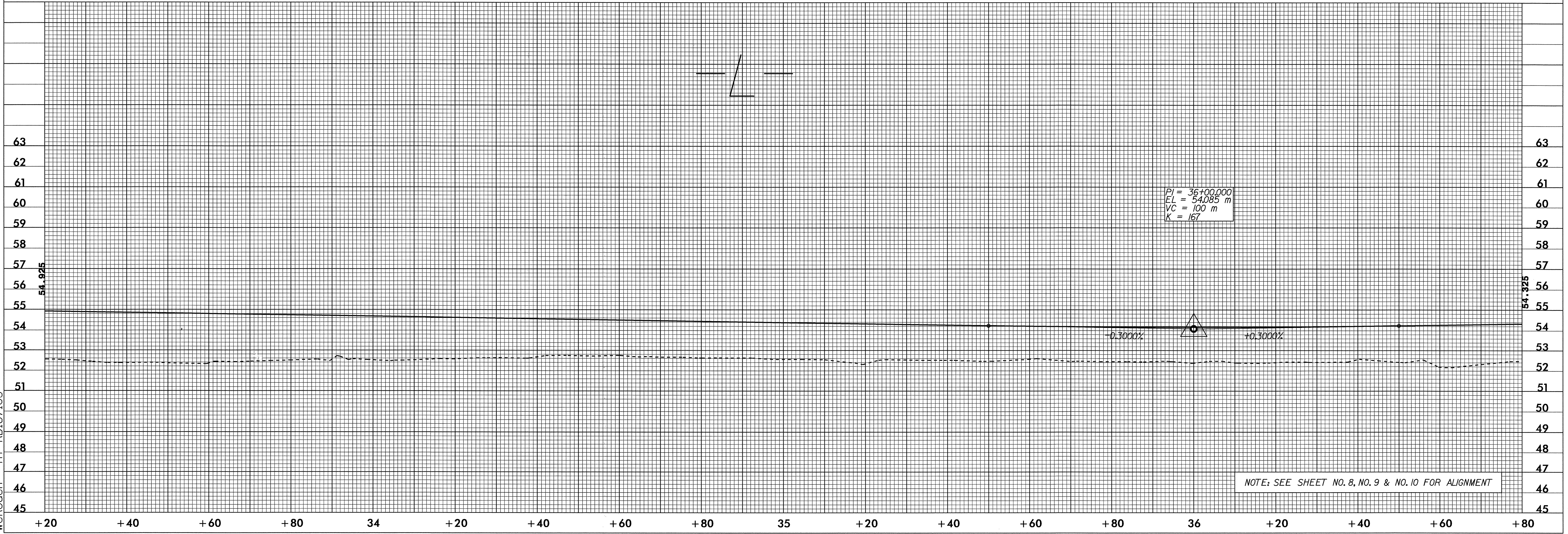

PROJECT REFERENCE NO. R-053A	SHEET NO. 33
ROADWAY DESIGN ENGINEER	HYDRAULICS ENGINEER
CONST. REV.	TGS ENGINEERS 975 Walnut Street, Suite 141 Cary, NC 27511
R / W REV.	9.24.04

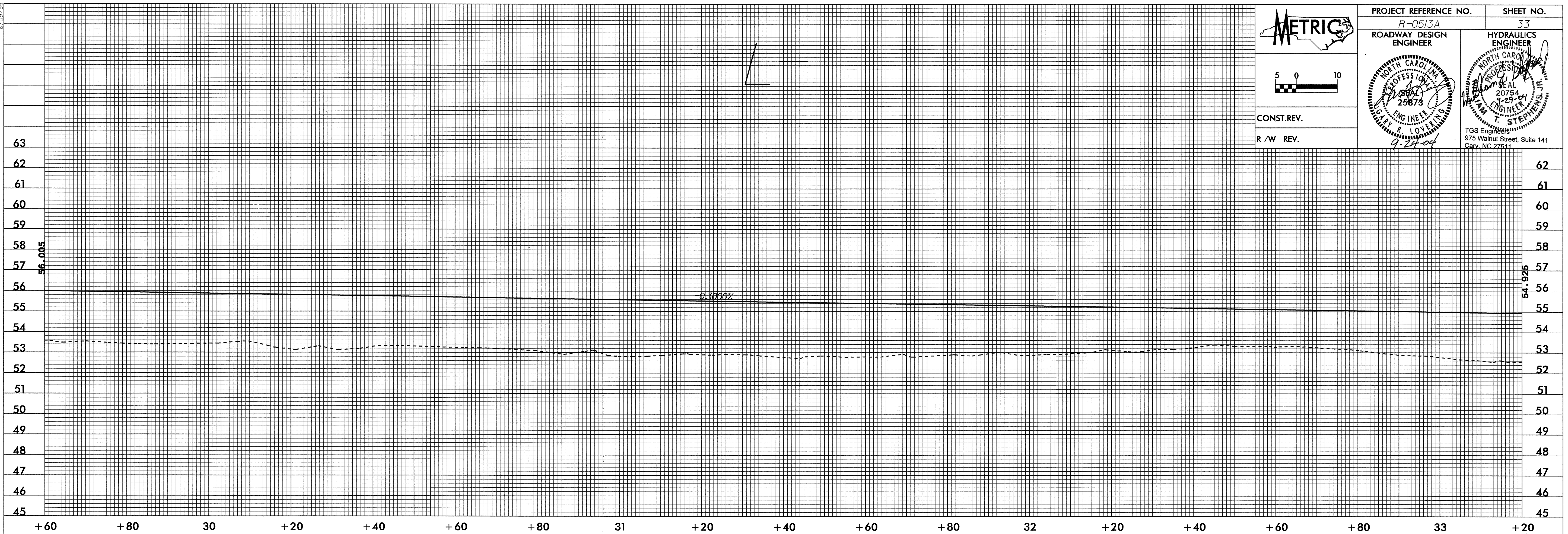
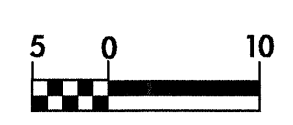

$PI = 36+100.000$
 $EL = 54.085 \text{ m}$
 $VC = 100 \text{ m}$
 $K = 167$

NOTE: SEE SHEET NO. 8, NO. 9 & NO. 10 FOR ALIGNMENT

08-JUL-2004 14:56
 R:\Projects\1-05\34401
 MCRoach AI RD187165