

6.09.99

RIGHT & LEFT DITCH

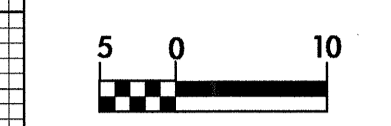

CONST. REV.
R / W REV.

PROJECT REFERENCE NO. R-0513A	SHEET NO. 41
ROADWAY DESIGN ENGINEER	HYDRAULICS ENGINEER
TGS Engineering 975 Walnut Street, Suite 141 Cary, NC 27511	

PIPE HYDRAULIC DATA
DRAINAGE STRUCTURE NO.162

DRAINAGE AREA	= 3.2	HA
DESIGN FREQUENCY	= 50	YRS
DESIGN DISCHARGE	= 0.39	CMS
DESIGN HW ELEVATION	= 5476	M
100 YEAR DISCHARGE	= 0.46	CMS
100 YEAR HW ELEVATION	= 5488	M
OVERTOPPING FREQUENCY	= 500+	YRS
OVERTOPPING DISCHARGE	= 1.25	CMS
OVERTOPPING ELEVATION	= 56.2	M

PIPE HYDRAULIC DATA
DRAINAGE STRUCTURE NO.163

DRAINAGE AREA	= 18	HA
DESIGN FREQUENCY	= 50	YRS
DESIGN DISCHARGE	= 0.70	CMS
DESIGN HW ELEVATION	= 5462	M
100 YEAR DISCHARGE	= 0.85	CMS
100 YEAR HW ELEVATION	= 5476	M
OVERTOPPING FREQUENCY	= 500+	YRS
OVERTOPPING DISCHARGE	= 3.80	CMS
OVERTOPPING ELEVATION	= 55.6	M

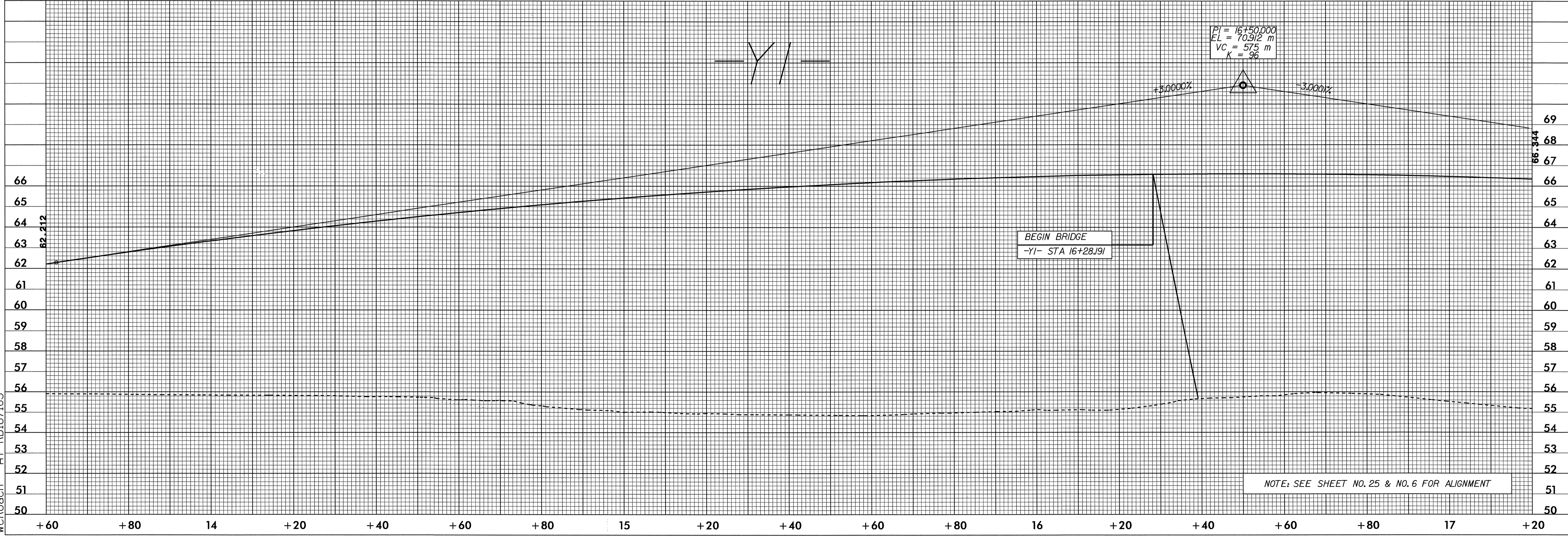
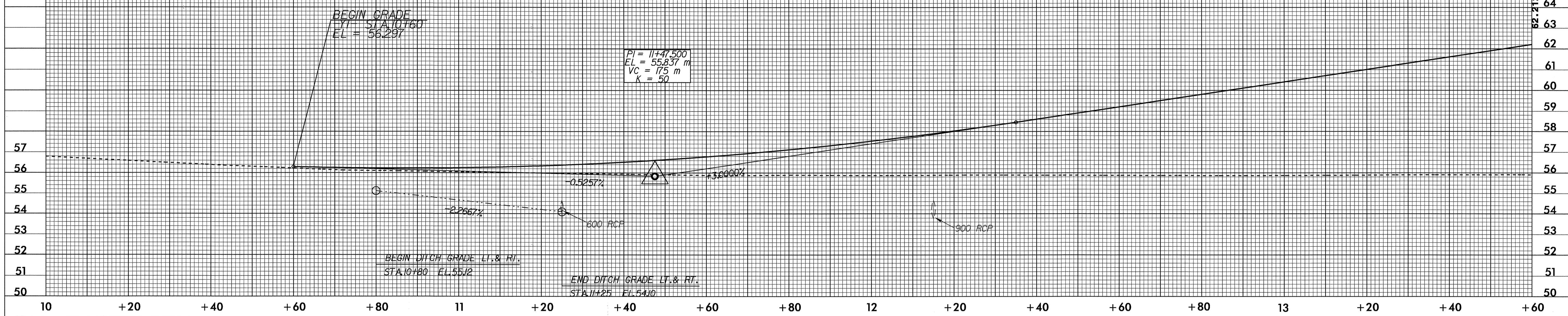

NOTE: SEE SHEET NO. 25 & NO. 6 FOR ALIGNMENT

08-JUL-2004 14:52
R:\Proj\0513a\61
MCRoach AT RD187165