

5/09/06

DITCH LEGEND
RIGHT DITCH

METRIC

CONST. REV.
R / W REV.

PROJECT REFERENCE NO. R-0513A
SHEET NO. 49

ROADWAY DESIGN ENGINEER
HYDRAULICS ENGINEER

Professional Engineer Seal: T. STEPHENSON, No. 25873, State of North Carolina, expires 9-29-04.

TGS Engineering
975 Walnut Street, Suite 141
Cary, NC 27511

-LPDYI-

PIPE HYDRAULIC DATA
DRAINAGE STRUCTURE NO. 23

DRAINAGE AREA	= 5	HA
DESIGN FREQUENCY	= 50	YRS
DESIGN DISCHARGE	= 0.57	CMS
DESIGN HW ELEVATION	= 53.93	M
100 YEAR DISCHARGE	= 0.66	CMS
100 YEAR HW ELEVATION	= 54.1	M
OVERTOPPING FREQUENCY	= 500+	YRS
OVERTOPPING DISCHARGE	= 1.33	CMS
OVERTOPPING ELEVATION	= 56.05	M

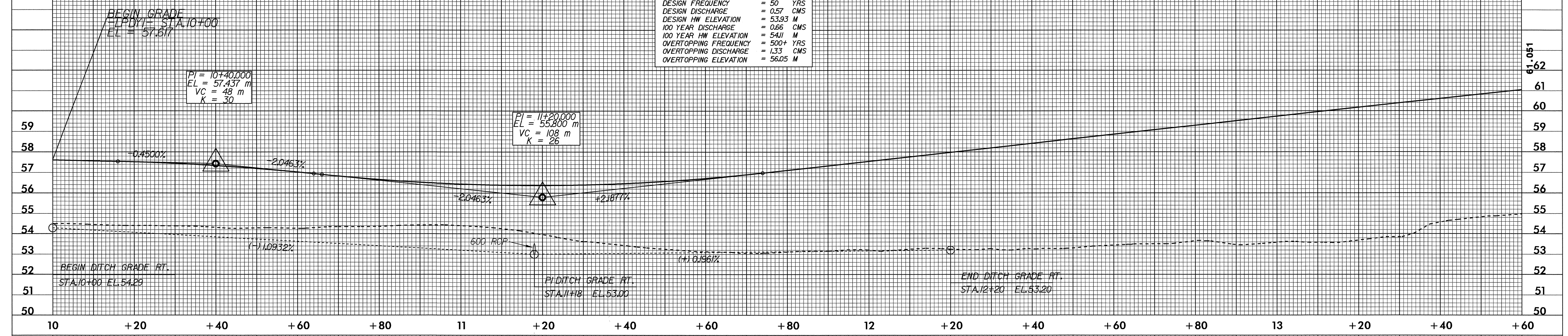

-LPDYI-

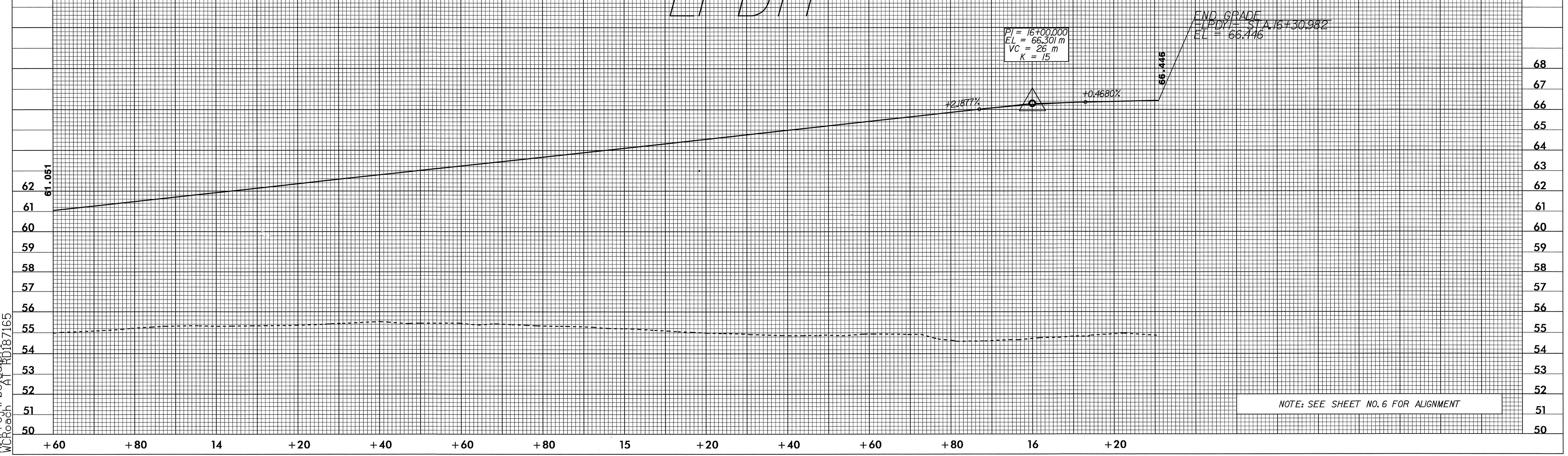

NOTE: SEE SHEET NO. 6 FOR ALIGNMENT

08-JUL-2004 14:50
M:\Projects\0513\RD1\11
McRoach AI RD187165