

6/09/08

**METRIC**

PROJECT REFERENCE NO. R-0513A SHEET NO. 56

ROADWAY DESIGN ENGINEER

HYDRAULICS ENGINEER

CONST. REV.

R / W REV.

9-21-04

TGS Engineers  
875 Walnut Street, Suite 141  
Cary, NC 27511

-Y3-

**PIPE HYDRAULIC DATA**  
DRAINAGE STRUCTURE NO.37

DRAINAGE AREA	= 0.70 HA
DESIGN FREQUENCY	= 50 YRS
DESIGN DISCHARGE	= 0.22 CMS
DESIGN HW ELEVATION	= 53.91 M
100 YEAR DISCHARGE	= 0.235 CMS
100 YEAR HW ELEVATION	= 54.00 M
OVERTOPPING FREQUENCY	= 500+ YRS
OVERTOPPING DISCHARGE	= 0.50 CMS
OVERTOPPING ELEVATION	= 54.8 M

STATION AT C = Y3+97.75+/-  
 INVERT EL AT C = Y3+53.27+/-  
 PIPE SIZE = 450mm  
 (SEE SHEET 6)

PI = 10+40.000  
 EL = 54.896 m  
 VC = 50 m  
 K = 16

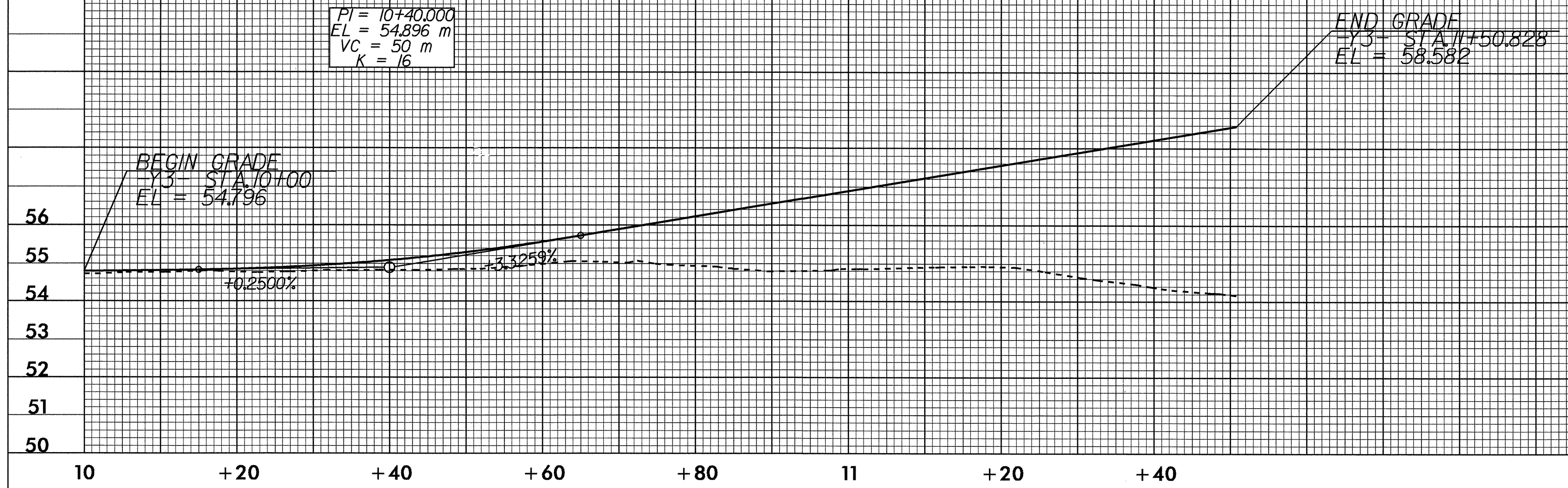

NOTE: SEE SHEET NO. 6 & NO. 7 FOR ALIGNMENT

-Y4-

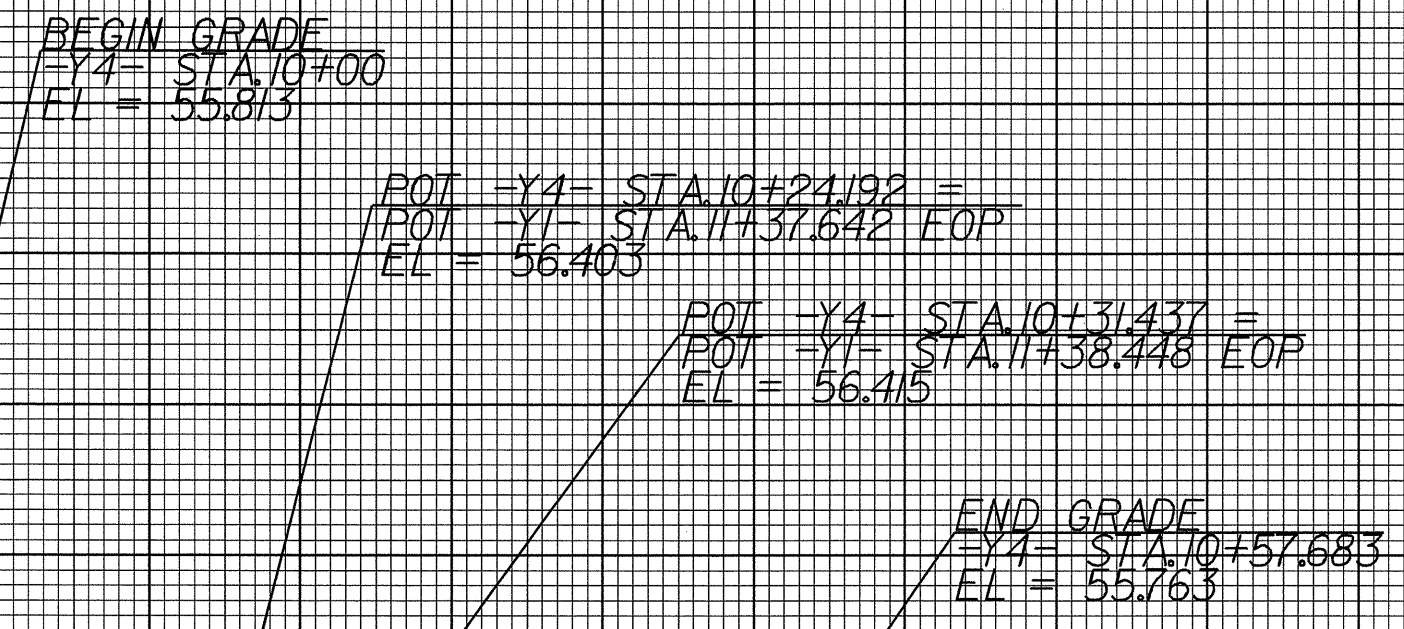

PI = 10+10.000  
 EL = 55.950 m  
 VC = 20 m  
 K = 11

PI = 10+50.000  
 EL = 55.937 m  
 VC = 15 m  
 K = 48

NOTE: SEE SHEET NO. 25 FOR ALIGNMENT

08-JUL-2004 14:01  
 R:\proj\11-0513a\p1  
 MCRoch AT RD187165