

09/08/99

See Sheet 1-A For Index of Sheets
 See Sheet 1-B For Conventional Symbols
 See Sheet 1-C & 1-D For Survey Control Plans

STATE OF NORTH CAROLINA
 DIVISION OF HIGHWAYS

RANDOLPH COUNTY

**LOCATION: BRIDGE NO. 226 OVER RICHLAND CREEK
 ON SR 2832**

TYPE OF WORK: GRADING, DRAINAGE, PAVING AND STRUCTURE

STATE	STATE PROJECT REFERENCE NO.	SHEET NO.	TOTAL SHEETS
N.C.	B-3506	1	
STATE PROJ. NO.	F.A. PROJ. NO.	DESCRIPTION	
33120.1.1	BRZ-2832(2)	PE	
33120.2.2	BRZ-2832(2)	RW, UTIL.	
33120.3.1	BRZ-2832(5)	CONST.	

TIP PROJECT: B-3506

CONTRACT: C201318

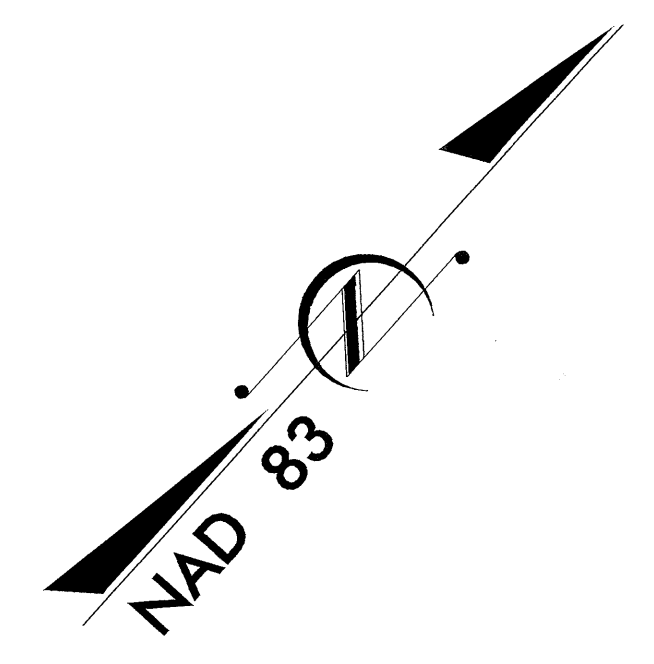
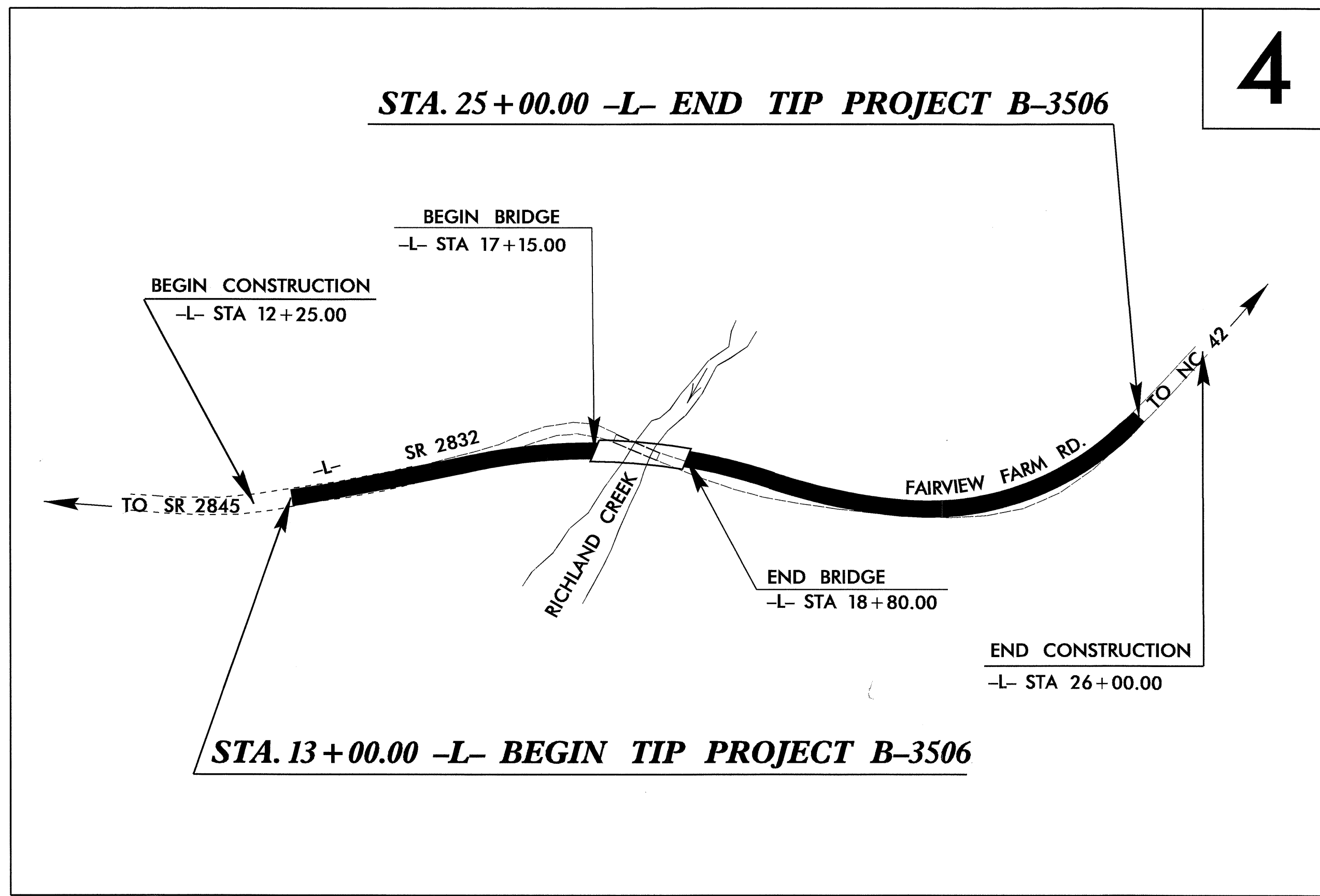
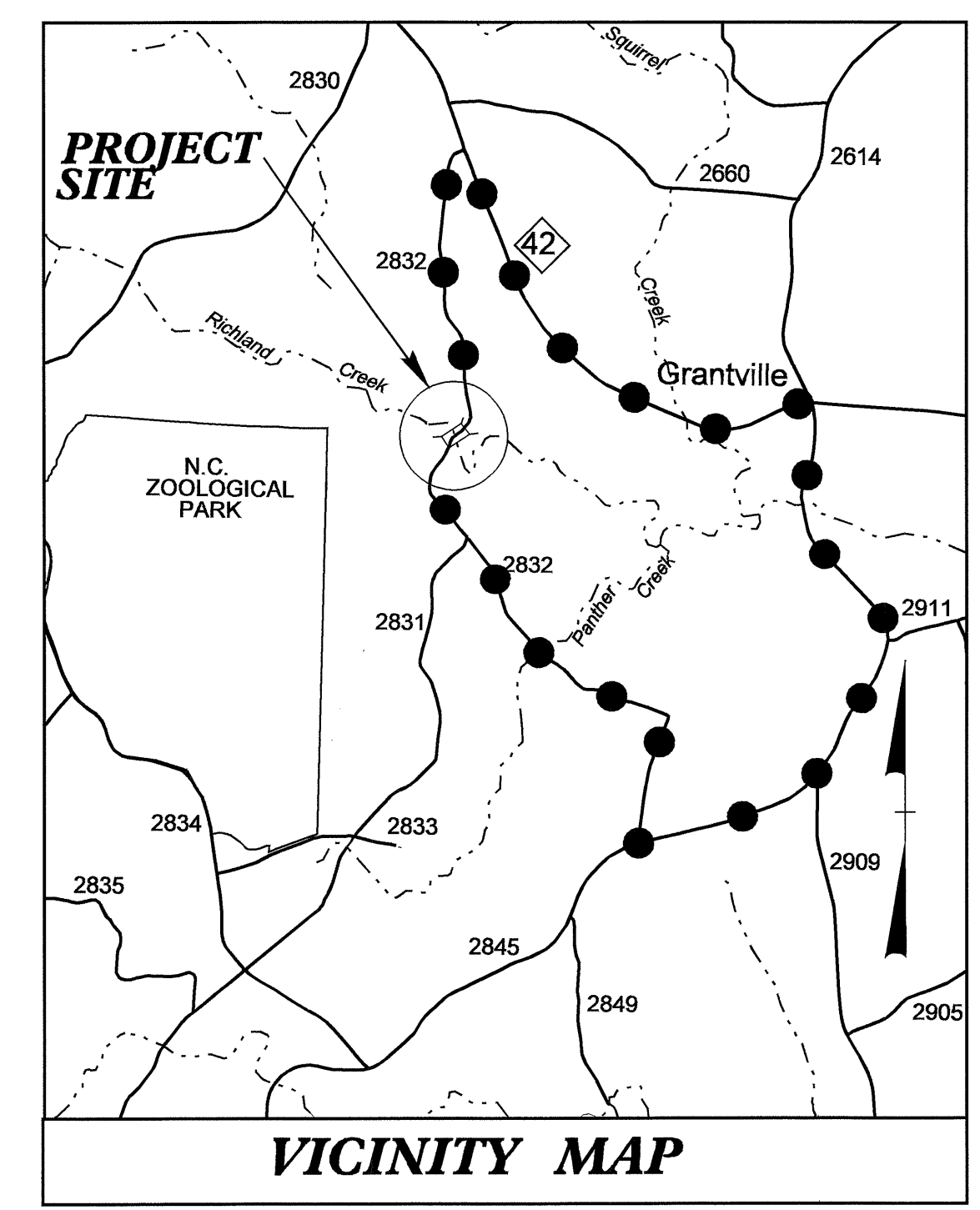

** DESIGN EXCEPTION REQUIRED FOR DESIGN SPEED

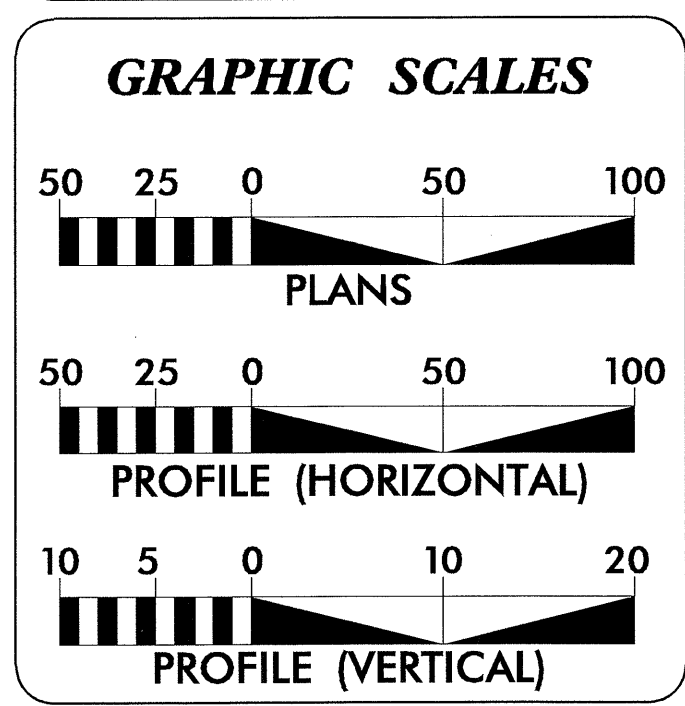

DESIGN DATA

ADT 2004 = 244
 ADT 2024 = 393
 DHV = 10 %
 D = 60 %
 * T = 3 %
 ** V = 25 MPH
 * TTST 1 % + DUAL 2 %
 POSTED = 55 MPH (STAT.)

PROJECT LENGTH

LENGTH ROADWAY TIP PROJECT B-3506 = 0.196 MI
 LENGTH STRUCTURE TIP PROJECT B-3506 = 0.031 MI
 TOTAL LENGTH OF TIP PROJECT B-3506 = 0.227 MI

Prepared in the Office of:
DIVISION OF HIGHWAYS
 1000 Birch Ridge Dr., Raleigh NC, 27610

2002 STANDARD SPECIFICATIONS

RIGHT OF WAY DATE:
 SEPTEMBER 19, 2003

LETTING DATE:
 NOVEMBER 16, 2004

BRENDA MOORE, PE
 PROJECT ENGINEER

REKHA PATEL, PE
 PROJECT DESIGN ENGINEER

HYDRAULICS ENGINEER

PROFESSIONAL ENGINEER
 SEAL 20329
 10/29/04

ROADWAY DESIGN ENGINEER

PROFESSIONAL ENGINEER
 SEAL 19795
 6/29/04

SIGNATURE: *B.R. Moore*

DIVISION OF HIGHWAYS
 STATE OF NORTH CAROLINA

ant miller P.E.
 STATE DESIGN ENGINEER

DEPARTMENT OF TRANSPORTATION
 FEDERAL HIGHWAY ADMINISTRATION

APPROVED
 DIVISION ADMINISTRATOR

15-JUN-2004 13:54
 R:\Roadway\Proj\B3506.tsh
 RPatel AT