

DATUM DESCRIPTION

THE LOCALIZED COORDINATE SYSTEM DEVELOPED FOR THIS PROJECT IS BASED ON THE STATE PLANE COORDINATES ESTABLISHED BY NODS FOR MONUMENT "HINSHAW"

WITH HAD 83 STATE PLANE GRID COORDINATES OF NORTHING: 696486.891 (N71) EASTING: 17001345.498 (E71)

THE AVERAGE COMBINED GRID FACTOR USED ON THIS PROJECT (GROUND TO GRID) IS: 0.9998726

THE N.C. LAMBERT GRID BEARING AND LOCALIZED HORIZONTAL GROUND DISTANCE FROM "HINSHAW" TO STATION 13+00 IS N 1° 58' 55.93" E 7029.8465 FT.

ALL LINEAR DIMENSIONS ARE LOCALIZED HORIZONTAL DISTANCES VERTICAL DATUM USED IS MVD 29

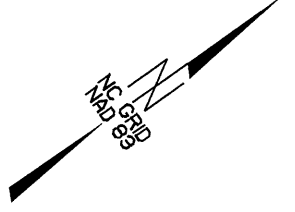

STA. 13+00 -L- BEGIN STATE PROJECT B-3506

STA. 25+00 -L- END STATE PROJECT B-3506

REVISIONS

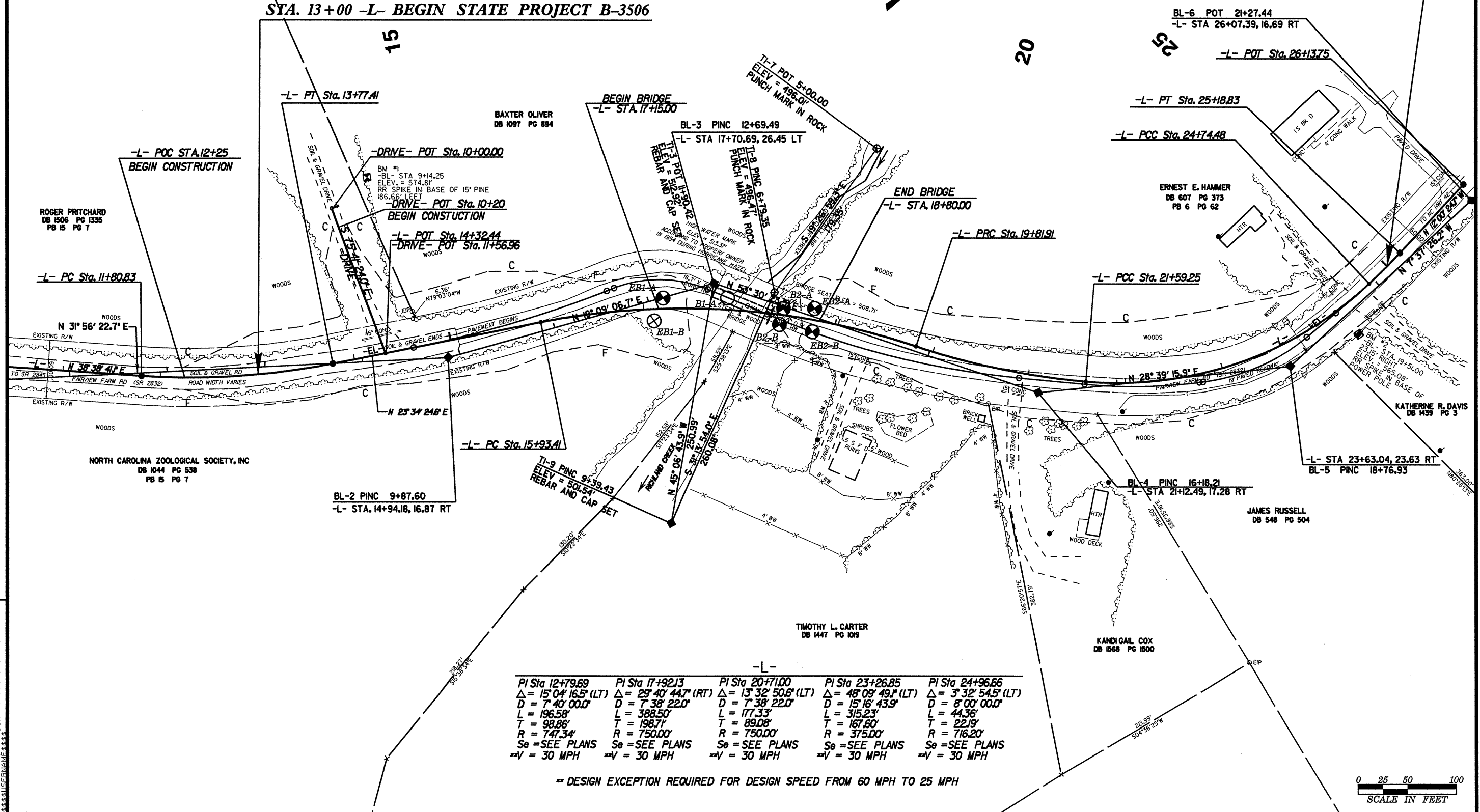

PI Sta	PI Sta	PI Sta	PI Sta	PI Sta
12+79.69	17+92.13	20+71.00	23+26.85	24+96.66
$\Delta = 15^{\circ} 04' 16.5" (LT)$	$\Delta = 29^{\circ} 40' 44.7" (RT)$	$\Delta = 13^{\circ} 32' 50.6" (LT)$	$\Delta = 48^{\circ} 09' 49.1" (LT)$	$\Delta = 3^{\circ} 32' 54.5" (LT)$
$D = 7^{\circ} 40' 00.0"$	$D = 7^{\circ} 38' 22.0"$	$D = 7^{\circ} 38' 22.0"$	$D = 15^{\circ} 16' 43.9"$	$D = 8^{\circ} 00' 00.0"$
$L = 196.58'$	$L = 388.50'$	$L = 177.33'$	$L = 315.23'$	$L = 44.36'$
$T = 98.86'$	$T = 198.71'$	$T = 89.08'$	$T = 167.60'$	$T = 22.19'$
$R = 747.34'$	$R = 750.00'$	$R = 750.00'$	$R = 375.00'$	$R = 716.20'$
$S_e = \text{SEE PLANS}$	$S_e = \text{SEE PLANS}$	$S_e = \text{SEE PLANS}$	$S_e = \text{SEE PLANS}$	$S_e = \text{SEE PLANS}$
$\Delta V = 30 \text{ MPH}$	$\Delta V = 30 \text{ MPH}$	$\Delta V = 30 \text{ MPH}$	$\Delta V = 30 \text{ MPH}$	$\Delta V = 30 \text{ MPH}$

== DESIGN EXCEPTION REQUIRED FOR DESIGN SPEED FROM 60 MPH TO 25 MPH

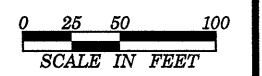

8/17/95
 01
 02
 03
 04
 05
 06
 07
 08
 09
 10
 11
 12
 13
 14
 15
 16
 17
 18
 19
 20
 21
 22
 23
 24
 25
 26
 27
 28
 29
 30
 31
 32
 33
 34
 35
 36
 37
 38
 39
 40
 41
 42
 43
 44
 45
 46
 47
 48
 49
 50
 51
 52
 53
 54
 55
 56
 57
 58
 59
 60
 61
 62
 63
 64
 65
 66
 67
 68
 69
 70
 71
 72
 73
 74
 75
 76
 77
 78
 79
 80
 81
 82
 83
 84
 85
 86
 87
 88
 89
 90
 91
 92
 93
 94
 95
 96
 97
 98
 99
 00