

Profile Left of -L-

BM #1 - BL - STA 9+14.25  
 186.66' LEFT ELEV = 574.81'  
 RR SPIKE IN BASE OF 15" PINE

BM #2 - BL - STA 19+51.00  
 23.15' RIGHT ELEV = 565.08'  
 RR SPIKE IN BASE OF POWER POLE

\*\*DESIGN EXCEPTION REQUIRED FOR  
 DESIGN SPEED FROM 60 MPH TO 25 MPH

BEGIN GRADE - L - STA. 13+00  
 EL. 559.49'

END GRADE - L - STA. 25+00  
 EL. 567.02'

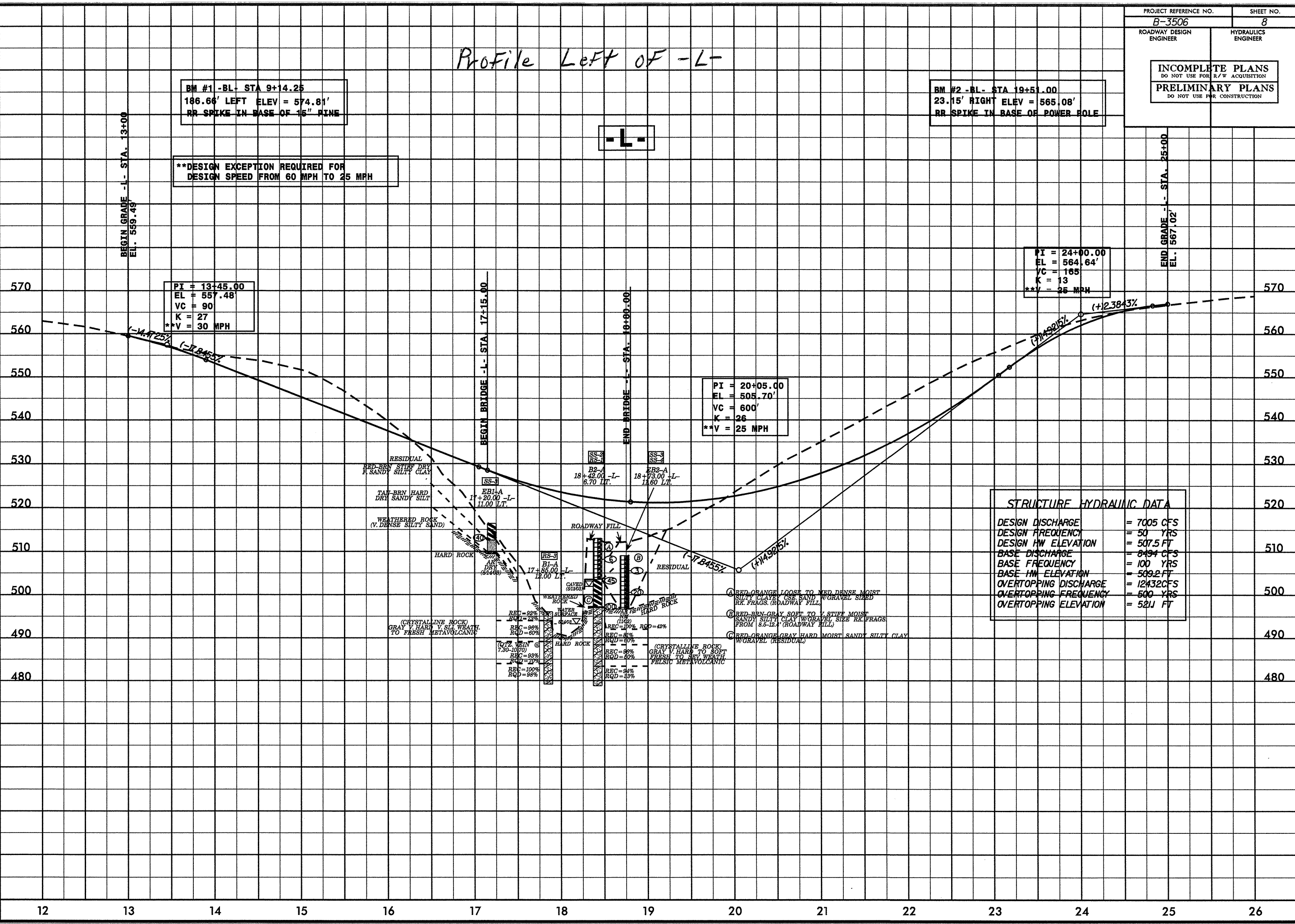

5/14/99  
 TIME: 10:00 AM  
 DATE: 5/14/99  
 DRAWN BY: J. J. J.  
 CHECKED BY: J. J. J.  
 APPROVED BY: J. J. J.