

TIP: R-2206B

CONTRACT: C200910

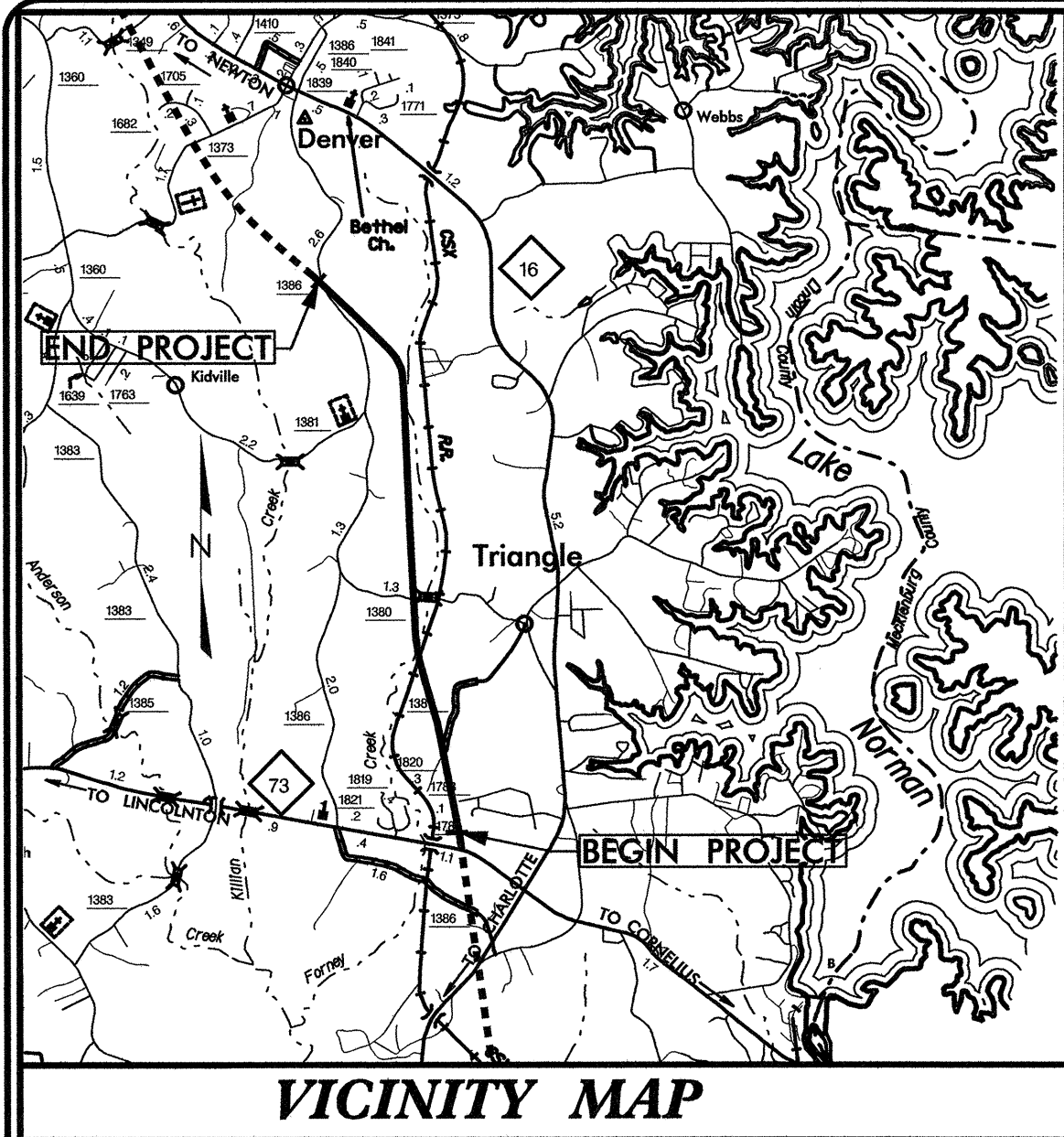

VICINITY MAP

See Sheet 1-A For Index of Sheets  
See Sheet 1-B For Conventional Symbols

STATE OF NORTH CAROLINA  
DIVISION OF HIGHWAYS

LINCOLN COUNTY

LOCATION: NC 16 BYPASS FROM NORTH OF NC 73 TO NORTH OF SR 1386 (ST. JAMES CHURCH ROAD)

TYPE OF WORK: GRADING, DRAINAGE, STRUCTURES, PAVING, Y' LINE PAVING, AND CULVERTS.



ALL DIMENSIONS IN THESE PLANS ARE IN METERS AND/OR MILLIMETERS UNLESS OTHERWISE SHOWN

STATE	STATE PROJECT REFERENCE NO.	SHEET NO.	TOTAL SHEETS
N.C.	R-2206B	1	
WBS NO.	F.A. PROJ. NO.	DESCRIPTION	
34383.1.1	STP-F-24-1(34)	P.E.	
34383.2.3	STP-16 (16)	R.O.W., UTIL.	
34383.3.4	STP-16 (30)	CONSTRUCTION	

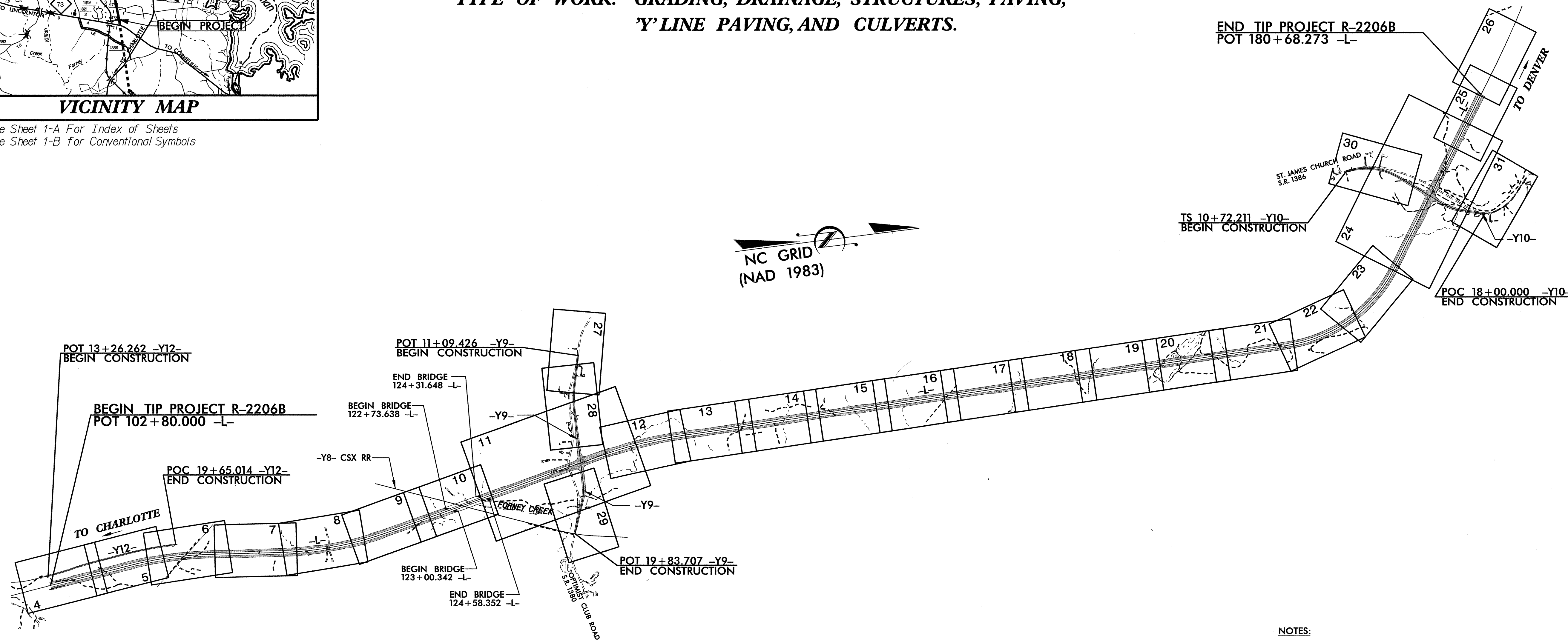

NOTES:  
1. THIS IS A CONTROLLED-ACCESS PROJECT WITH ACCESS BEING LIMITED TO INTERSECTIONS AS SHOWN ON THE PLANS.

NCDOT CONTACT: MS. TERESA M. BRUTON, P.E., PROJECT ENGINEER - PROJECT SERVICES

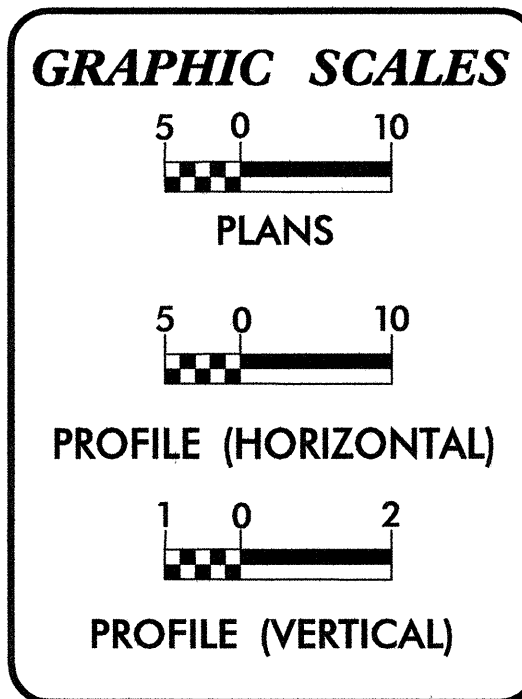

**DESIGN DATA**

ADT 2003	=	12,050
ADT 2023	=	20,400
DHV	=	10 %
D	=	62 %
T	=	12 % *
V	=	100 km/h
* (TTST 7% + DUAL 5%)		
FUNCTIONAL CLASS.	=	FREEWAY

**PROJECT LENGTH**

LENGTH OF ROADWAY TIP PROJECT R-2206B	=	7.630 Km
LENGTH OF STRUCTURE TIP PROJECT R-2206B	=	0.158 Km
TOTAL LENGTH OF TIP PROJECT R-2206B	=	7.788 Km

Prepared in the Office of:  
**WILBUR SMITH ASSOCIATES**  
P.O. BOX 2478 RALEIGH, NC 27602-2478

**NORTH CAROLINA DEPARTMENT OF TRANSPORTATION**  
2002 STANDARD SPECIFICATIONS

**RIGHT OF WAY DATE:** OCTOBER 29, 1999

**LETTING DATE:** NOVEMBER 16, 2004

**DAVID L. WILVER, P.E.**  
PROJECT ENGINEER

**MERRICK A. DUGAL, III, P.E.**  
PROJECT DESIGN ENGINEER

**HYDRAULICS ENGINEER**

**ROADWAY DESIGN**

**DIVISION OF HIGHWAYS**  
STATE OF NORTH CAROLINA

*Out Millan* P.E.

STATE DESIGN ENGINEER

**DEPARTMENT OF TRANSPORTATION**  
FEDERAL HIGHWAY ADMINISTRATION

APPROVED DIVISION ADMINISTRATOR

DATE

DATE: 02/28/04  
TIME: 10:39:23 AM  
FILE: \\p1\mca\1-2206b\sheet01.dwg