

INSET "A"

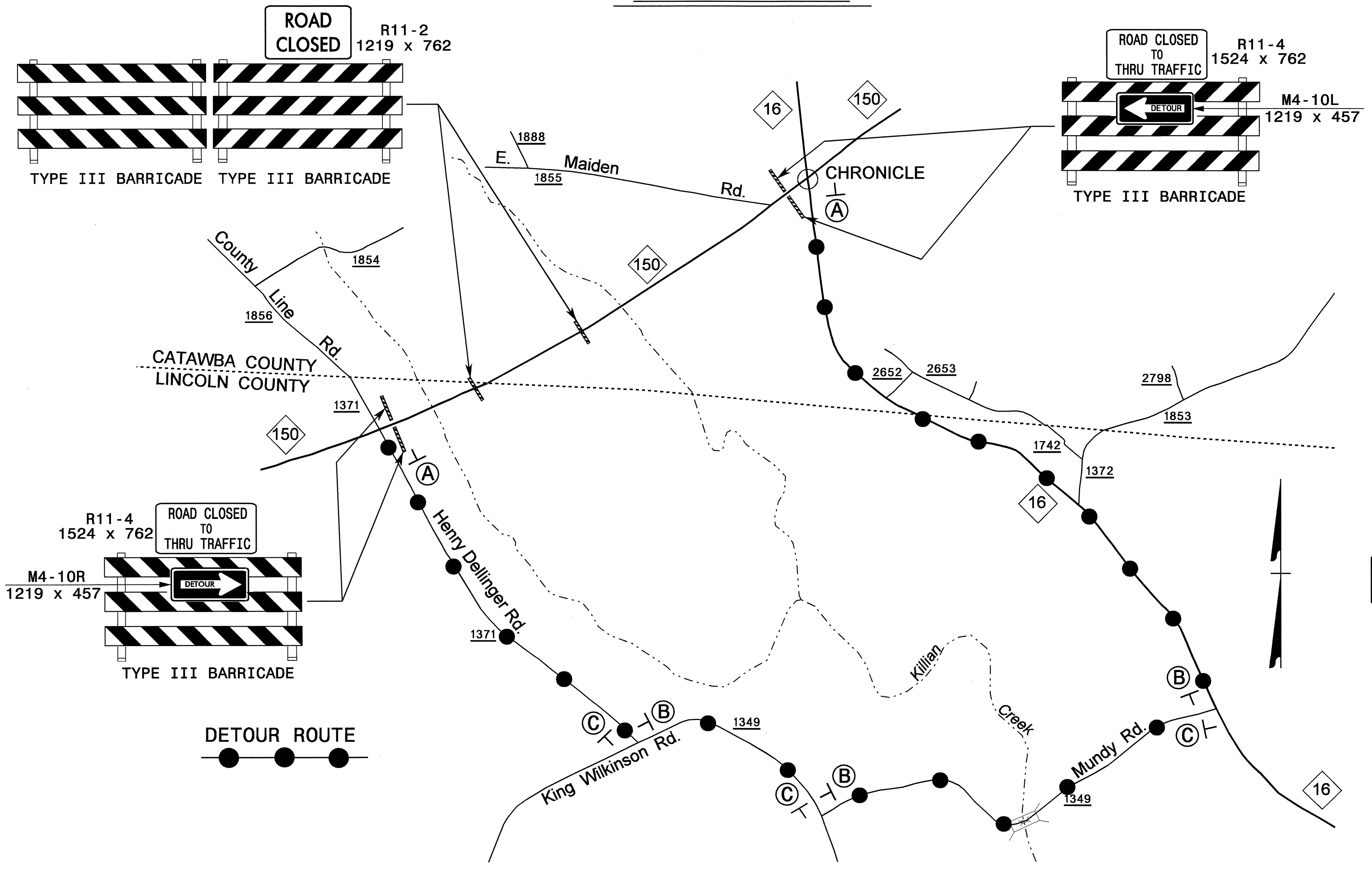
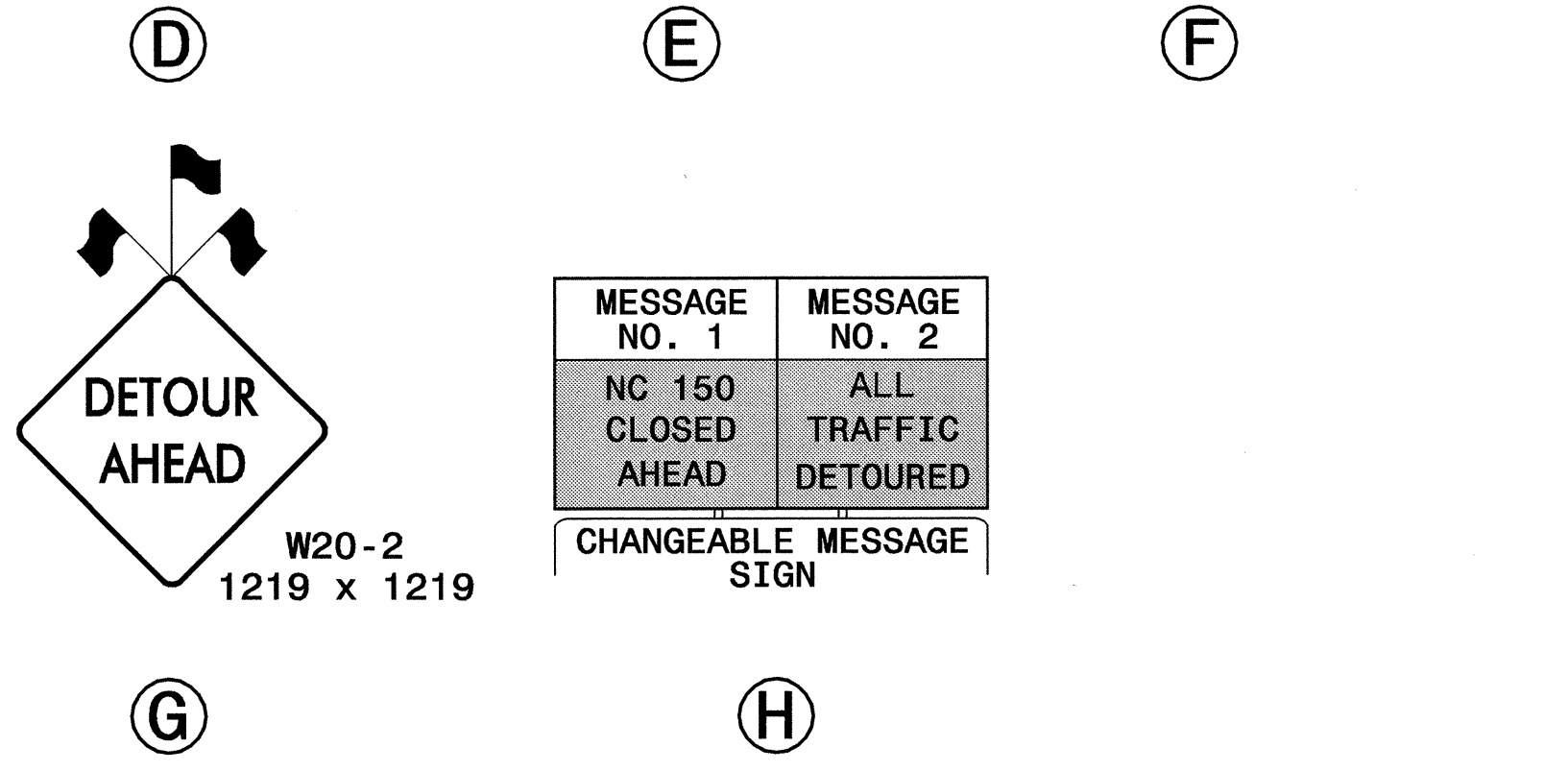
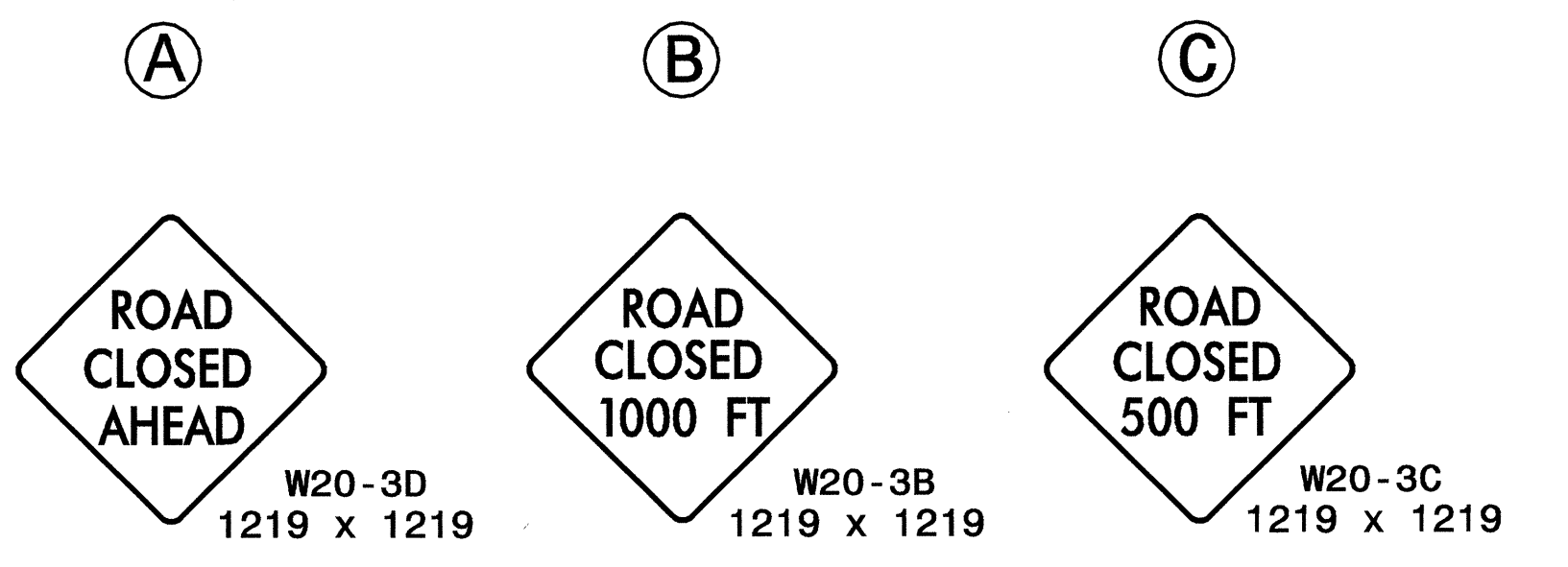
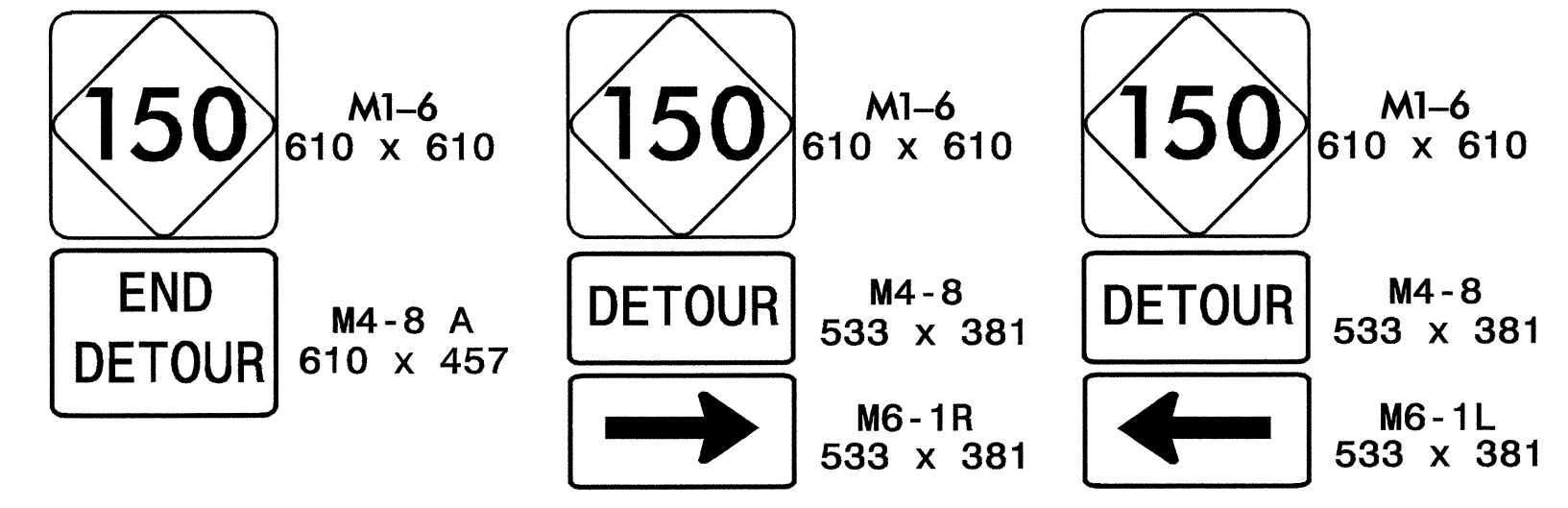

USE OFFSITE DETOUR SIGNING AS SHOWN AND RSD 1101.03 (SHEET 1 OF 9) WHEN INSTALLING OVERHEAD BRIDGE GIRDERS OVER NC 150.

09-JUL-2004 14:30
 J:\TCPA\AREA3\RFZ\OSCC.TC\AREA3_tcp16.dgn
 SCOOTIS AT TELC206428

APPROVED:	DATE: 7/12/04	AREA 3-PHASE III OFFSITE DETOUR SIGNING											
	SCALE: NONE												
	DATE: 05-10-04	<table border="1"> <tr> <th colspan="2">REVISIONS</th> </tr> <tr> <td> </td> <td> </td> </tr> <tr> <td> </td> <td> </td> </tr> <tr> <td> </td> <td> </td> </tr> </table>				REVISIONS							
	REVISIONS												
DWG. BY: SBC	DESIGN BY: SBC	REVIEWED BY: CLM											